

# [Cloudy Bay Lighting Supply Instruction Manual](#)

## [Manualsum](#), simplified manuals

### Table of Contents

- [Cloudy Bay Lighting Supply Instruction Manual](#)
  - [PRODUCT CARE](#)
    - [After Sales Service](#)
  - [3-Year Limited Warranty](#)
  - [PACKAGE CONTENTS](#)
  - [INSTALLATION INSTRUCTIONS](#)
    - [INSTALLATION OVERVIEW](#)
  - [QUESTIONS? COMMENTS? SUGGESTIONS? COMPLAINTS?](#)

## **Cloudy Bay Lighting Supply Instruction Manual**

Cloudy Bay Lighting Supply Instruction Manual

Cloudy Bay Lighting Supply Inc 3 Inch RGB Smart Recessed Lighting with  
Gradient Accent Light and Night Light User Manual

FCC id: [2A4FVLJD005SMG2WH](#)



3 INCH SMART LED RECESSED DOWN LIGHT WITH BACK LIGHT

[Manualsum](#)



Turn power off before installation, inspection, or removal.

Use all necessary precautions while performing this procedure.

Consult a qualified electrician to ensure correct branch circuit conductor. Min 90°C supply conductors.

Properly ground electrical enclosure. IT IS IMPERATIVE THAT THE OUTLET BOX BE PROPERLY GROUNDED.

DO NOT REVERSE THE HOT AND NEUTRAL CONNECTIONS, OTHERWISE SAFETY WILL BE COMPROMISED.

Contact us through [smart@cloudybaylighting.com](mailto:smart@cloudybaylighting.com)



## PRODUCT CARE

### After Sales Service

1. Please discontinue to use product right away if product shows any visible defect and contact customer service.
2. If there is any problem with our lights for non-human reasons, please contact customer service, we will send you brand new replacement without need to returning goods or full refund.
3. If you are not completely satisfied with product after installation but prefer not to disassemble, contact with us right away, we will provide comparable compensations.

## 3-Year Limited Warranty

LIMITED WARRANTY: This fixture is warranted to be free from defects in workmanship and material for up to 3-years. Based upon reasonable household usage, when used in accordance with package and included instructions. If this fixture does not last for the time period guaranteed, manufacture will send you a replacement fixture upon receipt of the [Manualsum](#)

returned fixture, register receipt, and proof of purchase. To contact us, please email us at [smart@cloudybaylighting.com](mailto:smart@cloudybaylighting.com) to find out how to return the fixture. We are committed to making high quality products. Returning the fixture will help us monitor and further improve product quality. This replacement is the sole remedy available, and LIABILITY FOR INCIDENTAL OR CONSEQUENTIAL DAMAGES IS HEREBY EXPRESSLY EXCLUDED.

## PACKAGE CONTENTS

**A**

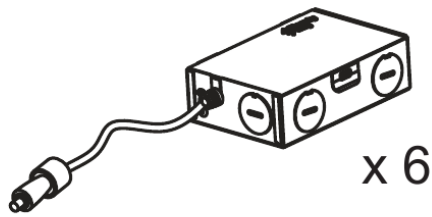

x 6

Junction box

**B**

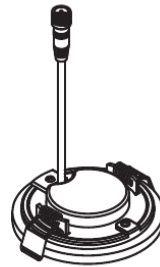

x 6

Light Kit

**C**

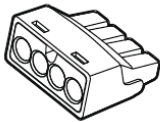

x 18

Quick connectors

**D**

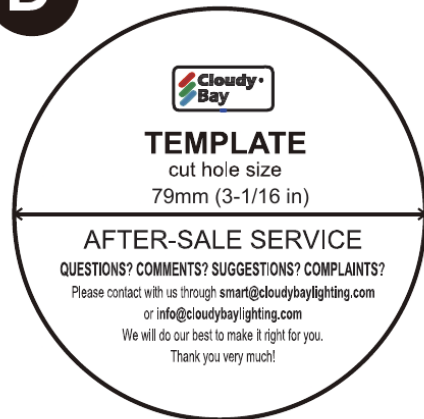

**E**

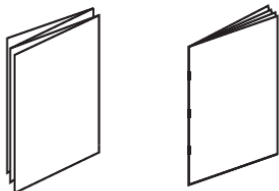

User manual  
Voice control guide

# INSTALLATION INSTRUCTIONS

## INSTALLATION OVERVIEW

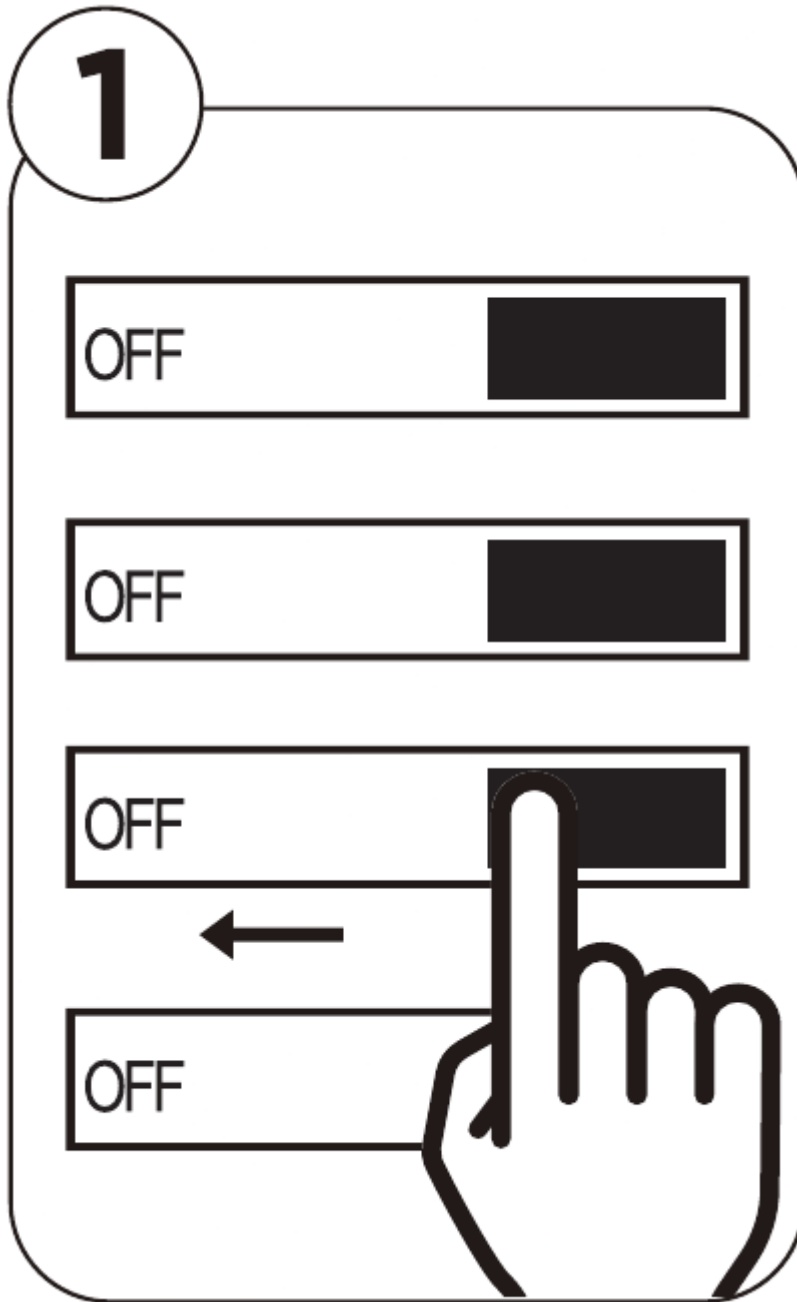

Turn off power at the source.

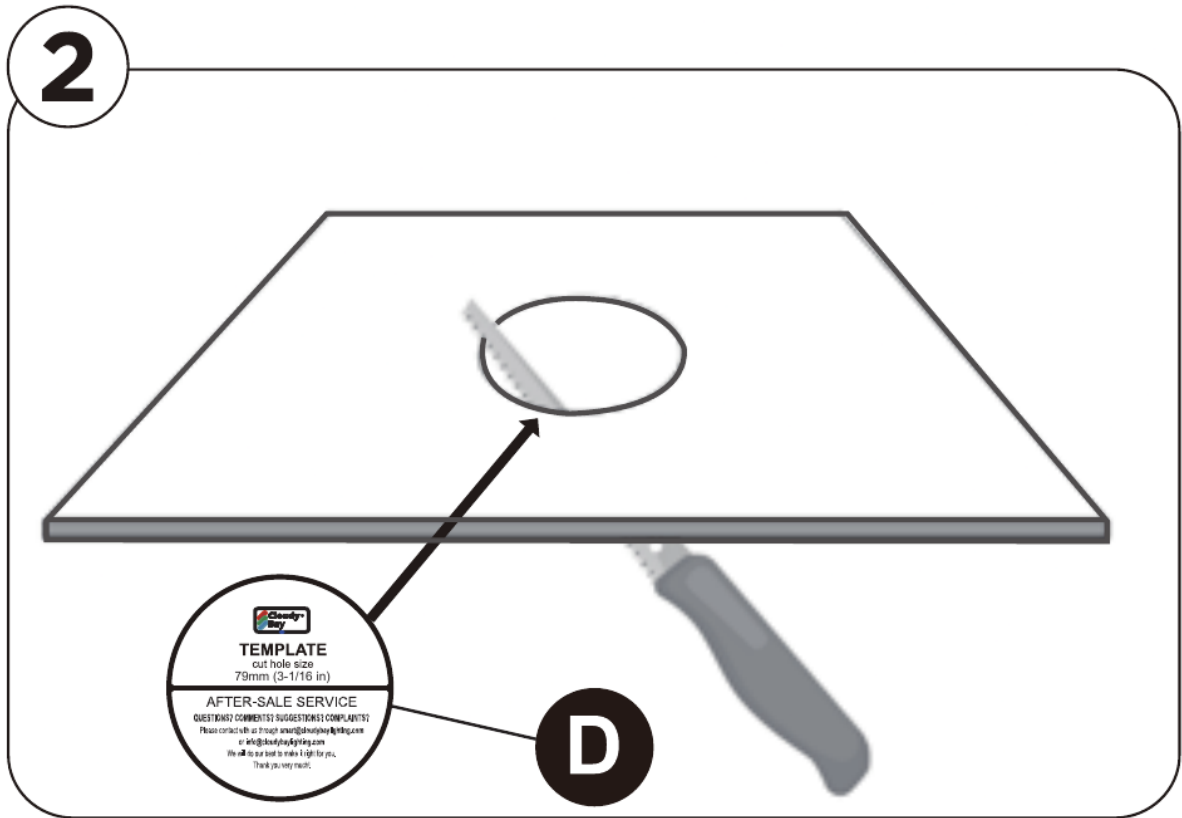

Make a hole in the ceiling with template in package

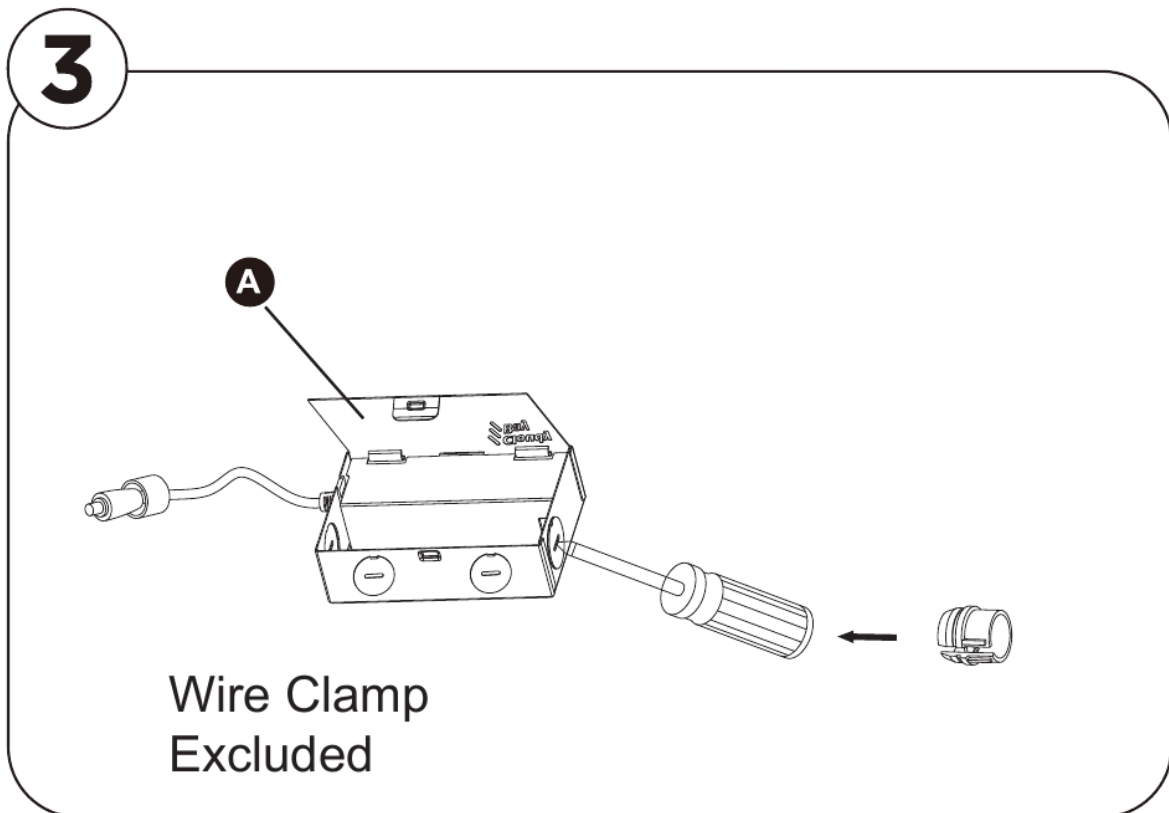

Carefully remove the knock-out with a screw driver or punch.

4

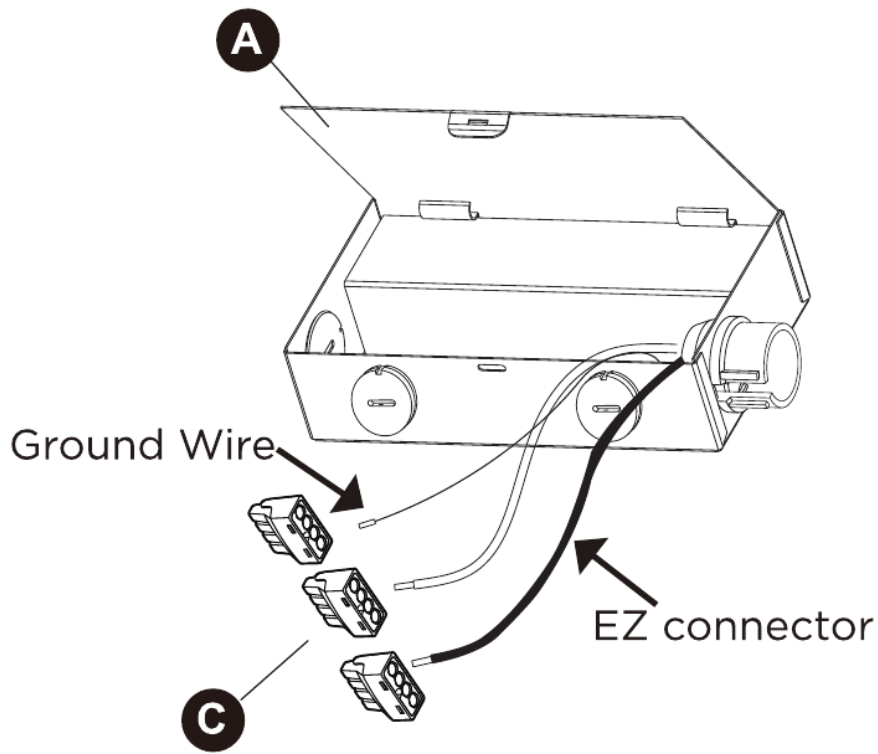

Open the connectors box cover. Feed supply wire into knockout hole using connector and make all connections inside the junction box using the EZ connectors (see picture below). Connect the 120V line wire to the black wire. Connect the neutral wire to the white wire. Connect bare copper wire to grounding terminal of the outlet box. Put on junction box cover.

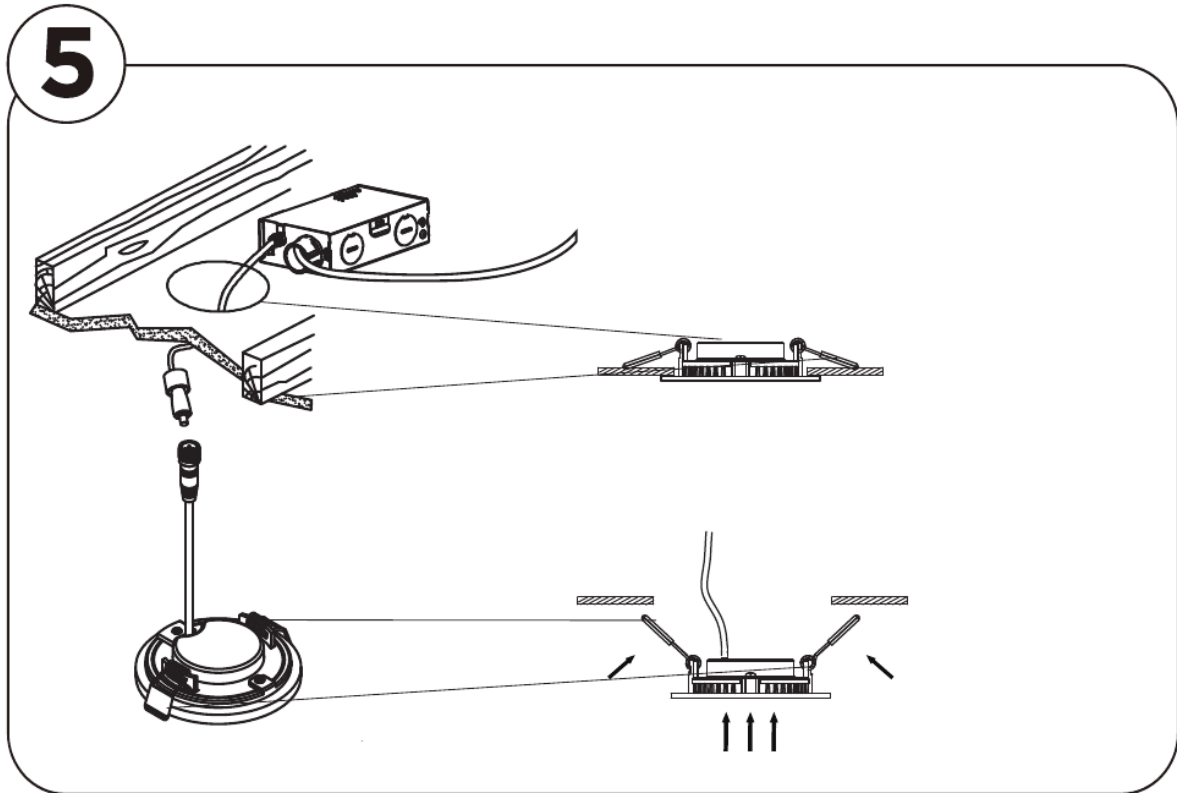

5. Raise clips to Vertical Position and insert light into the hole until light fix properly above ceiling.

6. See user manual to set up those lights

**Note:** This product is a smart light, using Direct Digital Controls rather than triac dimming. Here is two dimming way for you reference:

1. Download Cloudy Bay's APP, go to product group or single product page, adjust the brightness and CCT of white light or color light on control panel; you can also go to home page, click product group or single product's common function, adjust brightness and color temperature
2. Control with smart voice device such as Google Assistant or Amazon Alexa if you have installed it successfully.

If you only have a dimmer at hand, set it to highest level only. If light performance is not good, we strongly advise you to change it to a regular switch.

## **QUESTIONS? COMMENTS? SUGGESTIONS? COMPLAINTS?**

Please contact with us through

Toll-Free Phone Number: (1) 877-870-5171

smart@cloudybaylighting.com or info@cloudybaylighting.com [Manualsum](#)

We will do our best to make it right for you. Thank you very much!