

# [Gen2Wave USA 2BCW4-RS01 Rugged mobile computer User Manual](#)

## [Manualsum](#), simplified manuals

### Table of Contents

- [Gen2Wave PRIME RS01 Quick Manual](#)
  - [Specification](#)
  - [Package](#)
  - [Device Features](#)
  - [Card Installation](#)
  - [Charging the Device](#)
  - [How to use functions](#)
  - [How to use power](#)

## **Gen2Wave PRIME RS01 Quick Manual**

**Android™ 13**



Google, Android, Google Play and other marks are trademarks of Google LLC.

# GEN2WAVE

Address: #7 floor, Point town B/D, 187-4, Gumi-dong, Bundang-gu, Seongnam-si, Gyeonggi-do, 463-870, Rep. of Korea

Tel. +82-31-607-7537

Fax. +82-31-608-7537

Homepage: [www.gen2wave.com](http://www.gen2wave.com)

Email: [tcs@gen2wave.com](mailto:tcs@gen2wave.com)

## Specification

### Physical Characteristics

Item	Details
Dimensions	6.61(L) x 3.03(W) x 0.69(H) in. 168(L) x 77(W) x 17.4(H) mm
Weight	10.57oz / 300g
Display	5.5in. FHD+, 1080×2160, 650nits
Touch Panel	Dual mode capacitive touch with stylus, Corning Gorilla Glass 5
Battery	All in one type battery, 4,900mAh Li-polymer
Expansion Slot	MicroSD up to 512GB SDXC
Notification	Full color LED, Vibrate and audible tone
SIM Slot	2ea of Nano sim slots
Voice and Audio	Dual speakers for loud and clear sound, USB-C audio headset support, 3.5 mm audio jack, 3 MIC
Buttons	Left: Volume up, Volume down, PTT; Right: Power, F1, F2; TOP: SOS
Interface Ports	USB 3.0 (Bottom Type C): Host and Client, Pogo 2pins for charging, Pogo 2pins for Trigger Handle

[Manualsum](#)

## Performance Characteristics

Item	Details
CPU	Qualcomm® QCM6490 Octa-Core 2.7GHz
Memory	8GB RAM / 128GB UFS Flash
Operating System	Android 13 with GMS Certified

## User Environment

Item	Details
Operating Temperature	-4°F to 122°F/-20°C to 50°C
Storage Temperature	-40°F to 158°F/-40°C to 70°C
Humidity	5 to 95% non-condensing
Drop	MIL STD 810H (Multiple 5ft, 1.5m drops)
Tumble	500 1.6ft, 0.5m tumbles
Sealing	IP68
Vibration	MIL STD 810H (Vibration)
Thermal Shock	MIL STD 810H (-40°F to 158°F/-40°C to 70°C rapid transition)
Electrostatic Discharge (ESD)	+/- 15kv air discharge, +/- 8kv direct discharge, +/- 8kv indirect discharge

## IST

Sensor : Light, Magnetometer, Motion, Pressure, Proximity

## Data Capture

Item	Details
Barcode Scanning	Zebra SE4770
Camera	Front Camera : 8MP Rear Camera : 50MP Auto Focus with LED Flash
NFC	ISO 14443 Type A/B, FeliCa and ISO 15693 P2P mode and Card Emulation via Host.

## Wireless WAN

Item	Details
Radio Frequency Bands	US: 5G-NR: N2 / N5/ N12 / N25 / N30 / N38 / N41 / N48 / N66 / N71 / N77 / N78 LTE-FDD: B2 / B4 /B5 /B7 / B12 / B13 / B14 / B17 / B25 / B29 / B30 / B46 / B66 / B71 LTE-TDD: B38 / B41 / B42 / B43 / B48 WCDMA: B2 / B4 / BS GSM: B2 / B3 / B5 / B8

GPS GPS, GLONASS, Galileo, Beidou, QZSS Dual-Band

## Wireless LAN

Item	Details
Radio	WIFI 6E, 802.11 a/b/g/n/ac/ax
Operating Channels	Channel 1-13 (2401-2483 MHz):1,2,3,4,5,6,7,8,9,10,11,12,13; Channel 36-165 (5150-5850 MHz): 36,40, 44,48,52,56,60,64,100,104,108,112,116,120,124, 128, 132,136,140,144,149,153,157,161,165; Channel 1-233 (5925-7125 MHz); Channel Bandwidth: 20/40/80/160 MHz
Security and Encryption	WEP (40 or 104 bit); WPA/WPA2 Personal (TKIP, and AES); WPA3 Personal (SAE); WPA/WPA2 Enterprise (TKIP and AES); WPA3 Enterprise (AES) — EAP-TTLS (PAP, MSCHAP, MSCHAPv2); EAP-TLS, PEAPv00-MSCHAPv2, PEAPV1-EAP-GTC, LEAP, EAP- PWD)

## Wireless PAN

Bluetooth 5.2

## Package

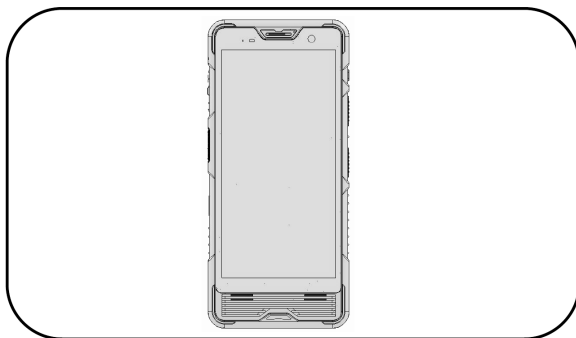

PRIME RS01

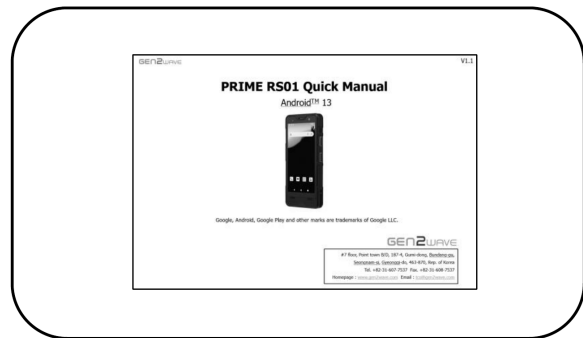

Quick Manual

NOTE. Items in the box may be changed according to the purchase order.

## Device Features

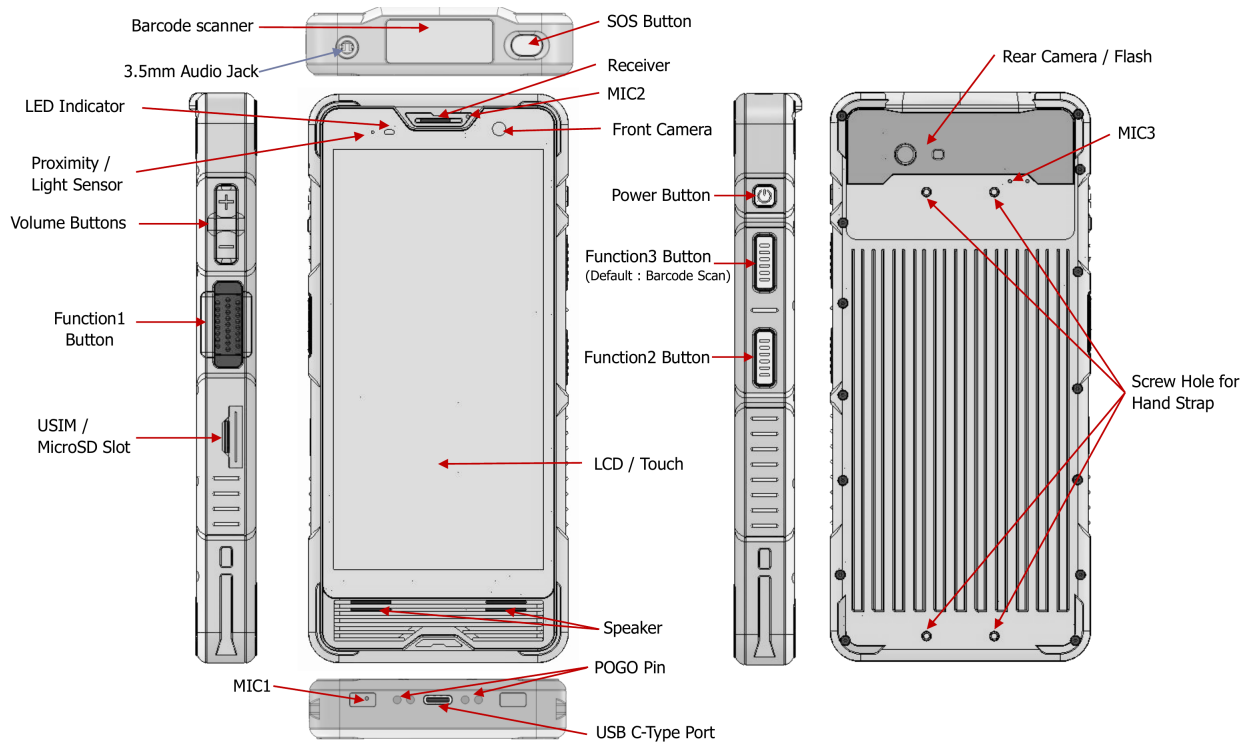

## Card Installation

### How to Insert SIM cards and a MicroSD card

1. Pull out the cover of the USIM(nano) and MicroSD slots.
2. Insert USIM card and Micro SD card into the slot.
3. Slide the slot into the device.

**USIM and MicroSD card can be removed in the reverse order.**

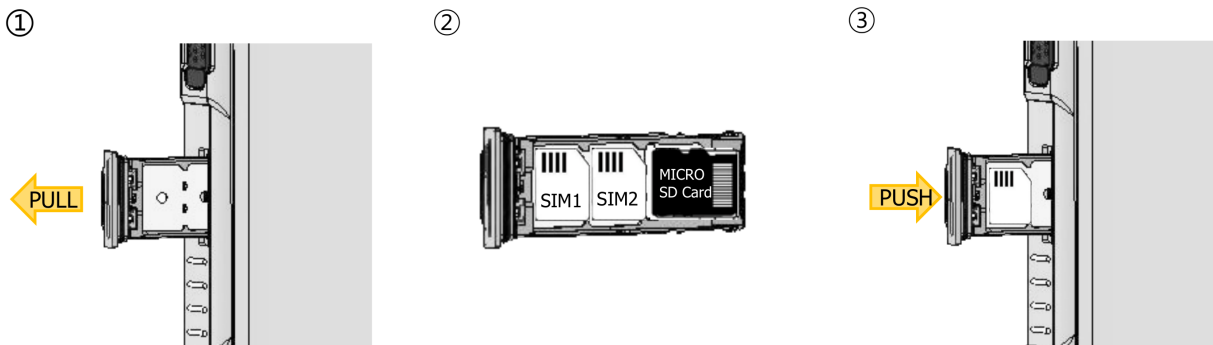

**Caution.** If the device is powered on and the SIM card is inserted, the device must be rebooted.

## Charging the Device

### Charging

1. The device battery can be charged by plugging in power cable to USB-C port.
2. When charging, the charging status LED of the device lights up, red when charging, and green when charging is complete.
3. Battery LED indicates as follows :

▶ OFF : Not Charging      Red LED : Charging      Green LED : Fully Charged

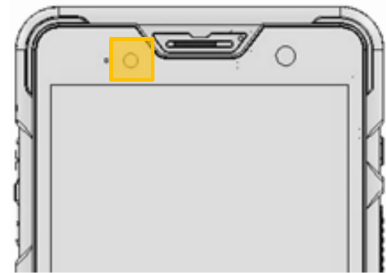
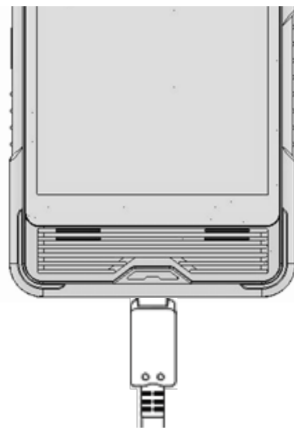

**Note:** Devices supports high-speed charging. Adapter voltage must be 5~9V and current is 2A or higher recommended.

**Caution:** Charging speed is slow when using a PC's USB port or adapter with less than 2A current.

## How to use functions

### Barcode Scanner

The laser aimer should be on the center of the barcode to get a successful read.



Success



Fail

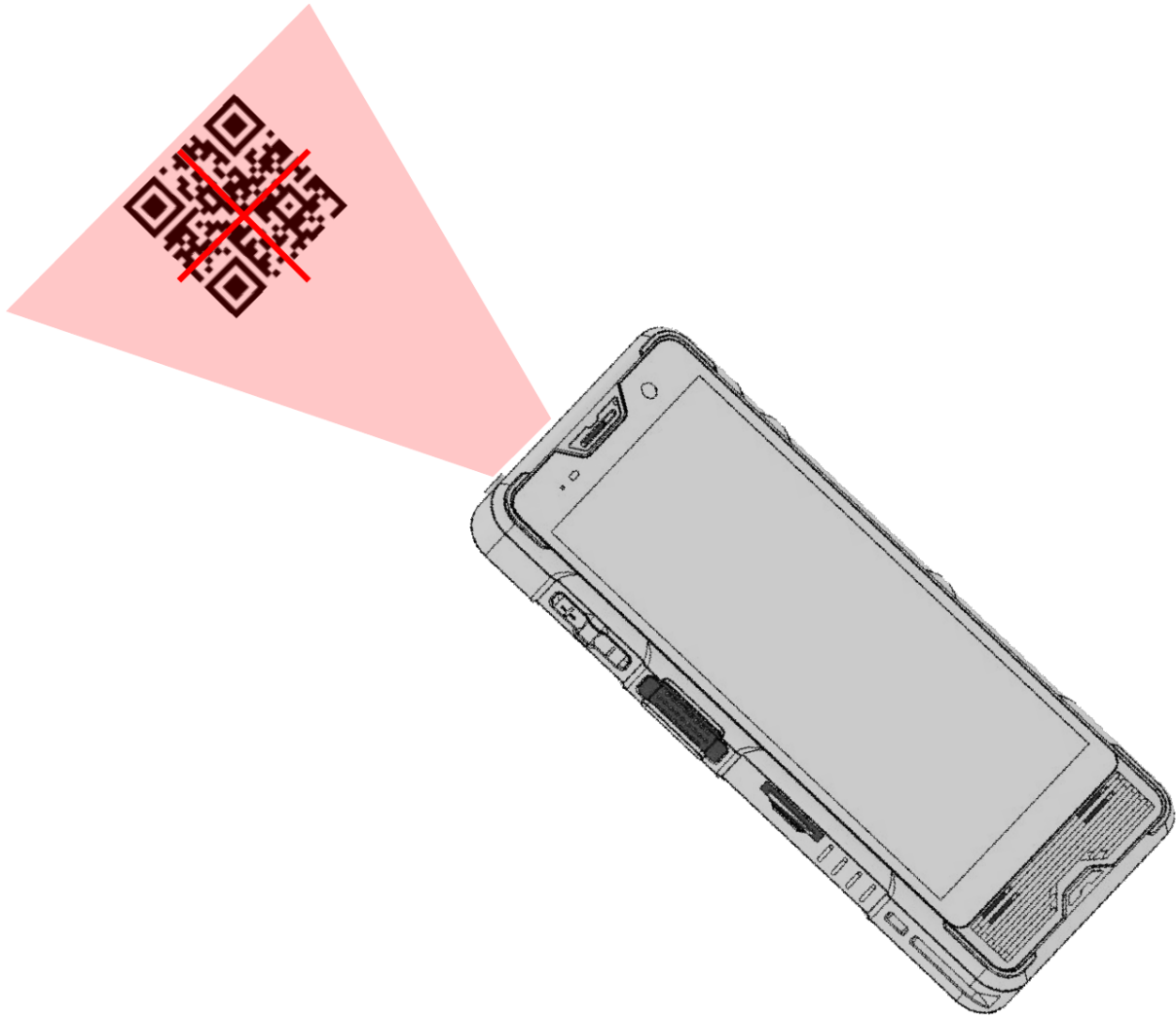

### **NFC Reader**

Since NFC antenna is integrated in the rear side of the device, read the contactless card as shown. NFC reading distance depends on the NFC card type.



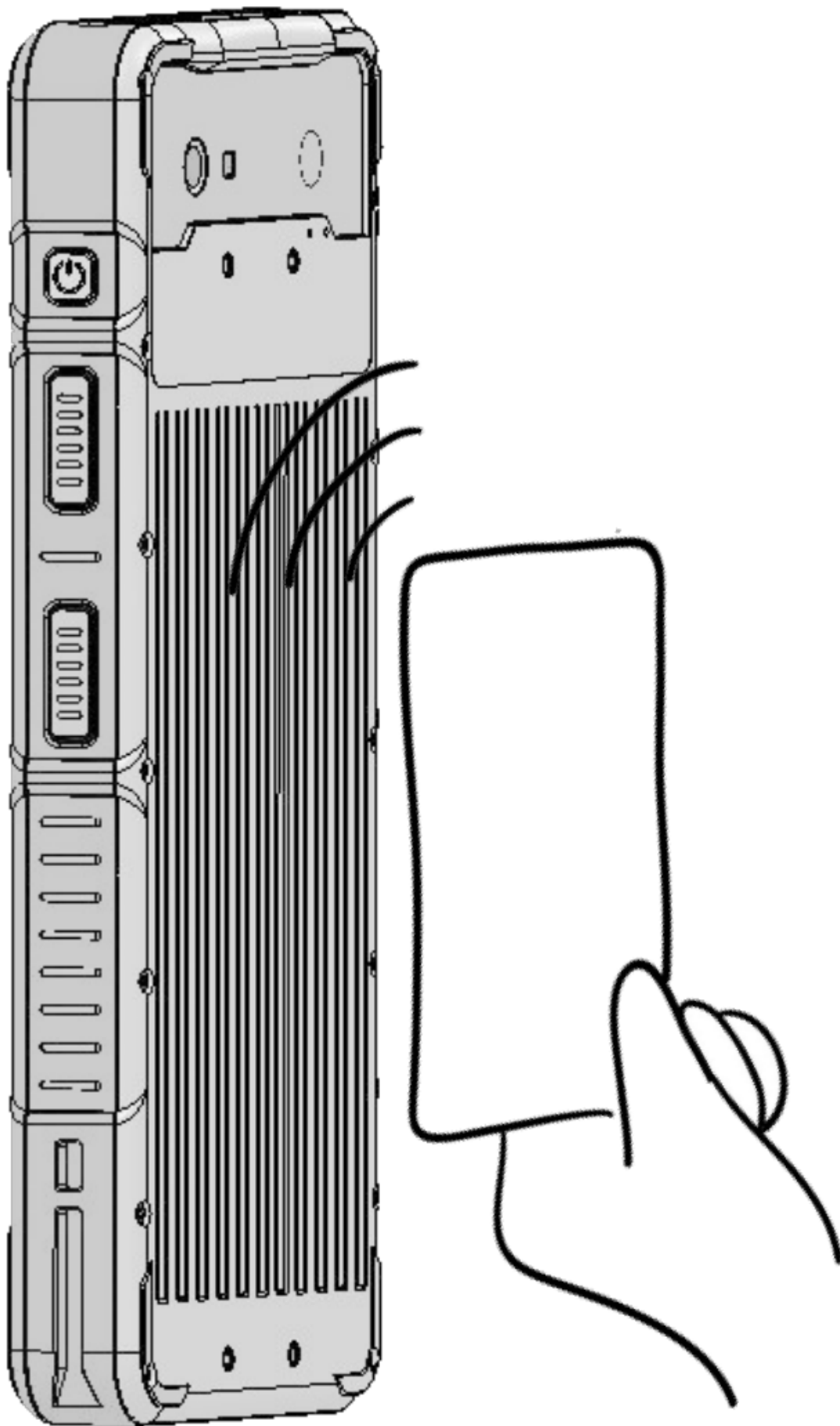

# How to use power

## Power On

Press the power button for 1 second to turn on the device.

The power LED briefly turns green on the screen, then turns off, and the GEN2WAVE logo appears.

## Power Off

Press the power button until the system menu appears and touch Power off icon.

## Soft Reset

Press the power button until the system menu appears and touch Restart icon.

## Hard Reset

Press and hold the power button for approximately 10 seconds to reboot the device..

## Factory Reset

Follow the below steps to Factory Reset.

Path : Settings — System — Reset options — Erase all data (factory reset) — Erase all data

**Caution:** Factory Reset : Erase all data and restore default settings.