

# [Hunan Greatwall Computer System Tablet User Manual](#)

## [Manualsum](#), simplified manuals

### Table of Contents

- [Hunan Greatwall Computer System Tablet User Manual](#)
  - [In The Box](#)
  - [Get to Know Your Tablet](#)
  - [Charging Your Tablet](#)
  - [Important Safety Instructions](#)

# Hunan Greatwall Computer System Tablet User Manual

Hunan Greatwall Computer System Tablet User Manual

[2APUQ-LM1097P](#)

## In The Box

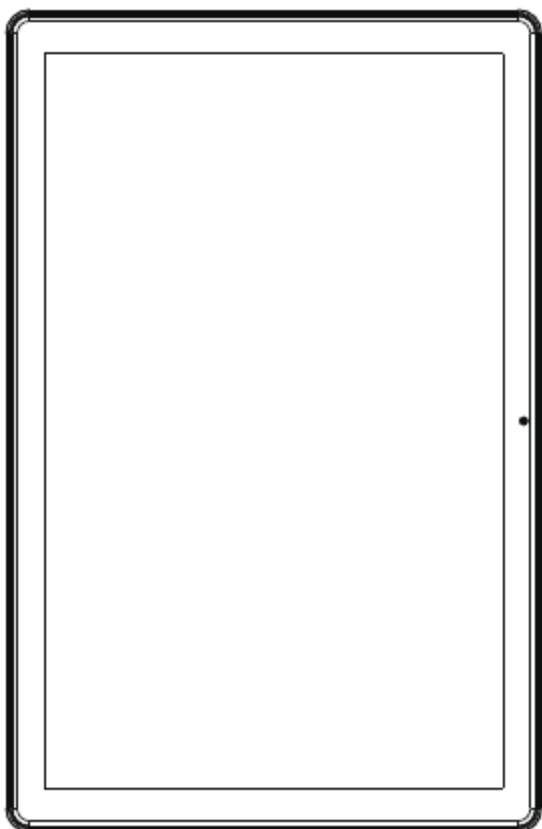

10.1" Tablet

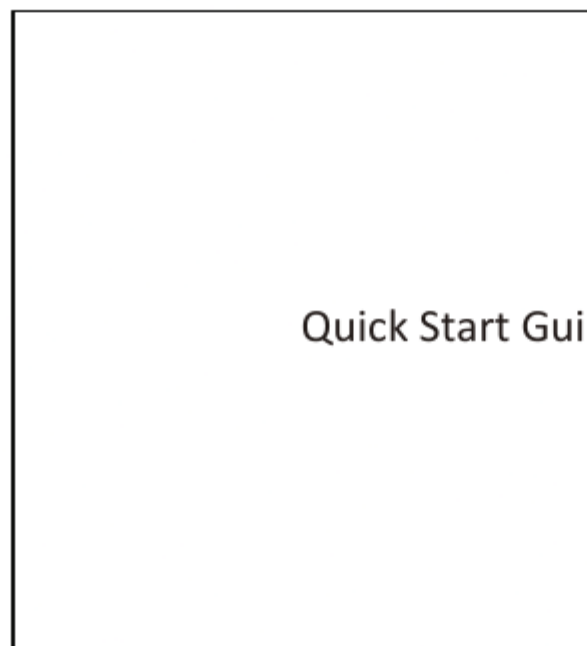

Quick Start Gui

Quick Start Guid

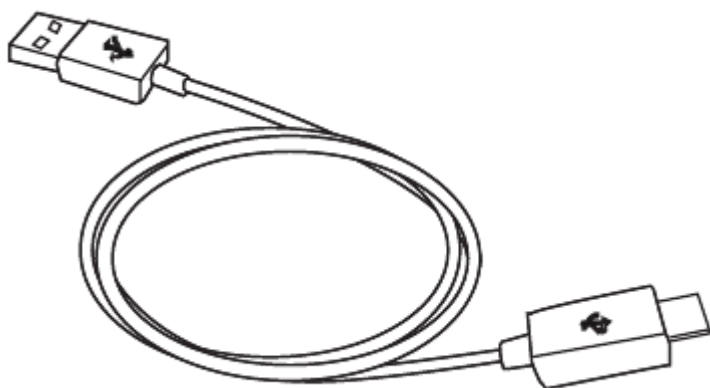

USB-C cable

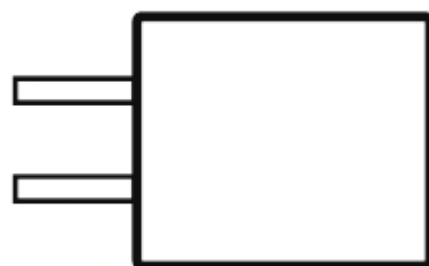

Charger

**Input:** 100-240V~50/60

**Output:** 5.0V = 2

# Get to Know Your Tablet

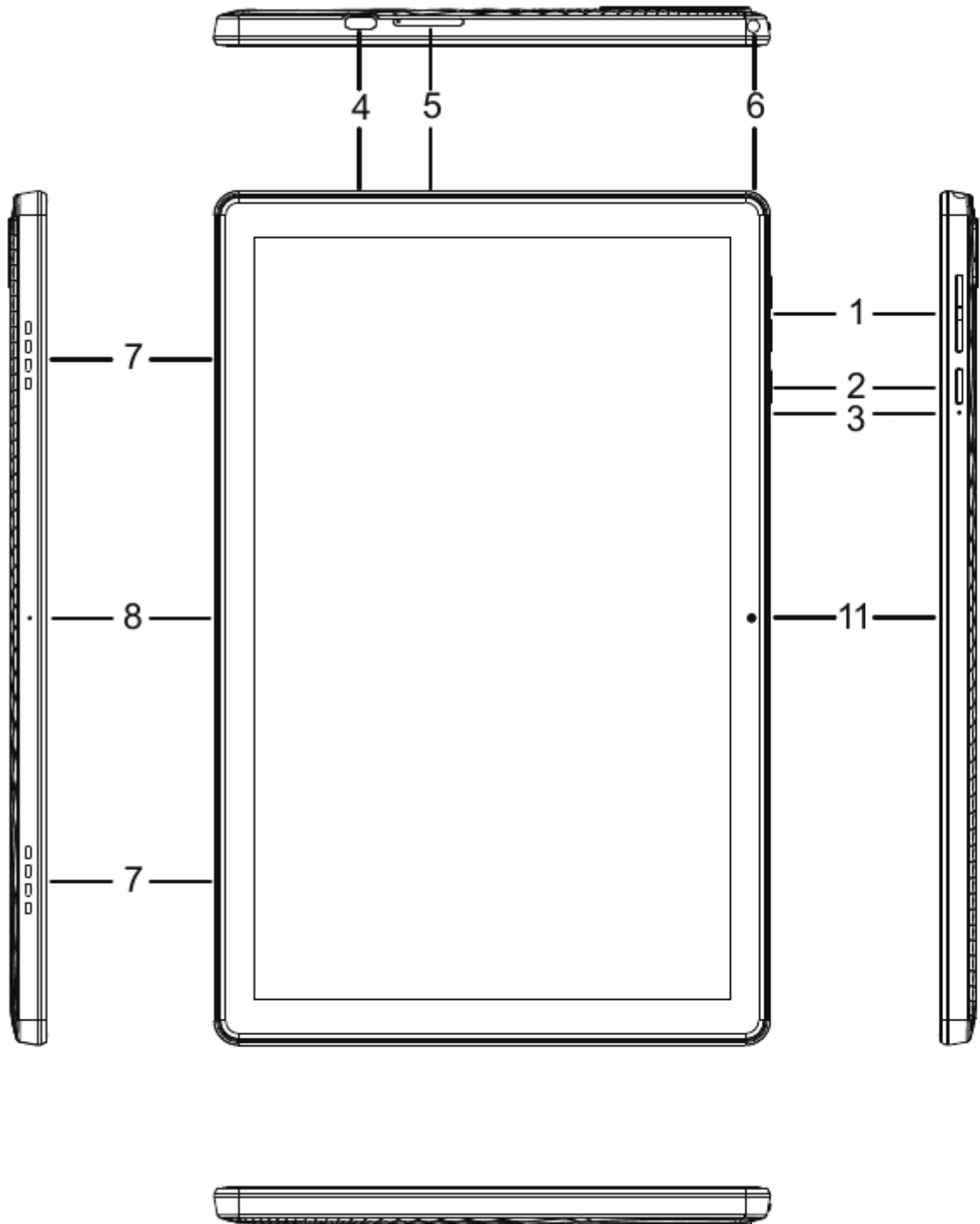

# Charging Your Tablet

It is recommended to fully charge the tablet before first use. To charge the tablet, 1) plug the USB cable into the AC adapter, 2) attach the other end to the USB-C input on the tablet, 3) plug the AC adapter into a wall outlet.

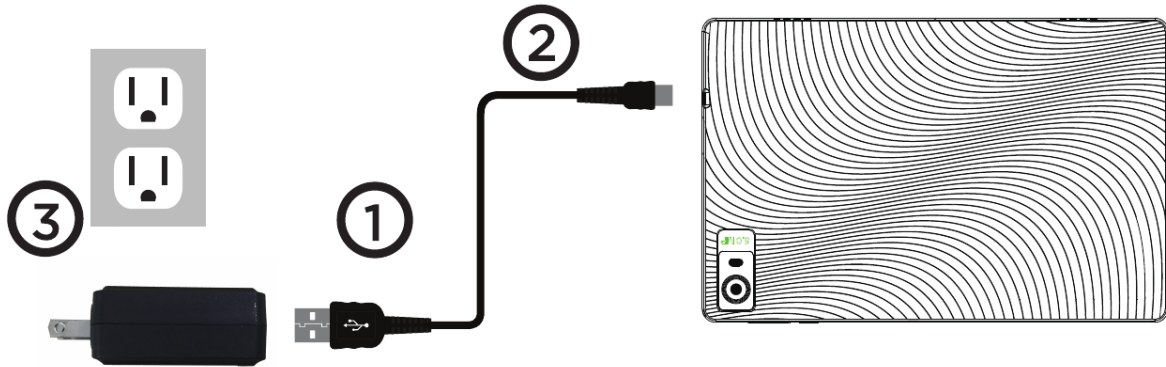

When the tablet is ON and charging, the battery icon will pulsate.

It is normal for the tablet to get warm while charging, playing games, or streaming video.

Battery life will vary depending on usage.

**Note:** Leave tablet in a well ventilated area while charging.

## Important Safety Instructions

1. Do not install near any heat sources such as radiators, heat registers, stoves, or other apparatus (including amplifiers) that produce heat.
2. **WARNING: Only use attachments/accessories specified or provided by the manufacturer (such as the exclusive supply adapter, battery etc).**
3. **WARNING: The mains plug should be kept in a state that can be disconnected at anytime to avoid emergency situation.**
4. **WARNING: The apparatus should not be exposed to dripping or splashing. Objects filled with liquids, such as vases or drinking glasses, should not be placed on the apparatus**
5. **WARNING: Please refer the electrical and safety information on tablet and user manual before installing or operating the apparatus.**

Use the device where the ambient temperature is between 0° and 35° C (32° to 95° F). Low-Or high-temperature conditions might cause the device to change its behavior to regulate its temperature. Using your tablet in very cold conditions outside of its operating range might temporarily shorten the battery life and could cause the device to turn off. Battery life will return to normal when you bring the device back to higher ambient temperatures.

Using the device in very hot conditions can permanently shorten battery life.