

# **DIGILAND Octa Core Tablet User Manual**

## **Manualsum, simplified manuals**

### Table of Contents

- [DIGILAND Octa Core Tablet User Manual](#)
- [Quick Setup Guide](#)
  - [Features](#)
  - [Important safety instructions](#)
  - [Charging the battery](#)
  - [Turning on your tablet](#)
  - [Setting up your tablet](#)
  - [Turning off your tablet:](#)
  - [Warning Statement](#)

## **DIGILAND Octa Core Tablet User Manual**

DIGILAND Octa Core Tablet User Manual

DIGILAND 10.1 Inch Octa Core Tablet

Lightcomm Technology XMF-MID1058 10.1inch Tablet User Manual

[XMF-MID1058](#)

**DIGILAND**

## **Quick Setup Guide**

10.1 Inch Octa Core Tablet

[Manualsum](#)

# Features

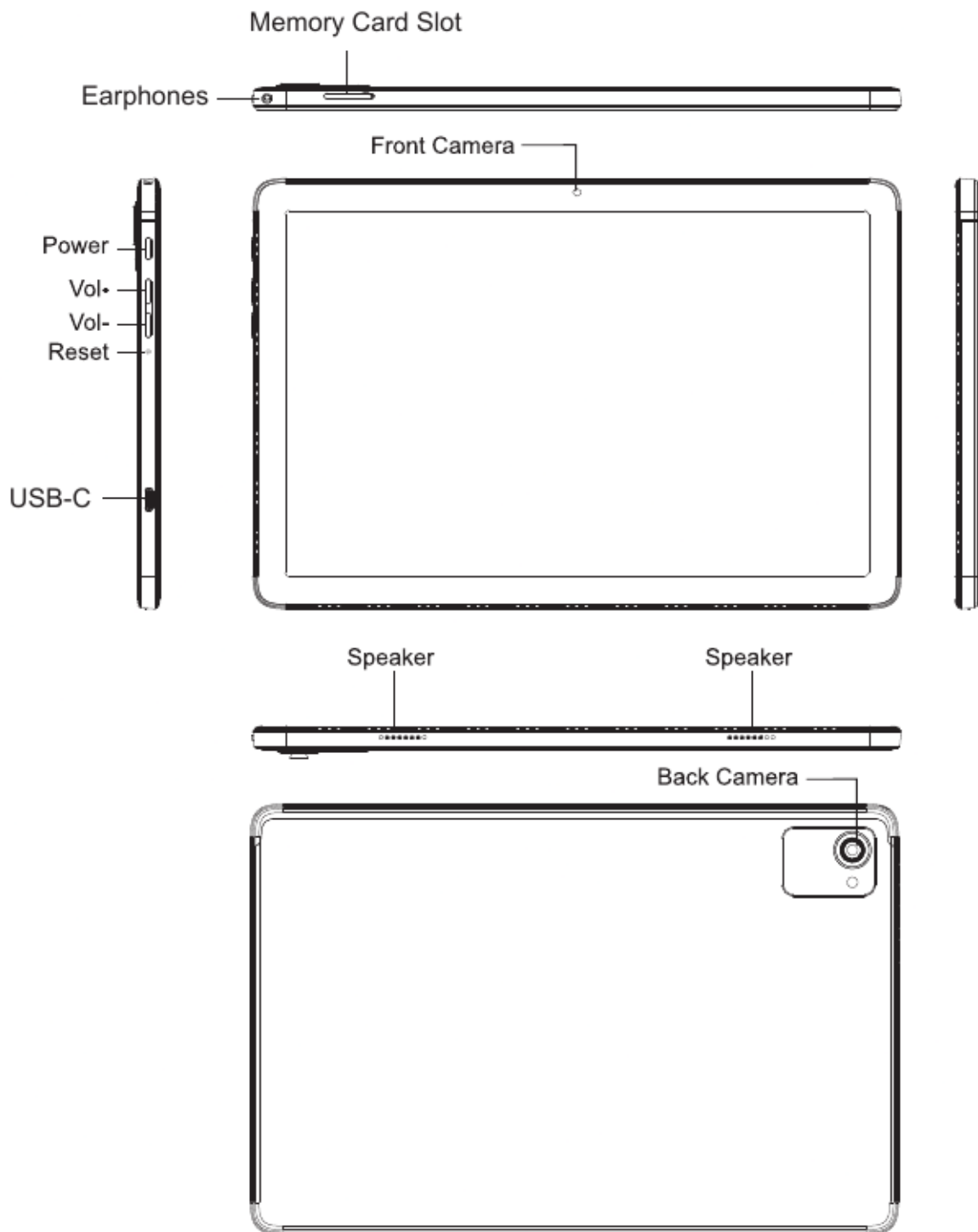

## Important safety instructions

1. Please read this instruction carefully before using your device to ensure safe and correct use.

2. Always leave sufficient space around the product for ventilation. Do not place product in or on a bed, rug, in a bookcase or cabinet that may prevent air flow through vent openings.
3. Do not use this unit near water. Do not place over the unit any container with liquid inside.
4. Please do not put your device in high temperature, moisture or dust place. The tablet is not waterproof.
5. Avoid falling or violent collision. Do not violently shake the touch screen, otherwise, it could lead to damage or display abnormal.
6. If system shutdown automatically, it means the battery may used up, battery charging is required.
7. Please charge the tablet regularly if not in use for a long time to avoid the damage caused by the excessive consumption of battery.
8. Do not disassemble or use alcohol, thinner or benzene class to swab product surface.
9. Please do not use the tablet when driving or walking in the street, otherwise it may lead an accident.
10. Please choose the appropriate volume, if had tinnitus, please lower the volume or stop using.
11. When CPU operates in high speed, especially playing 3D games or High-definition video for a long time, the fuselage will have fever.
12. The battery is contained with the device, please do not take out the battery.

## Charging the battery

**Note:** Charge your tablet fully before using it the first time.

1. Connect the USB cable to your tablet.
2. Connect the other end of the USB cable to the USB power adapter (wall charger), then plug the adapter into a power outlet. It takes about three hours to fully charge your tablet.

**Caution:** Use only the included power adapter to charge your tablet's battery. An incompatible adapter may damage your tablet.

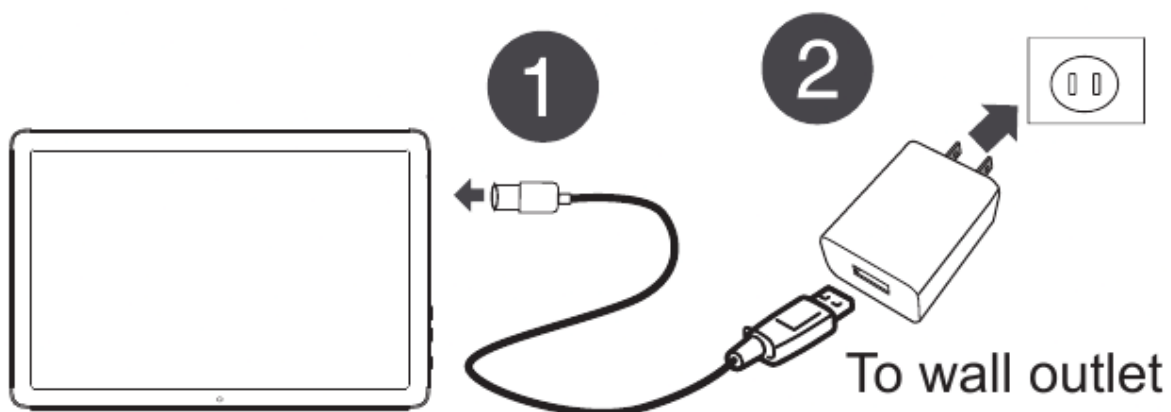

## Turning on your tablet

Press and hold the “power button” on the side of your tablet.



## Setting up your tablet

When you turn on your tablet for the first time, you'll be prompted to set up things like Wi-Fi and email.

Follow the instructions displayed on your tablet to complete setup.

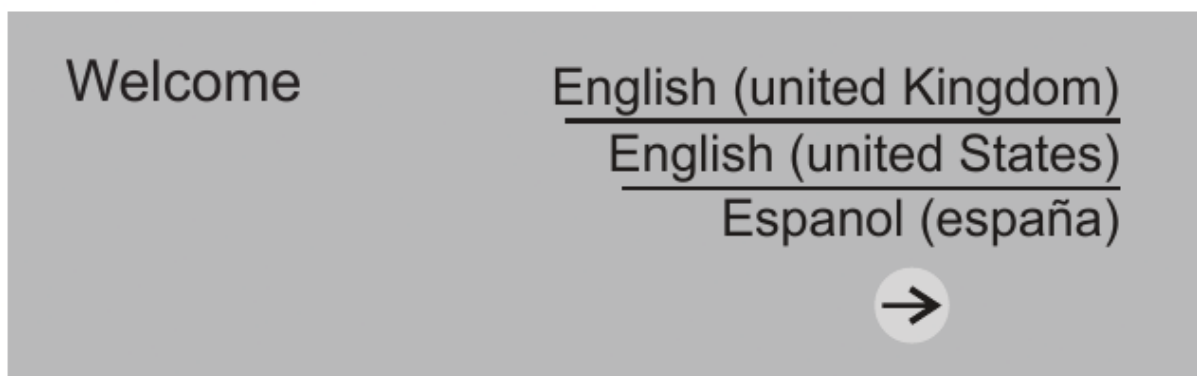

## Turning off your tablet:

1) Press and hold “power button” for 1 second to turn off tablet .



2) Tap Power Off.

## Warning Statement

Operation is subject to the following two conditions: this device | may not cause interference, and this device must accept any interference, including interference that may cause undesired operation of the device.

Shielded cables must be used with this unit to ensure compliance with the Class B FCC limits.

This TABLET meets the government's requirements for exposure to radio waves. The guidelines are based on standards that were developed by independent scientific organizations through periodic and thorough evaluation of scientific studies. The standards include a substantial safety margin designed to assure the safety of all persons regardless of age or health.

### FCC RF Exposure Information and Statement

the SAR limit of USA (FCC) is 1.6 W/kg averaged over one gram, of tissue. Device types: TABLET has also been tested against this SAR limit. This device was tested for typical body-worn operations with the back of the phone kept 0mm from the body. To maintain compliance with FCC RF exposure requirements, use accessories that maintain an 0mm separation distance between the user's body and the back of the phone. The use of belt clips, holsters and similar accessories should not contain metallic components in its assembly. The use of accessories that! do not satisfy these requirements may not comply with FCC RF exposure requirements, and should be avoided.