

[Nanoleaf Sense+ Smart Wireless Switch Button User Manual](#)

[Manualsum](#), simplified manuals

Table of Contents

- [Nanoleaf Sense+ Smart Wireless Switch Button User Manual](#)
 - [WARNINGS & CAUTIONS](#)
 - [WARRANTY](#)
 - [CLEANING AND MAINTENANCE](#)
 - [GOOGLE SEAMLESS BLURB](#)
 - [FREQUENCY RANGE](#)
 - [NOTE:](#)
 - [WARNINGS](#)

Nanoleaf Sense+ Smart Wireless Switch Button User Manual

Nanoleaf Sense+ Smart Wireless Switch Button User Manual

NANOGRID Nanoleaf Sense+ Smart Button User Manual

FCC id: [2AEWY-NL44](#)



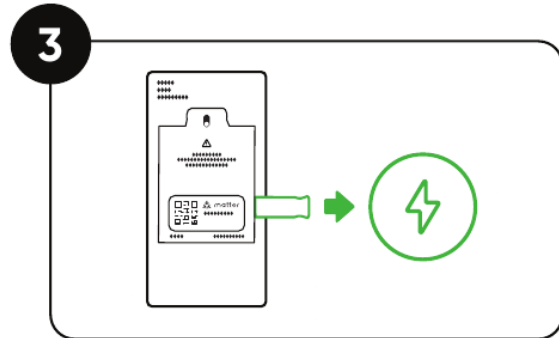
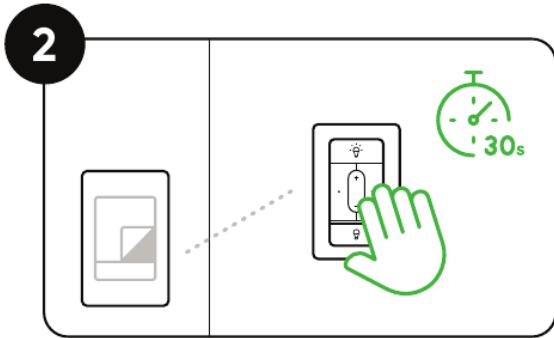
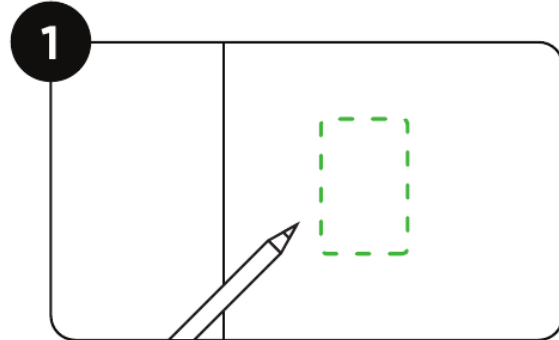
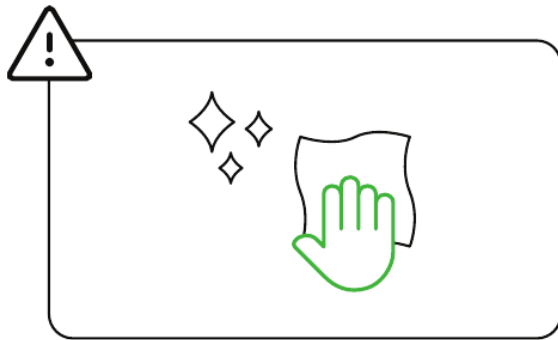





4

 To download the Nanoleaf App on your smartphone, scan the respective QR codes.

Add Device

 OR 

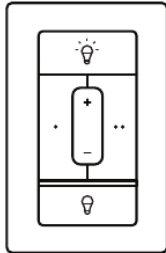

WARNINGS & CAUTIONS

READ AND FOLLOW ALL SAFETY INSTRUCTIONS Please read this safety information carefully and keep this document for future reference.

Help articles and customer support is always available at <https://nanoleaf.me/support>. This product contains a lithium button/coin cell battery. If a new or used lithium button/coin cell battery is swallowed or [Manualsum](#)

enters the body, it can cause severe internal burns and can lead to death in as little as 2 hours.

Always completely secure the battery compartment. If the battery compartment does not close securely, stop using the product, remove the batteries, and keep it away from children. If you think batteries might have been swallowed or placed inside any part of the body, seek immediate medical attention.

Remove and immediately recycle or dispose of used batteries according to local regulations and keep away from children.

Do NOT dispose of batteries in household trash or incinerate. Even used batteries may cause severe injury or death. Call a local poison control center for treatment information. Non-rechargeable batteries are not to be recharged.

Do not force discharge, recharge, disassemble, heat above 60°C or incinerate. Doing so may result in injury due to venting, leakage or explosion resulting in chemical burns.

Ensure the batteries are installed correctly according to polarity (+ and -).

Do not mix old and new batteries, different brands or types of batteries, such as alkaline, carbon-zinc, or rechargeable batteries. Remove and immediately recycle or dispose of batteries from equipment not used for an extended period of time according to local regulations. Batteries type (CR2477); and Nominal voltage: 3V.

WARRANTY

Nanoleaf warrants that this device's hardware components will be free from defects in material and workmanship for a period of two (2) years from the date of purchase, unless a different period is stated in or on the packaging of the product, based on up to 3 hours average working time per day/7 days per week, when used as directed (the "Warranty Period").

Notwithstanding the foregoing, the Warranty Period for all Energy Star-certified products is three (3) years from the date of purchase.

This limited warranty only applies to the hardware components contained in the original packaging. This limited warranty does not apply to any software, even if packaged or sold with the hardware components.

Nanoleaf does not warrant that use of this device will be uninterrupted or error-free. If this device does not conform to this limited warranty, Nanoleaf will send you, at its election, a replacement device or refund your original price upon receipt of the returned device, register receipt and proof of purchase.

Please reach out to our customer support to find out how to return the device. This limited warranty does not cover devices subject to accident, neglect, abuse, misuse or acts of God.

REPLACEMENT OR REFUND IS YOUR SOLE REMEDY. EXCEPT TO THE EXTENT PROHIBITED BY APPLICABLE LAW, ANY IMPLIED WARRANTIES ARE LIMITED IN DURATION TO THE DURATION OF THIS LIMITED WARRANTY. LIABILITY FOR INCIDENTAL OR CONSEQUENTIAL DAMAGES IS HEREBY EXPRESSELY EXCLUDED.

Some states and provinces do not allow exclusion of incidental or consequential damages, so the above limitation or exclusion may not apply to you. This limited warranty gives you specific legal rights, and you may also have other rights which vary from state to state and province to province.

CLEANING AND MAINTENANCE

Clean with a soft dry cloth, and do not use harsh cleaning agents. Manage in accordance with disposal laws in your area.

GOOGLE SEAMLESS BLURB

Nanoleaf® Essentials is a lighting product by Nanoleaf Ltd. that pairs to a Google Account and uses Google services to connect to the internet. For setup and full feature access including remote control, mobile alerts, and software updates, Nanoleaf® Essentials requires a compatible assistive device (full list available at g.co/nest/assistivedevice) and a working internet connection over Wi-Fi, the free Google Home app, and an active Google Account.

Minimum requirements are available at g.co/nest/devicereq.

Availability and performance of certain features are service-, device-, and network-dependent and may not be available in all areas. All features, functionality, and product specifications are subject to change without notice or obligation. Voice control with the Google Assistant requires a compatible smart device. Google and related marks and logos are trademarks of Google LLC.

FREQUENCY RANGE

Bluetooth: 2400-2483.5 MHz <10dBm

Thread: 2405-2480MHz <10dBm

NOTE:

This equipment has been tested and found to comply with the limits of a Class B digital device, pursuant to part 15 of the FCC Rules and the [Manualsum](#)

Canadian ICES-003 Class B specifications. These limits are designed to provide reasonable protection against harmful interference in a residential installation. This equipment generates, uses and can radiate radio frequency energy and, if not installed and used in accordance with the instructions, may cause harmful interference to radio communications.

However, there is no guarantee that interference will not occur in a particular installation. If this equipment does cause harmful interference to radio or television reception, which can be determined by turning the equipment off and on, the user is encouraged to try to correct the interference by one or more of the following measures: Reorient or relocate the receiving antenna; Increase the separation between the equipment and receiver; Connect the equipment into an outlet on a circuit different from that to which the receiver is connected; Consult the dealer or an experienced radio/TV technician for help.



WARNINGS



- **INGESTION HAZARD:** This product contains a button cell or coin battery. DEATH or serious injury can occur if ingested.

[Manualsum](#)

- A swallowed button cell or coin battery can cause Internal Chemical Burns in as little as 2 hours.
- KEEP new and used batteries OUT OF REACH of CHILDREN.
- Seek immediate medical attention if a battery is suspected to be swallowed or inserted inside any part of the body.

**Nanoleaf
Canada**

#400 - 100
Front Street East
Toronto, ON
MSA 1E1,
Canada

**Nanoleaf Hong
Kong**

NanoGrid Limited
#1301-483A
Castle Peak Rd,
Kowloon, Hong
Kong

**Nanoleaf
Europe SAS**

11 Rue de
Lourmel
75015 Paris.
France

**Nanoleaf Europe
SAS**

P/A 4 Eyes Ltd, Bay
House, Cocks Hill,
Perranzabuloe,
Cornwall TR6 OAT,
United Kingdom