

NIMBA OFLO Sound Machine User Manual 2BFTS-OFLO

[Manualsum](#), simplified manuals

Table of Contents

- [NIMBA](#)
- [OFLO Sound Machine](#)
 - [Important Safety Instructions](#)
 - ■ ■ [Important Safety Instructions](#)
 - [Warnings/Cautions](#)
 - [Regulatory and Legal Information](#)
 - ■ ■ [Management Regulation for Low-power Radio-frequency Devices](#)
 - [Article XII](#)
 - [Article XIV](#)
 - [App Control and Setup](#)
 - ■ ■ [Nimba App](#)
 - [Bluetooth](#)
 - [Connect your Mobile Device](#)
 - [Note: Nimba OFLO must be within range \(6ft or 2m\) and powered on.](#)
 - [Disconnect a Mobile Device](#)
 - [Battery](#)
 - ■ ■ [Charging](#)
 - [Button Overview](#)
 - [Functions](#)
 - [Troubleshooting](#)
 - ■ ■ [Other solutions](#)
 - [Factory Data Reset](#)
 - [Specifications](#)

NIMBA

OFLO Sound Machine

Important Safety Instructions

Read and follow all instructions and warnings in this user manual

Important Safety Instructions

1. Read these instructions.
2. Keep these instructions.
3. Heed all warnings.
4. Follow all instructions.
5. Do not place near any heat sources such as radiators, heat registers, stoves, or other products (including amplifiers) that produce heat.
6. Clean only with a dry cloth.
7. Refer all servicing to qualified personnel. Servicing is required when the product has been damaged in any way, such as power-supply cord or plug is damaged, liquid has been spilled or objects have fallen into the product, the product has been exposed to rain or moisture, does not operate normally, or has been dropped.

Warnings/Cautions

1. Keep the product away from fire and heat sources. Do NOT place naked flame sources, such as lighted candles, on or near the product.
2. Do NOT make unauthorized alterations to this product.
3. Do NOT use a power inverter with this product.
4. The battery provided with this product may present a risk of fire or chemical burn if mishandled.
5. Do not expose products containing batteries to excessive heat (e.g. from storage in direct sunlight, fire or the light)
6. Do NOT use any charger other than that specifically provided for use with the product.

Regulatory and Legal Information

Management Regulation for Low-power Radio-frequency Devices

Article XII

According to “Management Regulation for Low-power Radio-frequency Devices” without permission granted by the NCC, any company, enterprise, or user is not allowed to change frequency, enhance transmitting power or alter original characteristic as well as performance to an approved low power radio- frequency devices.

[Manualsum](#)

Article XIV

The low power radio-frequency devices shall not influence aircraft security and interfere legal communications; If found, the user shall cease operating immediately until no interference is achieved. The said legal communications means radio communications operated in compliance with the Telecommunications Act.

The low power radio-frequency devices must be susceptible with the interference from legal communications or ISM radio wave radiated devices.

DON'T attempt to remove the rechargeable lithium-ion battery from this product. Contact your local Bose retailer or other qualified professional for recycling and disposal.

App Control and Setup

Nimba App

The Nimba app lets you set up and control Nimba OFLO from your mobile device. Using the app, you can select and download sounds and music, set wake-up alarms, and manage OFLO settings.

Bluetooth

Bluetooth Low Energy wireless technology lets you control OFLO using the Nimba app on your mobile device. Before you can control OFLO, you must download the app and connect your device with OFLO.

Connect your Mobile Device

1. Download the Nimba app



2. Follow the steps shown in the App

Note: Nimba OFLO must be within range (6ft or 2m) and powered on.

Disconnect a Mobile Device

Use the Nimba app to disconnect a device.

You can also disable the Bluetooth feature on your device to disconnect. Disabling the Bluetooth feature on your device disconnects all other devices.

Battery

Charging

Use the included USB Type-A® to Type-C® power cable and power adapter to charge the device.

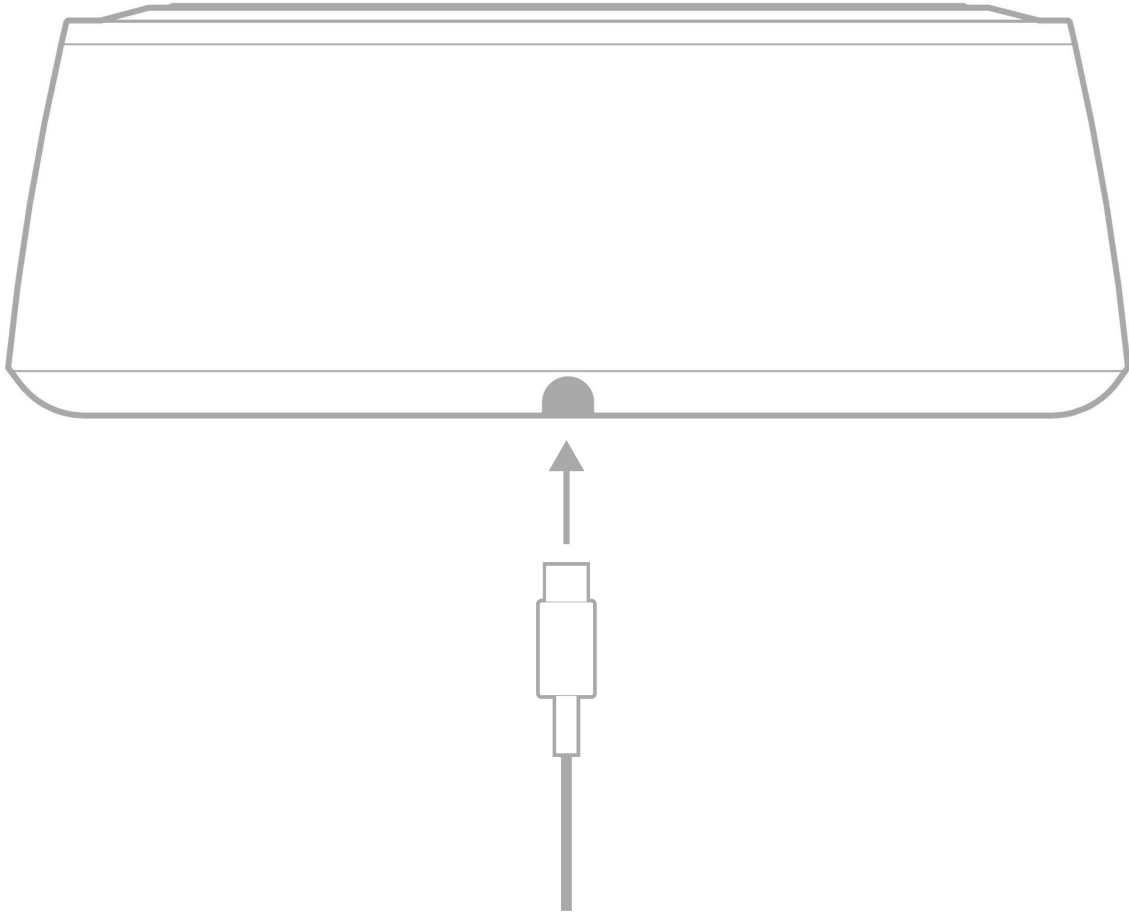

While charging, the battery indicator will blink and show its current battery level. When the battery is fully charged, the battery indicator glows solid white.

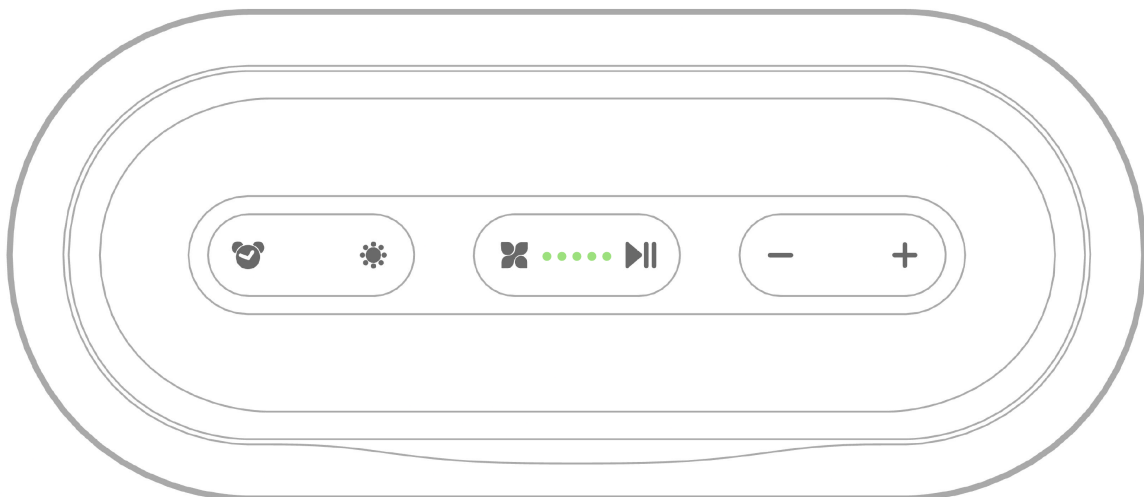

With typical usage, the battery lasts up to 8 hours. Battery performance varies with the volume at which it's played, and lighting at which it's set.

Battery will fully charge in approximately 3.5 hours when using the included power adapter and cable.

[Manualsum](#)

CAUTION: Do NOT store your speaker for extended periods when fully charged or with a remaining charge of less than 10 percent.

Button Overview

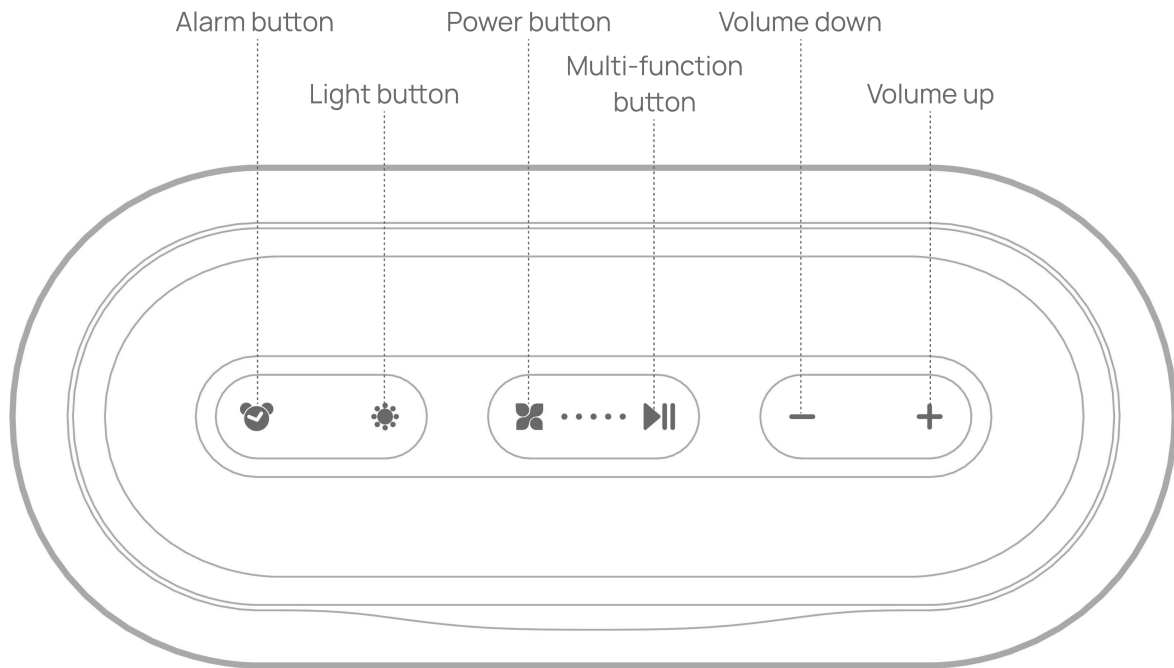

Functions

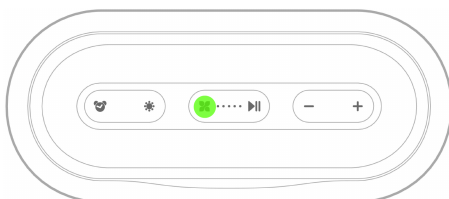

Power on/off

- Press and hold to turn the device on/off

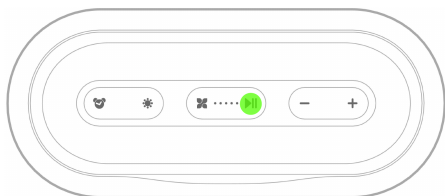

Play/Pause/ Next

- Press once to play or pause audio
- Press twice quickly to change to the next track

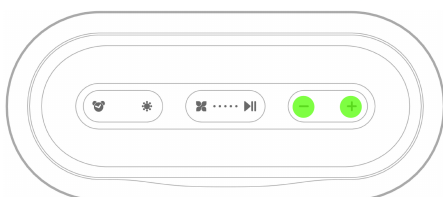

Volume up/ down

- Press - to lower the volume
- Press + to increase the volume

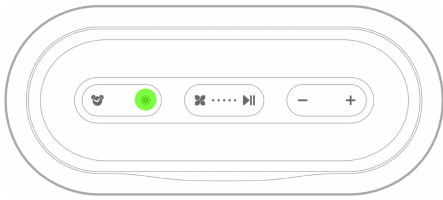

Light control

- Press and hold to turn on or off the light
- Press once to change brightness and set at the desired level

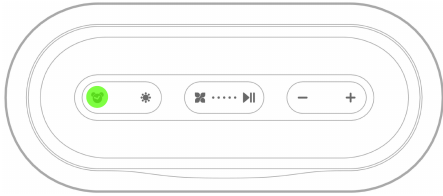

Alarm stop/ snooze

- Press once to snooze the alarm
- Press twice quickly to stop the alarm

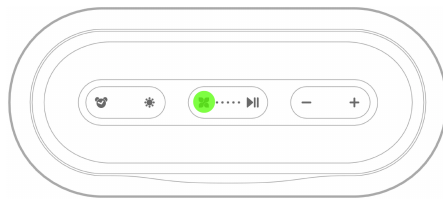

Blackout mode

- Press once to display clock and battery Indicator

Troubleshooting

TRY THESE SOLUTIONS FIRST

If you experience problems with OFLO, or connecting to the Nimba app, try these solutions first:

1. Charge OFLO (see page 6)
2. Move your mobile device closer to OFLO (within 6 ft or 2 m) and away from any interference or obstructions.
3. Make sure that your device supports Bluetooth Low Energy (also called Bluetooth Smart). All devices that are compatible with iOS 10 and newer and most devices that are compatible with Android 5.0 and newer support Bluetooth Low Energy.
4. Check the Nimba app to make sure that the software for OFLO is up to date.
5. Make sure that you are using the Nimba app, not a different app, to control OFLO(see page 5).

Other solutions

If you could not resolve your issue, see the table below to identify symptoms and solutions to common problems. If you are unable to resolve your issue, contact Nimba customer service.

SYMPTOMS

Sound Machine Does Not Turn On

SOLUTION

- Battery may be discharged, connect your sound machine to a wall charger [Manualsum](#)

- | | |
|---|---|
| Sound machine does not charge | <ul style="list-style-type: none"> • Press and Hold the power button over 10 seconds • Make sure the provided power adapter and cable is used • Make sure the connector on the cable is correctly aligned with the connector on the sound machine • Try another charging source |
| Sound machine does not connect with app | <ul style="list-style-type: none"> • Restart the sound machine and try again • Ensure that the Bluetooth feature is enabled • Turn off and on the Bluetooth in your mobile device |
| No Sound | <ul style="list-style-type: none"> • Press the Play/Pause/Next button to play sound • Press the + button to increase the volume |
| No Light | <ul style="list-style-type: none"> • Make sure the Blackout mode is off • Press the light control button • Increase the intensity using Nimba app |
| Sound machine not respondin to multi-button-presses | <ul style="list-style-type: none"> • For multi-press functions using the Multi-function button, vary the speed of presses. |
| Sound machine not responding | <ul style="list-style-type: none"> • Press and hold the power button over 10 seconds |

Factory Data Reset

Reset your OFLO to its factory default settings, this will erase all setting. Only downloaded music and sounds will be kept.

Specifications

Model	OFLO
Rated input voltage adapter	100-240Vac
Rated input frequency adapter	50/60Hz
No-load power adapter	< 0.1W
Rated output voltage adapter	5Vdcca
Average Standby Power appliance Condition: (All functions suspended, ambient light scenario; day 12h, 500 lux and night 12h, 0 lux)	< 0.5W
clock display at maximum brightness setting	
USB charging port	5V, 1000mA
Nominal light output (level 1 - 10)	1-35 lux
Nominal light color (level 1 - 10)	1500-5000K

Physical Characteristics

Dimensions (Height x Width x Depth)	18.8 x 8.1 x 7 cm (7.4x3.2 x 2.8in.)
Weight main unit / adapter	Approx. 0.4kg (14.1oz) / 0.14kg (4.9oz)
Cord length adapter	120cm (4 feet)
Average battery life	Up to 8 hours
Average charging time	Approx. 3.5 hours
BLE version	5.2
Inputs	USB Type-C®

Classification

Main Unit	Portable Electric Sound Machine
Adapter	Class 2 power supply
Mode of operation	Continuous

Operating Conditions

Temperature +5°C to +35°C (41°F to 95°F)
Relative humidity 15% to 90% (no condensation)

Storage Conditions

Temperature -20°C to +50°C (-4°F to +122°F)
Relative humidity 15% to 90% (no condensation)