

TX02

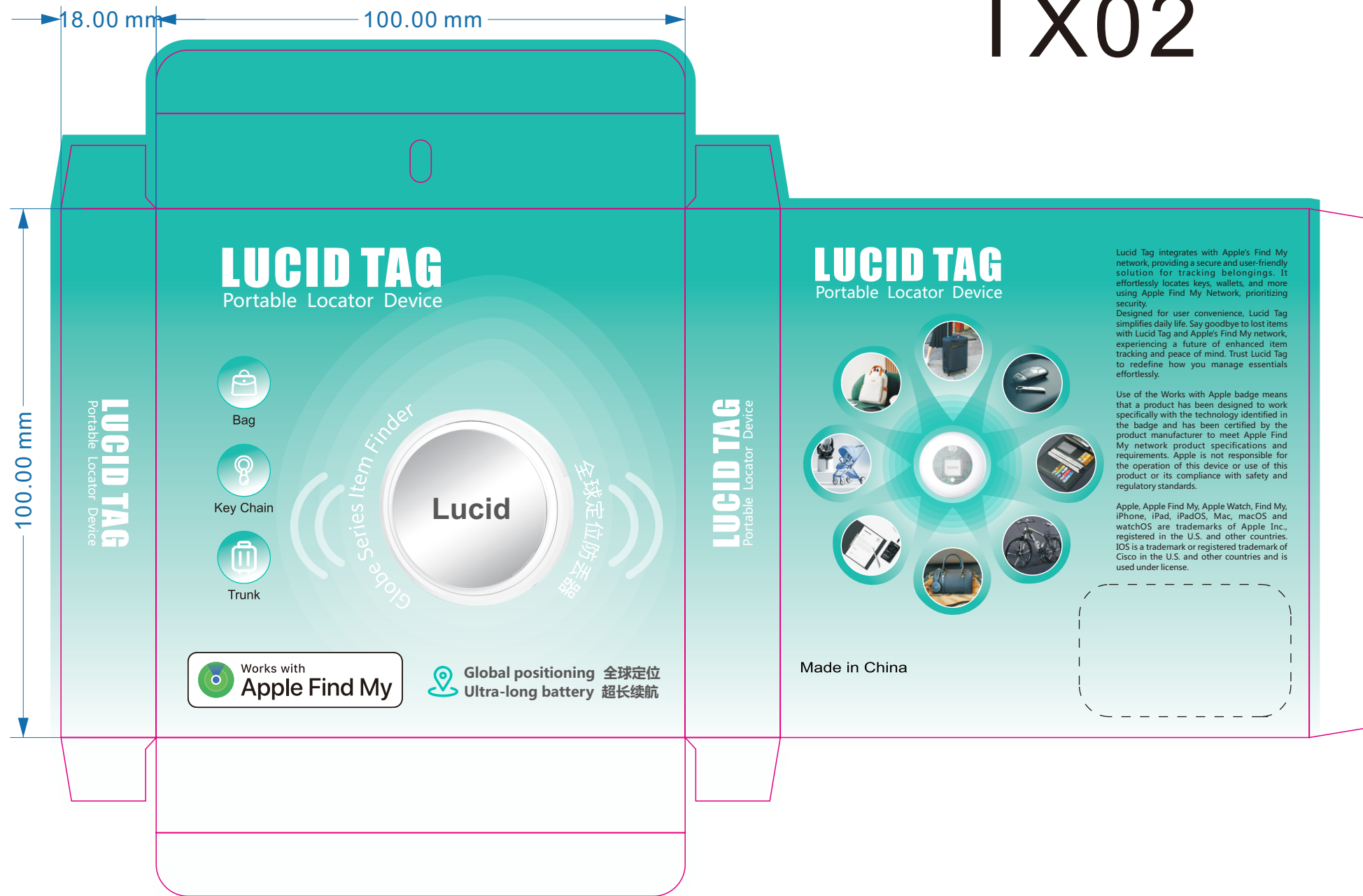

FCC Statement
Changes or modifications not expressly approved by the party responsible for compliance could void the user's authority to operate the equipment.
This equipment has been tested and found to comply with the limits for a Class B digital device, pursuant to Part 15 of the FCC Rules. These limits are designed to provide reasonable protection against harmful interference in a residential installation. This equipment generates uses and can radiate radio frequency energy and, if not installed and used in accordance with the instructions, may cause harmful interference to radio or television reception. However, there is no guarantee that interference will not occur in a particular installation. If this equipment does cause harmful interference to radio or television reception, which can be determined by turning the equipment off and on, the user is encouraged to try to correct the interference by one or more of the following measures:
-- Reorient or relocate the receiving antenna.
-- Increase the separation between the equipment and receiver.
-- Connect the equipment into an outlet on a circuit different from that to which the receiver is connected.
-- Consult the dealer or an experienced radio/TV technician for help.
This device complies with part 15 of the FCC rules. Operation is subject to the following two conditions (1) this device may not cause harmful interference, and (2) this device must accept any interference received, including interference that may cause undesired operation.
This equipment complies with FCC radiation exposure limits set forth for an uncontrolled environment.

<p>LUCID TAG 便携式防丢器</p> <p>Works with Apple Find My</p> <p>用户指南</p>	<p>概述 Lucid Tag 集成了苹果的Find My网络, 为查找物品提供了一个安全且友好的解决方案。使用Find My网络功能轻松定位钥匙、钱包等, 并优先考虑安全性。Lucid Tag 为方方便用户而设计, 简化了日常生活。用 Lucid Tag 和苹果的Find My网络告别丢失物品, 相信 Lucid Tag可以重新定义您轻松管理必需品。</p> <p>如何配对 注意:iOS或macOS的最新版本。</p> <p>1.1 将 Lucid Tag 放置在你的苹果设备(如iPhone)旁边。 1.2 在iPhone上开启蓝牙, 连接互联网。 1.3 轻按侧面按钮, 听到一声“哔”声开机。</p>	<p>1.4 打开“查找”应用 1.5 在“查找”应用程序中, 单击“添加物品-其他支持物品”。如图1所示 1.6 单击“继续”, 如图2所示 1.7 命名你的 Lucid Tag, 然后点击“继续”, 如图3所示 1.8 选择表情符号。 1.9 点击“继续”, 再点击“完成”即可。</p> <p>电池 Lucid Tag 包含一个硬币形状的电池。在产品使用寿命期间, 可能需要更换电池。通过观察正确的负极和正极连接, 只能更换相同型号(CR2032)和额定值的电池。</p> <p>电池更换: 2.1 拧开上盖。 2.2 更换新电池。 2.3 拧紧上盖。</p> <p>其他提示 3.1 从活动模式切换到禁用模式(飞行模式), 只需取出电池。</p>	<p>3.2 若要从禁用模式(飞行模式)切换到工作模式, 请重新安装电池。Lucid Tag 将在此之后成功配对。 3.3 长按该键, 听到1声提示音, 然后连续听到2声提示音, 然后连续听到3声提示音。继续按压5秒, 当听到长提示音时, 松开按钮, 设备恢复出厂设置。 3.4 要从你的苹果设备上删除 Lucid Tag, 打开“查找”应用程序, 选择“物品”, 找到设备, 然后向下滚动点击“移除此设备”。 3.5 如果 Lucid Tag 无法连接到“查找”应用程序, 请按3.3中的说明进行重置, 然后重新启动配对过程。</p> <p>重要事项 Lucid Tag 包含精密的电子部件, 包括电池。为避免损坏、功能丧失或潜在危害, 请避免跌落、撞击、刺穿、压碎、拆卸、暴露在高温或液体中, 或放置在工业化学品浓度高的地方。</p>	<p>警告: 请勿吞下电池; 存在化学灼伤危险</p> <p>窒息危险警告 Lucid Tag、电池舱门、电池本身和外壳可能会造成窒息危险或对幼儿造成伤害。请将物品放在幼儿接触不到的地方。</p> <p>医疗器械干扰 Lucid Tag 包含发射电磁场的组件和无线电。这些元件可能会干扰起搏器、除颤器或其他医疗设备。为确保安全, 请在您的医疗器械和 Lucid Tag 之间保持安全距离。我们强烈建议您咨询您的医生和医疗器械制造商, 以获取针对您具体情况。如果您怀疑 Lucid Tag 会干扰您的起搏器、除颤器或其他医疗设备, 请立即停止使用。</p> <p>重要处理指南 Lucid Tag 在经常使用时出现变色是正常的。要清洁它, 请使用柔软、干燥、无绒的布。避免应用尖锐物体压在橡胶密封圈或设备内部电池端子接触处。</p> <p>请勿让湿气进入任何开口, 或使用喷雾、溶剂或清洁磨料设备。</p>	<p>法律声明 使用带有Apple徽标的作品意味着该产品已被设计为专门用于徽标中所标识的技术配合使用, 并已通过产品制造商的认证, 以满足Apple Find My 网络产品规格和要求。Apple不对本设备的操作或本产品的使用或其是否符合安全和监管标准负责。</p> <p>Apple, Apple Find My, Apple Watch, Find My, iPhone, iPad, iPadOS, Mac, macOS和watchOS是苹果公司在美国和其他国家注册的商标。iOS是思科在美国和其他国家/地区的商标或注册商标, 并在许可下使用。</p>
---	--	--	--	--	--

<p>LUCID TAG Portable Locator Device</p> <p>Works with Apple Find My</p> <p>USER GUIDE</p>	<p>Overview Introduction Lucid Tag integrates with Apple's Find My network, providing a secure and user-friendly solution for tracking belongings. It effortlessly locates keys, wallets, and more using Apple Find My Network, prioritizing security. Designed for user convenience, Lucid Tag simplifies daily life. Say goodbye to lost items with Lucid Tag and Apple's Find My network, experiencing a future of enhanced item tracking and peace of mind. Trust Lucid Tag to redefine how you manage essentials effortlessly</p> <p>HOW TO PAIR Note: iOS or macOS with the latest version.</p> <p>1.1 Place the Lucid Tag next to your Apple device like iPhone. 1.2 Turn on Bluetooth on iPhone and connect to Internet. 1.3 Press the blunder side button, hear one beep to power on.</p>	<p>1.4 Open the 'Find My' app 1.5 In 'Find My' app, click on Add Item - Other Support Items. As shown in Figure 1 1.6 Click 'Continue'. As shown in Figure 2 1.7 Name your Finder and click 'Continue'. As shown in Figure 3 1.8 Select emoticons. 1.9 Click 'Continue', then click 'Finish' to complete.</p> <p>Battery Lucid Tag Contains a coin shaped battery. During the product's lifespan, it may be necessary to replace the battery. By observing the correct negative and positive connections, only replace batteries of the same type (CR2032) and rating.</p> <p>Battery replacement: 2.1 Twist to open the back cover. 2.2 Replace a new battery. 2.3 Twist to close the back cover.</p> <p>ADDITIONAL TIPS 3.1 To switch from active mode to Disable mode (Airplane mode), simply remove the battery.</p>	<p>3.2 To switch from Disable mode (Airplane mode) to working mode, reinstall the battery. The Lucid Tag will be successfully paired after this. 3.3 Press and hold the button until you hear 1 prompt tone, followed by 2 consecutive prompt tones, and then 3 consecutive indicator tones. Continue to press for 5 seconds. When you hear a long indicator tone, release the button to restore the device to its factory settings. 3.4 To remove the Lucid Tag from your Apple devices, open the Find My app, select 'items', find the device, and scroll down to click on 'Remove this device'. 3.5 If the Lucid Tag fails to connect to the Find My app, follow the instructions in section 3.3 to perform a factory reset, and then restart the pairing process.</p> <p>Important matters The Lucid Finder contains delicate electronic parts, including a battery. To avoid damage, loss of function, or potential harm, please refrain from dropping, hitting, puncturing, crushing, disassembling, exposing it to extreme heat or liquids, or placing it in areas with a high concentration of industrial chemicals.</p>	<p>WARNING: Do not swallow the battery; there is a chemical burn hazard</p> <p>Choking Hazard Warning The Lucid Tag, its battery compartment door, the battery itself, and the case may pose a choking hazard or cause injury to small children. Please keep these items out of reach of young children</p> <p>Medical Device Interference The Lucid Tag contains components and radios that emit electromagnetic fields, as well as magnets. These elements may potentially interfere with pacemakers, defibrillators, or other medical devices. To ensure safety, maintain a safe distance between your medical device and the Lucid Tag. We strongly advise consulting your physician and the manufacturer of your medical device for information that is specific to your situation. If you suspect that the Lucid Tag is interfering with your pacemaker, defibrillator, or any other medical device, discontinue its use immediately.</p> <p>Important Handling Guidelines It's normal for the Lucid Tag to show discoloration with regular use. To clean it, use a soft, dry, lint-free cloth. Avoid applying</p>	<p>FCC Statement Changes or modifications not expressly approved by the party responsible for compliance could void the user's authority to operate the equipment. This equipment has been tested and found to comply with the limits for a Class B digital device, pursuant to Part 15 of the FCC Rules. These limits are designed to provide reasonable protection against harmful interference in a residential installation. This equipment generates uses and can radiate radio frequency energy and, if not installed and used in accordance with the instructions, may cause harmful interference to radio or television reception. However, there is no guarantee that interference will not occur in a particular installation. If this equipment does cause harmful interference to radio or television reception, which can be determined by turning the equipment off and on, the user is encouraged to try to correct the interference by one or more of the following measures: -- Reorient or relocate the receiving antenna. -- Increase the separation between the equipment and receiver. -- Connect the equipment into an outlet on a circuit different from that to which the receiver is connected. -- Consult the dealer or an experienced radio/TV technician for help. This device complies with part 15 of the FCC rules. Operation is subject to the following two conditions (1) this device may not cause harmful interference, and (2) this device must accept any interference received, including interference that may cause undesired operation. This equipment complies with FCC radiation exposure limits set forth for an uncontrolled environment.</p>
--	--	---	---	--	--