

S8 Pro Max

Nothing but amazing bass.

Quick Start Guide

快速开始指南

S8 Pro Max

TOUCH KEY / 面板说明



Short press to switch sound effects
Long press on/off
短按切换音效
长按开/关机



Short press to switch audio source
Long press TWS pairing
短按切换音源
长按TWS配对



Devpat Audio Indicator Light
音效指示灯



Short press play/pause answer
Long press to reject, double click to disconnect
短按播放/暂停接听
长按拒接、双击断开



Short press to adjust volume
Long press to switch up and down tracks
短按调节音量
长按切换上下曲

Red : Treble Audio
Green: Bass Audio
Blue : 3D Audio
红色灯: 人声音效
绿色灯: 低音音效
蓝色灯: 环绕音效

S8 Pro Max

BUTTON / 按钮

CHARGING / 充电

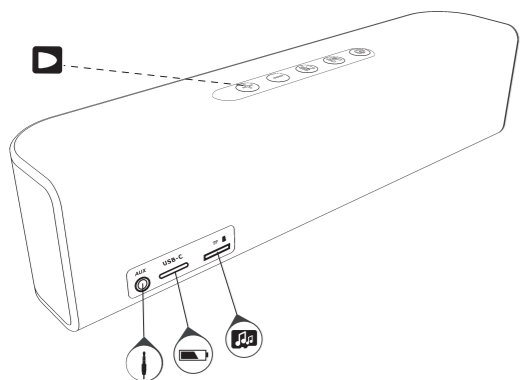

外置音频输入
AUX
USB Type-C 充电口
USB Type-C Charge Port

集成MP3/WMA/WAV/FLAC/APE播放器
Play MP3/WMA/WAV/FLAC/APE music files from Micro SD card

三种Devpat Audio 音效切换指示灯
Devpat Audio Indicator Light



USB Audio
Turn on the S8 Pro Max, and connect the Type-C cable attached to the USB interface of the PC. And then there will be "USB speaker" prompt tone. Make sure connect the cable after turn on the S8 Pro Max, or it will prompt "USB mass storage".
Charge: The red LED will be on when charging and once fully charged the red LED turns off. It takes about 3-4 hours to fully charge.
支持USB音频功能
音箱开机后, 通过Type-C线连接电脑和音箱, 发出USB Speaker 提示音, 表示连接成功。注: 音箱开机前插入Type-C线, 会有USB mass storage提示音, 重新插入Type-C线即可。
充电: 充电时红灯长亮, 充满电红灯熄灭。充满电需约3-4小时。

FCC Warning

15.19 Labeling requirements.

This device complies with part 15 of the FCC Rules. Operation is subject to the following two conditions: (1) This device may not cause harmful interference, and (2) this device must accept any interference received, including interference that may cause undesired operation.

15.21 Information to user.

Any Changes or modifications not expressly approved by the party responsible for compliance could void the user's authority to operate the equipment.

15.105 Information to the user.

Note: This equipment has been tested and found to comply with the limits for a Class B digital device, pursuant to part 15 of the FCC Rules. These limits are designed to provide reasonable protection against harmful interference in a residential installation. This equipment generates uses and can radiate radio frequency energy and, if not installed and used in accordance with the instructions, may cause harmful interference to radio communications. However, there is no guarantee that interference will not occur in a particular installation. If this equipment does cause harmful interference to radio or television

BT Connection / 蓝牙连接

Activate the BT settings on your smart phone or other devices, then search and connect the speaker S8 Pro Max. Enter "0000" if a password is needed. The speaker will automatically turn off if no audio input for 30 minutes.
请打开智能手机等设备上的蓝牙设置, 连接至音箱。要求输入密码时, 请输入"0000"。
注: 30分钟无音源输入,S8 Pro Max会自动关机。

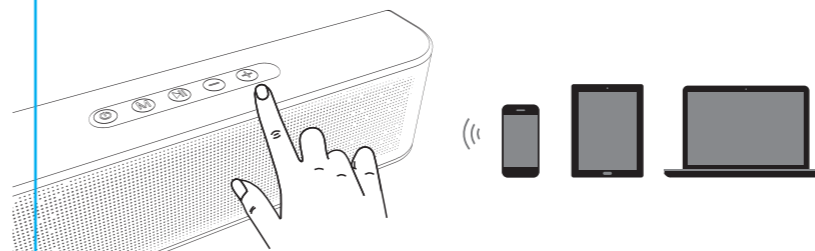

WIRED CONNECTION / 有线连接

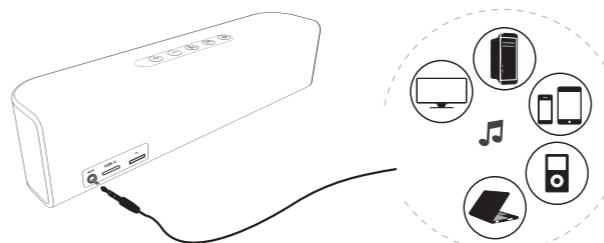

手机, 电脑或者电视均有AUX 音频输出接口, 请把随机附赠的3.5mm音频线两端分别插入音频输出设备和音箱。
Connect the 3.5mm audio cable attached to the aux interface of devices, such as mobile phone, PC or TV.

Warranty / 质保条款

The Warranty Information:

- If a malfunction or a damage occurs due to quality issues, please take the product to sales agency. Since the date of purchase, the warranty is valid for 1 year.
- Damages due to unauthorized disassembly or inappropriate usage of the users not under warranty.
- For your interest, keep this card without altering.

质保条款

本设备提供自购买之日起1年的有限产品硬件保修服务。

质保限制

本有限质保不涵盖由于以下原因导致的问题或损坏:

- 意外事件、误用、操作不当或任何未授权的维修、改装或者拆卸;
- 操作或维护不当, 适用过程中违反产品说明或连接到不适当的电压源;



合格证

DEVPAT

True Wireless Stereo/ 真实无线立体声

真实无线立体声模式连接步骤

- 关闭手机蓝牙, 开启两台S8 Pro Max;
- 长按其中一台的M切换键, 听到提示音后音效灯由闪烁变成常亮, 说明已进入TWS配对模式;
- 打开手机蓝牙并连接S8 Pro Max, 播放音乐即可体验左右声道无线分离的家庭影院效果。
注: 二次开启两台S8 Pro Max时, 会自动进入TWS模式。配对成功后, 再次长按一台M切换键, 即可取消TWS模式。

Operation steps of True Wireless Stereo

- Turn off the BT function of phone, and then turn on the two sets of S8 Pro Max.
- Long press the M switch button of any one set quickly, prompt tone will be emitted and the audio indicator light flashes and then will be normally on when the two sets of S8 Pro Max enter the TWS mode.
- Initiate BT function of phone, and connect the S8 Pro Max. Enjoy the true stereo effect which the left & right channels are independently.

Mark: The speakers will automatically enter the TWS mode when they are turned on again. And it will be out of the TWS mode when long press the M switch button again.

技术规格与注意事项

技术规格:

- 5.3版本蓝牙音频传输播放
- AUX音频输入
- MicroSD卡播放支持APE/FLAC格式
- USB AUDIO 数字音频输入
- Type-C5V3A充电(支持20W快充9V2A、12V1.5A)
- 支持TWS联机播放立体声
- 喇叭单元5单元
- 中低频20Wx2+高频10Wx2+低频被动震膜器2.0分频
- 音效模式: 人声、重低音、3D环绕
- 尺寸: 270x55x64mm
- 净重: 1.2KG

- 请将本产品放置于干燥通风处, 避免雨淋、进水、高温或置于强磁场环境, 严禁强力摔打。
- 请勿放置在任何热源附近, 例如散热器、暖气、火炉或其他发热设备。
- 请使用干布擦拭表面, 请勿使用挥发性液体或其他有机溶液。
- 切勿将本产品暴露在温度过高或过低的地方。
- 切勿让本产品长时间受阳光直射照射。
- 切勿将本产品靠近明火, 如煮食炉。
- 切勿将本产品接触任何尖锐的物体, 因为这会造成划痕和损毁。
- 切勿尝试拆开本产品, 因为它并不包含任何维修组件。

保修期	一年	日期	维护状态
购买日期			
购买地址			
产品型号			
购买渠道	电商		

Important Notice:
In order to safeguard your legal rights and interests, please fill out clearly, avoid alternation and keep the warranty card safely. Please contact local supplier or manufacturer for any inquiries.

reception, which can be determined by turning the equipment off and on, the user is encouraged to try to correct the interference by one or more of the following measures:

- Reorient or relocate the receiving antenna.
- Increase the separation between the equipment and receiver.
- Connect the equipment into an outlet on a circuit different from that to which the receiver is connected.
- Consult the dealer or an experienced radio/TV technician for help.

FCC RF Radiation Exposure Statement:

- This Transmitter must not be co-located or operating in conjunction with any other antenna or transmitter.
- This equipment complies with RF radiation exposure limits set forth for an uncontrolled environment.

This equipment should be installed and operated with minimum distance 5mm between the radiator and your body.