

Baseus Power Bank User Manual

Manualsum, simplified manuals

Table of Contents

- [Baseus Power Bank User Manual](#)
 - [Specifications](#)
 - [Content](#)
 - [Overview](#)
 - [Description](#)
 - [Warnings](#)
 - [Attention](#)
 - [Operating Environment](#)
 - [Caution](#)
 - [Wireless Charging Warnings](#)

Baseus Power Bank User Manual

Baseus Power Bank User Manual

([2A482-PPCXM10TB](#))

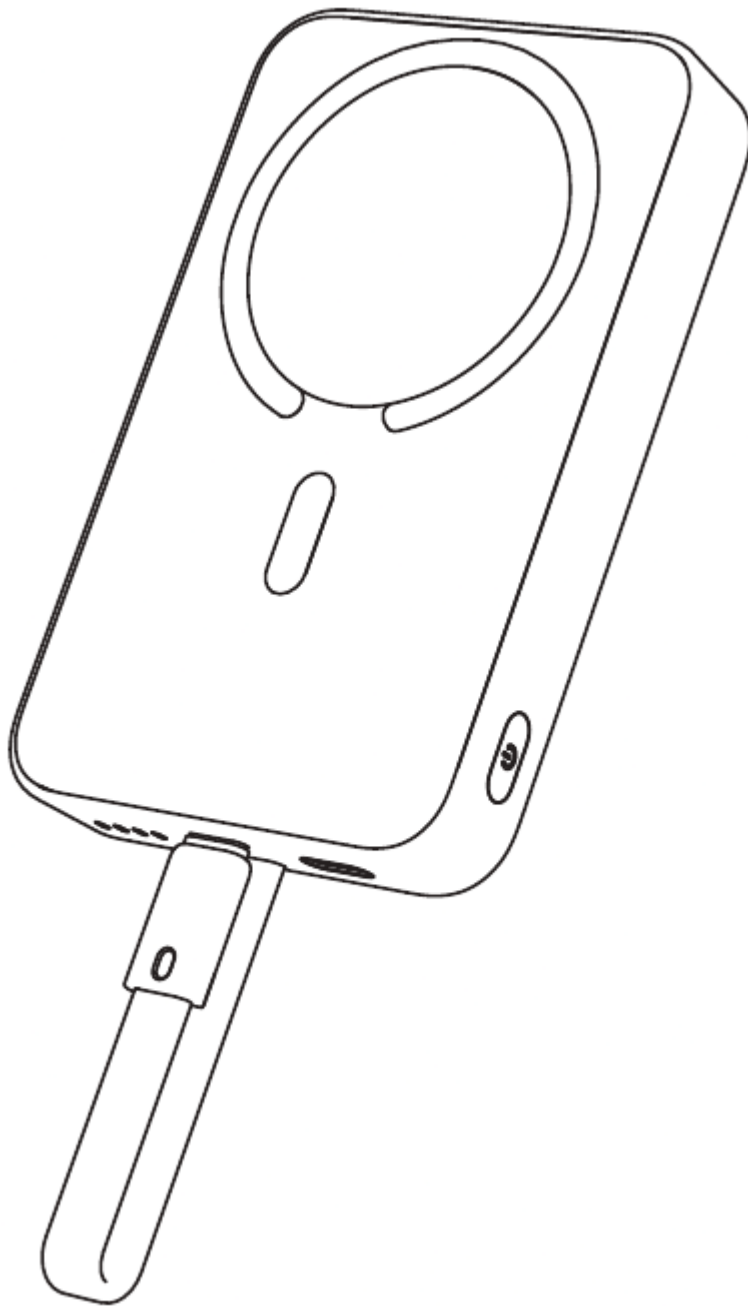

Specifications

- **Name:** Power Bank
- **Model No.:** PPCXML0T
- **Battery:** Polymer Lithium Battery
- **Capacity:** 5000mAh 7.4V/37TWh
- **Cell:** 5000mAN*2pcs
- **Energy Conversion Rate:** >75%
- **Type-C Input:** 5V~3A; 9V~2A; 12V~1.5A
- **Type-C Cable Input:** 5V-3A; 9V-2A; 12V~1.5A
- **Type-C Output:** 5-3A; 9V=3A;12V-2.5A,15V-2A
- **Type-C Cable Output:** 5V-3A; V=3A; 12V=2.5A; 15V~2A
- **Wireless Output:** SW/7.5W/10W/15W
- **Type-C +Type-C Cable Output:** 5V-3A

- **Total Output:** 5V-3A
- **Size:** 108.7X69X 20mm
- **Net Weight:** ~216g

Content

- Power bank X 1
- User manual X 1
- Warranty card X 1

Overview

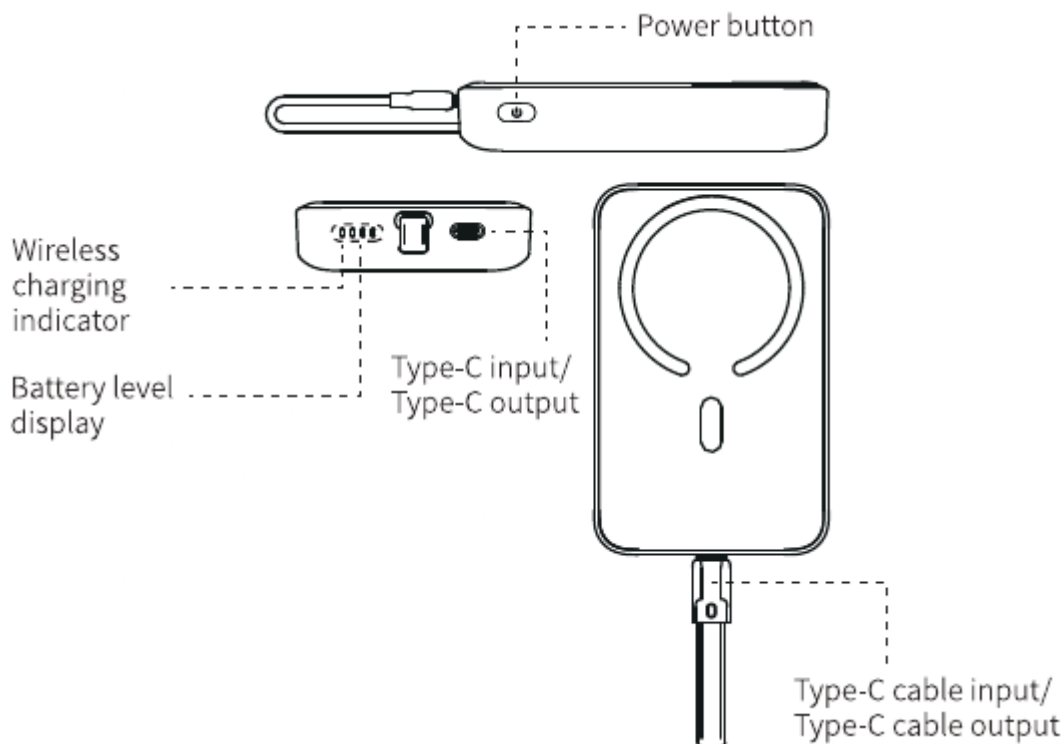

Description

This product is a mini-sized portable power bank with built-in 30W fast charging cable. The Type-C port is multi-protocol certified and supports two-way fast charging. It has multiple built-in safety protection circuits for overcurrent, overvoltage, short circuit, etc.

Warnings

1. This is NOT a toy! Please place this product in areas that are not easily accessible by children. Do not allow children to operate this product, or accidents may occur.
2. Please charge this product with a charger approved by the local safety standards in case of danger or damage.
3. DO NOT apply pressure, and avoid collisions. The battery and circuit may be damaged if this product falls from a great height, experience [Mencasum](#)

intense shocks, or is immersed in liquid; if so, please avoid using this product

4. If this product suffers from deformation, leakage, or radical decline in performance, please stop using this product
5. Please DO NOT charge any device or recharge this product in places that may affect its heat dissipation, such as pants pockets, enclosed bags, beds, or couches. And ensure this products not under any cover when operating, When charging other devices for prolonged periods, DO NOT stack any device on top of this product, or it might affect its heat dissipation.
6. This product CAN NOT be disassembled, applied pressure, pierced, short-circuited, immersed in liquid, disposed of in a fire, or exposed to a high temperature or heat source with a temperature greater than 140°F (60°C).
7. DO NOT place this product in areas with extremely high temperatures. Such as under direct sunlight or in a vehicle with a very high interior temperature.
8. This product contains lithium batteries, DO NOT disassemble it! Or danger or battery damage may occur.

Attention

Please fully charge this device before using it for the first time.

The power banks have conversion efficiency, so the battery capacity of power bank is not equal to the rechargeable capacity.

Please choose an appropriate charger for recharging this product and suitable cables when charging other devices.

Please ensure some supervision is in progress when recharging this product, DO NOT charge this product without any care,

Please remove the cable when done recharging this product or finished charging for any othe device to preserve the product integrity.

If the indication does not light up after pressing the power button, please recharge this product

Please preserve this product with a battery percentage between 25%-50% for long-term storage. Place this product in a cool and dry environment. To slow down battery aging, avoid storing this product in an empty or full charge for long-term storage.

Consumer shall be liable for any personal and property damage resulted from their improper use against the user manual or ignoring the warning, to which our company will not bear any legal liability.

Operating Environment

Working temperature: non-tropical areas, 0°C to 30 °C

[Manualsum](#)

Storage temperature: 0°C to 40 °C

Caution

1. This product does not contain any user-serviceable parts, and the rechargeable battery is not replaceable.
2. Putting the battery pack into fire or heating in an oven, as well as subjecting the battery pack to mechanical squeezing or cutting, may result in explosion.
3. Placing the battery pack in an extremely high-temperature environment may cause explosion or leakage of flammable liquids or gases,
4. Subjecting the battery pack to extremely low air pressure may cause explosion or leakage of flammable liquids or gases.

Wireless Charging Warnings

This product utilizes magnetic and capacitive coupling mechanisms to achieve non-beamforming near-field power transmission from the power source to the load. The device complies with relevant regulations such as the “Interim Provisions on Radio Management for Wireless Charging (Power Transmission) Devices,” as well as laws and regulations concerning product quality, electromagnetic radiation, electrical safety, and national standards.

It is not allowed to change the usage scenarios or conditions, expand the operating frequency range, or increase the transmission power (including adding additional power amplifiers) without permission.

It is not allowed to cause harmful interference to other legal wireless services and stations. Users cannot request protection against radio interference or radiation interference. If harmful interference to other legal wireless services and stations occurs, immediate use must be stopped, and it can only be resumed after taking measures to eliminate the harmful interference.

Wireless charging devices are prohibited in this area, The use of wireless charging function is not allowed.

If the use of wireless charging devices is causing interference to broadcast services, it should be immediately discontinued

The use of wireless charging devices in ships, aircraft, and railway locomotives (including high-speed train units) should comply with this regulation and the relevant regulations of the industry authority

Statement on Toxic and Hazardous Substances in Electronic Information Products

Part Description	Toxic or hazardous substances and elements 					
	Lead (pb)	Mercury (Hg)	Cadmium (Cd)	Hexavalent chromium (Cr VI)	Polybrominated biphenyls (PBB)	Polybrominated diphenyl ethers (PBDE)
PCB	X	○	○	○	○	○
Plastic	○	○	○	○	○	○
Metal	X	○	○	○	○	○
Accessory	○	○	○	○	○	○

This form is compiled in accordance with SJ/T 11364.2

O: It indicates that the content of the toxic and harmful substance in all homogeneous materials of the component is below the limit specified in GB/T 26572 standard

X: The content of toxic and harmful substances in at least one homogeneous material of this part exceeds the limit stipulated in GB/T 26572 standard.

The 5-year icon refers to the “valid environment-friendly use period, not the product quality assurance period. Electronic products contain toxic and harmful substances such as lead, mercury and cadmium. The overdue use of these products may lead to leakage of mutation of these toxic and harmful substances, cause environment pollution or serious damage to people and property. The term of “environment-friendly use period” means that all electronic products shall be used within this validity period. We are free of any responsibility against safety issues caused by using the product beyond its safe service [fe



This symbol indicates that this product shall not be treated as “household waste. Instead, it shall be handed over to the applicable collection point for the recycling of electrical and electronic equipment. Follow local rules and never dispose of the product or batteries with regular household waste



Baseus Power Bank User Manual