

Shenzhen Cheluzhe technology CarplayBOX User Manual

Manualsum, simplified manuals

Table of Contents

- [Shenzhen Cheluzhe technology CarplayBOX User Manual](#)
 - [Introduction](#)
 - [Product description](#)
 - [CarplayBOX connection](#)
 - [wifi connectivity](#)
 - [SD card media playback](#)
 - [Wireless Carplay connection \(box to cell phone\)](#)
 - [Wireless Auto Connection \(box to cell phone\)](#)
 - [System upgrade](#)
 - [Common trouble shooting](#)
 - [Product list](#)

Shenzhen Cheluzhe technology CarplayBOX User Manual

Shenzhen Cheluzhe technology CarplayBOX User Manual

Shenzhen Cheluzhe technology Dual WiFi three-in-one closed small system
User Manual

FCC id: [2A4LQ-SH01-A](#)

Please read this instruction manual carefully

Introduction

Welcome to choose our CarplayBOX! In order for you to use this machine correctly, please read the manual of this machine carefully before using it. We are dedicated to provide you with better products and services!

[Manualsum](#)

Product description



CarplayBOX connection

Reminder: This system only supports the original car models with wired Carplay!

Insert the USB cable at the USB interface of the car, and insert the other end of the USB cable at the bottom of the CarplayBOX. At this time, the indicator light is flashing, and the connection will be successful within 1 minute! (the indicator light is always on)The first connection needs to be adapted to the car central control device and resolution. CarplayBOX will restart automatically, which is a normal phenomenon.

[Manualsum](#)

wifi connectivity

Go to your machine settings-open a wifi connection-find the wifi you want to connect to and enter your password for the connection

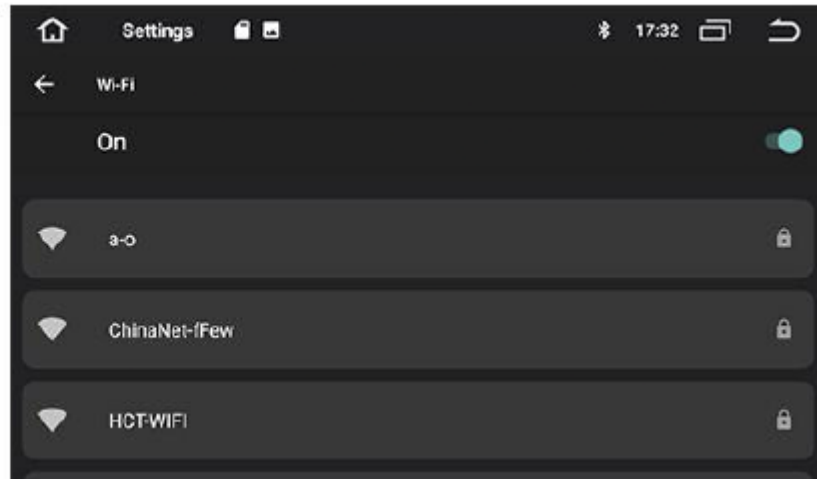

SD card media playback

Insert SD card can play music, pictures, video

Music playing

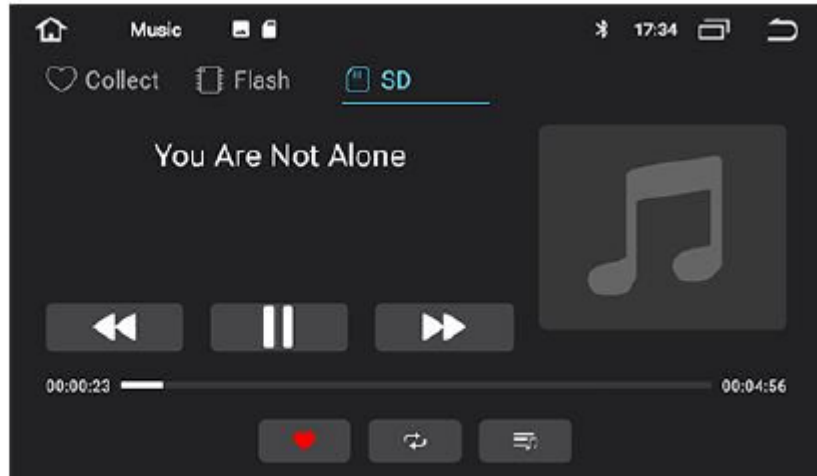

Wireless Carplay connection (box to cell phone)

1. Connect to the iPhone's Bluetooth connection, and the success of the Bluetooth connection will pop up the notification window, click on "Use Carplay" (the Bluetooth connection will automatically disconnect after success, the phone wifi will automatically keep connected to the car's central control device hot)

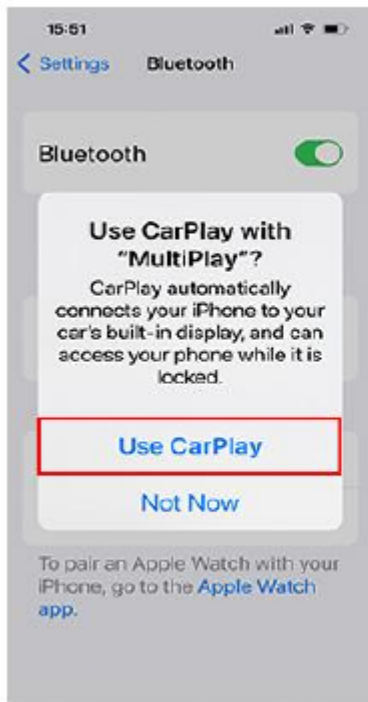

Wireless Carplay successfully connects to the interface

Note: If you want to use the original car screen Bluetooth, you need to disconnect the wireless Carplay first

Wireless Auto Connection (box to cell phone)

Connect the Bluetooth of Android mobile phone, use wireless AUTO after successful connection

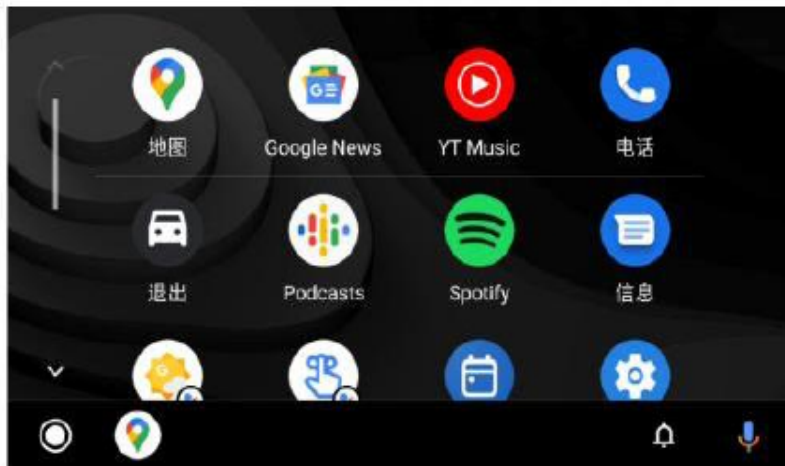

Wireless AUTO successfully connects to the interface

System upgrade

Place the update package (update.zip) in the SD Kaghan Directory, insert it into the card slot, and pop up the update confirmation box (make sure you check the box to clear the upgrade option) . Click OK and the product will be upgraded automatically. The upgrade will restart after it is successful

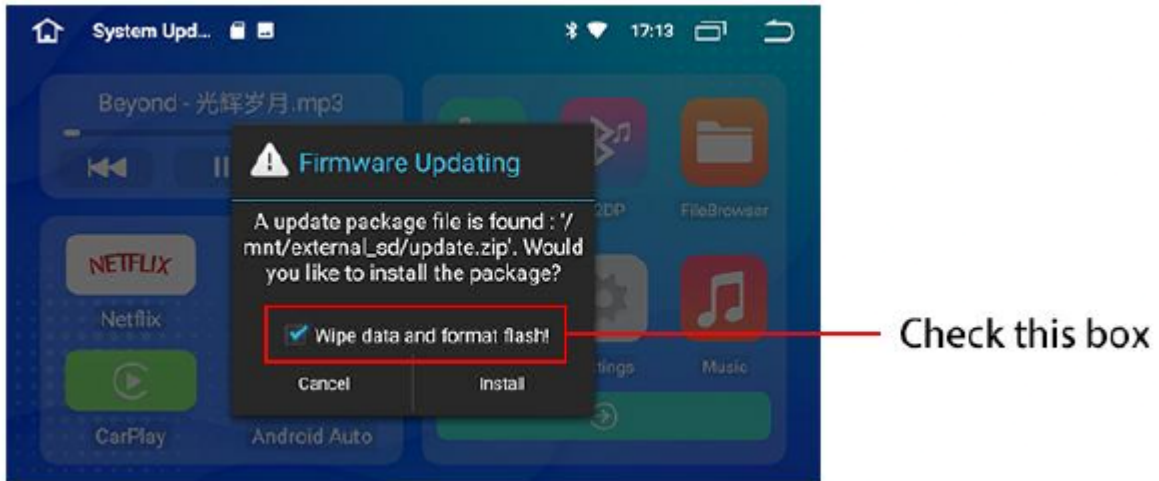

Common trouble shooting

1. The car cannot be connected after starting: please re-plug and unplug the box to connect again.
2. There are abnormal phenomena such as crash: please press the reset button RESET.
3. The wireless Carplay cannot be connected: Please check whether the Bluetooth of the mobile phone is turned on.
4. The SD card is not recognized: Please check whether the SD card is damaged, please re-insert the card or format or replace it with a new card.
5. 4G network cannot be used: Please check whether the SIM card still has data.
6. The box cannot be connected: Please clear the connection record of the central control device of the car.

Product list



Carplay box



Type-c data line