

# **BT12C helmet Bluetooth headset User Manual**

## **Manualsum, simplified manuals**

### Table of Contents

- [BT12C helmet Bluetooth headset User Manual](#)
  - [Product Introduction](#)
  - [Power ON/OFF](#)
  - [How to Switch Between Chinese and English Voice](#)
  - [Connect Two Mobile Phones At The Same Time](#)
  - [How to connect with mobile phone](#)
  - [Volume up/down/song switching](#)
  - [Answer the phone](#)
  - [Product charging](#)
  - [Product parameters](#)
  - [How to activate Siri function of mobile phone](#)
  - [Switch between automatic answering and non-automatic answering](#)
  - [Package content](#)
  - [Equipment appearance and function introduction:](#)
  - [Installation instructions for helmets with thin edges:](#)
  - [Applicable to the following helmets](#)
  - [Applicable to the following Bluetooth devices](#)
  - [Precautions for use of helmet Bluetooth headset](#)

# **BT12C helmet Bluetooth headset User Manual**

BT12C helmet Bluetooth headset User Manual

Shenzhen Jiayouda Electronics Helmet Bluetooth headset User Manual

FCC id: [2BFL4-BT12C](#)





Welcome to use this helmet Bluetooth headset. | hope you can read this manual carefully to make it easier to operate and install.

## Product Introduction

This product uses the latest 5.3 Bluetooth chip, uses the latest Bluetooth technology, stereo and strong. Ultra-strong signal transmission, ultra-low power consumption, and support for all Bluetooth devices, the automatic answering function of incoming calls, no longer need to answer calls manually, safe and fast. Use 40MM strong magnetic high-quality speaker.

## Power ON/OFF

Press the telephone symbol key “” Two to three seconds and the machine can be started. At this time, the indicator light will flash alternately red and blue, and the machine is in the starting state. Press the phone

symbol key to turn off “” Two to three seconds later, if it can be turned off, there will be a prompt tone, and the light will not light up after turning off.

## **How to Switch Between Chinese and English Voice**

After power-on, the indicator light flashes red and blue alternately. At this time, do not connect with the mobile phone, and When you call, there will be a mobile phone number broadcast. You can answer the call automatically

after broadcast or press the “” to answer the call manually.

## **Connect Two Mobile Phones At The Same Time**

After the Bluetooth headset is turned on, connect with the mobile phone A first, then turn off the Bluetooth of the mobile phone A, and then turn on the Bluetooth of the mobile phone A, and then connect two mobile phones at the same time.

## **How to connect with mobile phone**

After power-on, the indicator light flashes red and blue alternately. At this time, turn on the Bluetooth device on the mobile phone, search for the Bluetooth device on the mobile phone, find the “BT12C” point and connect it after a few seconds. Connected successfully. Once connected, the next time you use it, the phone Bluetooth and Bluetooth headset will be automatically connected when both are turned on.

## **Volume up/down/song switching**

Long press the “+” and “-“button to adjust the volum, Click the” +” or “-“ button to switch songs

## **Answer the phone**

When you call, there will be a mobile phone number broadcast, and then you can answer the call automatically, or you can press the telephone

symbol key “” Answer the call manually.

## **Product charging**

The low power of the product will give a voice prompt for charging. It can be fully charged for 3-4 hours. The red light will be on when charging, and the red light will be off when fully charged.

## Product parameters

1. **Bluetooth version:** V5.3+EDR
2. **Frequency range:** 2.4026GHz - 2.480GHz
3. **Transmission distance:** above 10M
4. **MIC distance:** £ Tm
5. **Lithium battery:** 3.7V/1000 mAh
6. **Charging time:** 3-4 hours
7. **Standby time:** about 240 hours
8. **Continuous working time:** about 15-20 hours
9. **Bluetooth name:** BT12C

## How to activate Siri function of mobile phone

Press the minus key “\_” twice in succession to activate the Siri function.

## Switch between automatic answering and non-automatic answering

Press the minus button “+” quickly and continuously twice to switch between automatic answering and non-automatic answering

## Package content

1. A helmet Bluetooth headset.
2. One charging cable.
3. A manual.
4. Two spare surgical stickers.
5. One spare cotton.

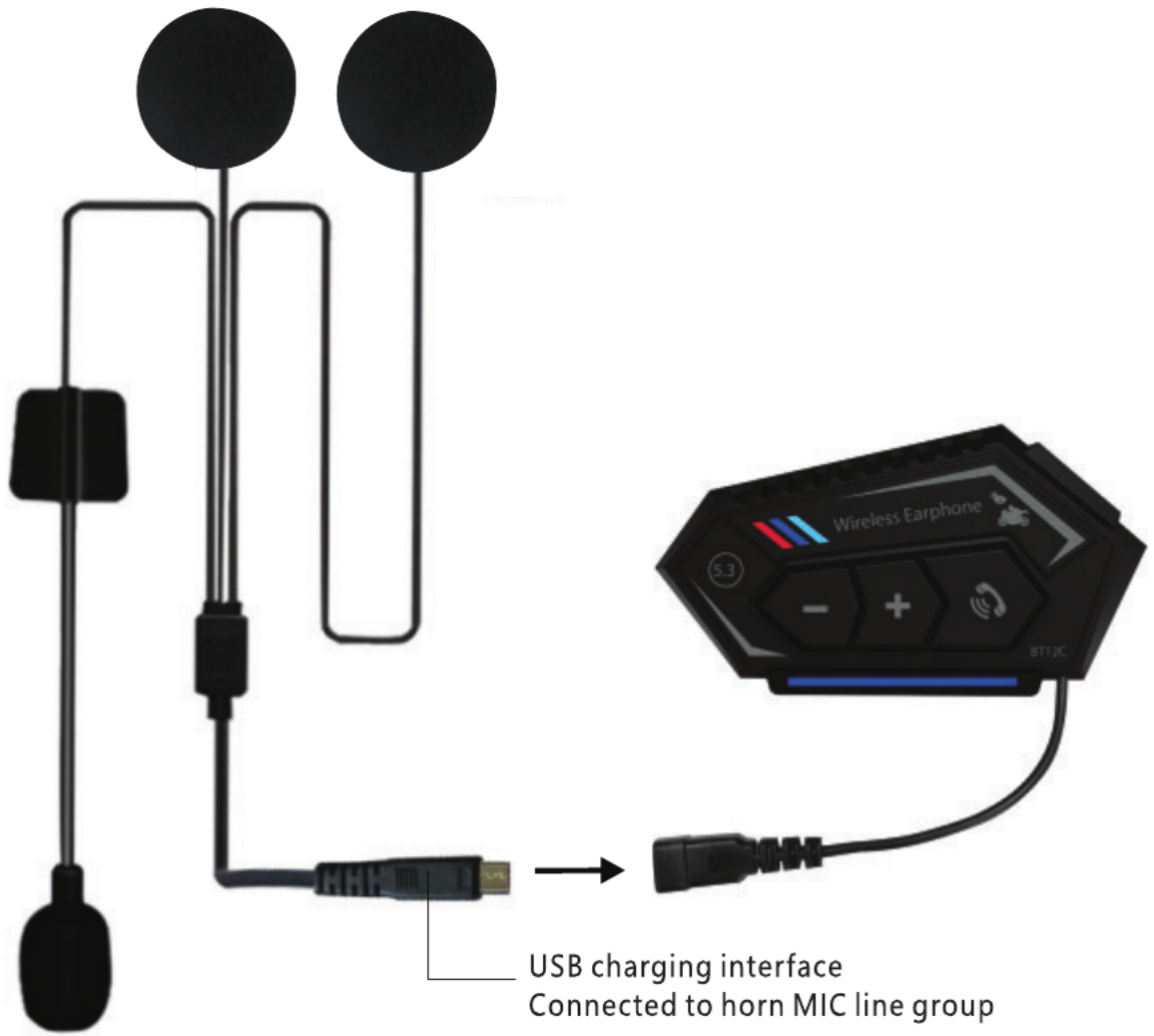

# Equipment appearance and function introduction:

Volume down one song  
Press twice in succession to activate voice on the phone Assistant (siri) function

Switch on/off/answer the phone/play pause

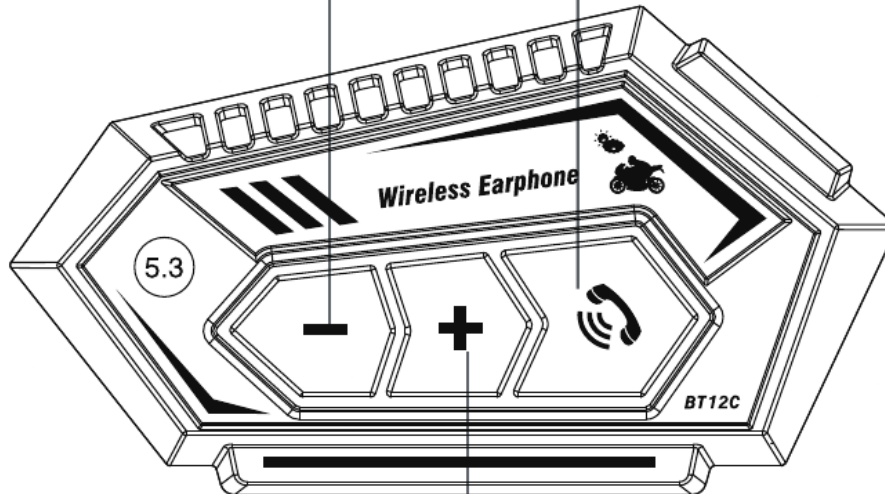

Volume up next song  
Quickly press twice in succession to switch between automatic answering and non-automatic answering

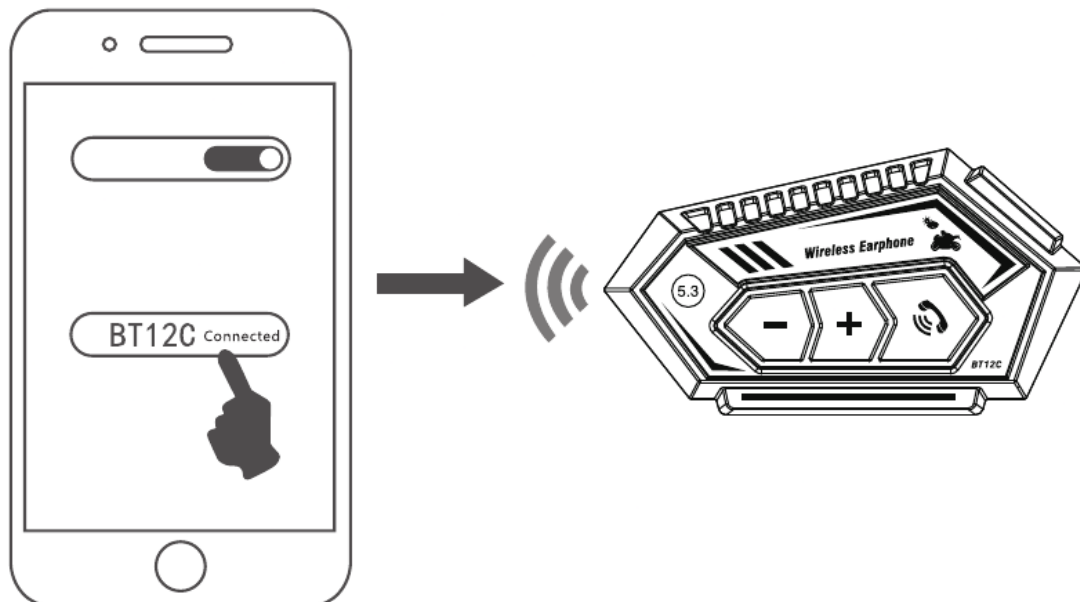

## Installation instructions for helmets with thin edges:

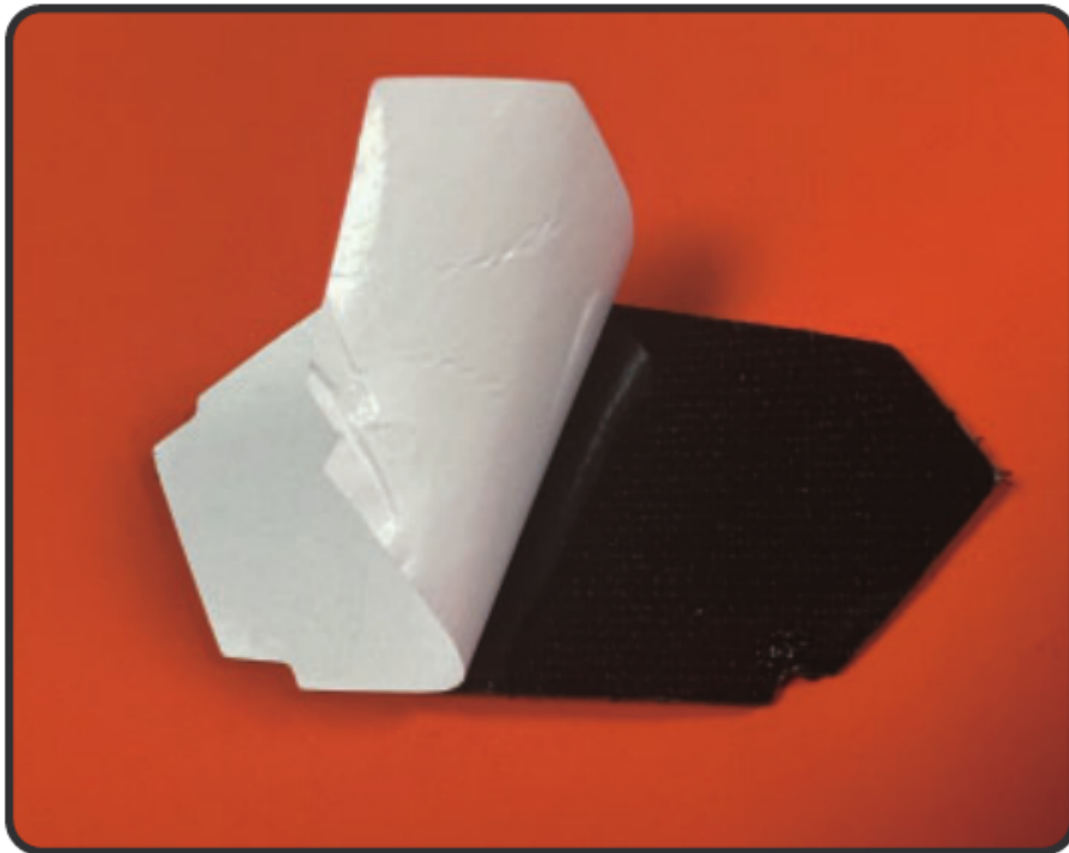

Tick the velcro and remove the white release paper.



Stick to the position where the helmet is to be installed





installation diagram



Installation rendering



**Installation of left horn:**

Spare fur round magicPaste and tear the white release paper [Manualsum](#)



The spare hairy round velcro is torn off the white release paper and pasted on the ear space of the helmet.



See the left figure for installation.

The horn is close to the ear, and the microphone rod is installed at a suitable position.



Installation of right horn:

Spare wool round velcro tape, tear off white release paper



The spare round velcro with rough surface can tear off the white release paper, and the horn can be pasted on the right position.

[Manualsum](#)



The left and right horn connecting wires are hidden in the interior.

## **Applicable to the following helmets**



Cross-country helmet



Barefaced helmet



Half helmet



Full helmet

## Applicable to the following Bluetooth devices



### Precautions for use of helmet Bluetooth headset

1. In order to protect your eardrum and hearing, do not turn the volume to the maximum.
2. Don't listen to music continuously for a long time.
3. Try to avoid collision.
4. Dust prevention, fire prevention and moisture prevention.
5. Remember to fully charge before using when going out.