

# Peicheng Technology P12 Tablet PC User Manual

## Manualsum, simplified manuals

### Table of Contents

- [Peicheng Technology P12 Tablet PC User Manual](#)
  - [SPECIFICATION](#)
  - [FUNCTION OVERVIEW](#)
    - [Battery](#)
    - [Sleep Mode](#)
    - [Screenshot](#)
  - [HOME SCREEN](#)
    - [Icons on the Bottom Menu](#)
    - [Home Settings and Wallpapers](#)
  - [SETTING BASICS](#)
    - [Quick Settings](#)
    - [More Settings](#)
    - [Network & internet](#)
    - [Apps](#)
    - [Notifications](#)
    - [Battery](#)
    - [Storage](#)
    - [Sound](#)
    - [Display](#)
    - [Wallpaper](#)
    - [Accessibility](#)
    - [Security](#)
    - [Privacy](#)
    - [Location](#)
    - [Passwords & accounts](#)
    - [Digital Wellbeing & parental controls](#)
    - [Google](#)
    - [System](#)
    - [About tablet](#)
  - [NETWORK CONNECTION](#)
    - [Wifi Connection](#)
  - [APP MANAGEMENT](#)
    - [App Download and Installation](#)
    - [App Management](#)
      - [Move the App](#)

- [Remove the App from the Home screen](#)
- [Uninstall the App](#)
- [Clear the Cache of the App](#)
- [INTERNET NAVIGATION](#)
- [MULTIMEDIA](#)
  - [Connecting to a Computer](#)
  - [Connecting to an External Device](#)
- [TROUBLESHOOTING](#)

# Peicheng Technology P12 Tablet PC User Manual

Peicheng Technology P12 Tablet PC User Manual

Shenzhen Peicheng Technology P12 Tablet PC User Manual

[2BE3V-P12](#)



# PEICHENG

Please read this manual thoroughly before using and keep it for future reference.

## SPECIFICATION

<b>Size</b>	10.95"	Connection	Connection Wifi
<b>Chipset</b>	T1606	CPU	Octa core 1.6GHz
<b>GPU</b>	ARM G57	RAM	4+12GB
<b>Display/Resolution</b>	1280*800	Storage	128GB
<b>Front-facing Camera</b>	5.0Mp	Network	802.11 b/g/n
<b>Rear Camera</b>	13.0QMP	Power Supply	DC 5V/2A
<b>Battery</b>	8000mAh	Touch	Multi-touch
<b>Operating System</b>	Android™ 14.0	Ports	Type-C

## FUNCTION OVERVIEW



1. USB-C Port
2. Memory Card Slot

3. Volume +
4. Volume -
5. Flash lamp
6. Microphone
7. Front-facing Camera
8. Speakers
9. Rear Camera
10. Power On/Off

\* Google, Android, Google Play and other marks are trademarks of Google LLC.

## **Battery**

- A rechargeable Li-ion battery is installed in the tablet.
- DO NOT attempt to replace the tablet battery by yourself because you may damage the battery, which might cause overheating, fire or injury.
- DO NOT dispose of tablet in a fire.
- DO NOT expose the tablet battery to any heat source, direct sunlight or high temperature.
- Only use the ORIGINAL power adapter provided by us to charge the tablet battery.
- We suggest you drain the battery completely once a month if only use your tablet occasionally.
- The Li-ion battery in your tablet should be serviced or recycled by an authorized service provider, and must be recycled or disposed of separately from household waste.
- Dispose of battery according to your local environmental laws and regulations.

## **Sleep Mode**

Simply press the power button once to switch the tablet to the Sleep Mode when the tablet is ON; press again to wake it up.

### **Tip:**

**Go to Settings > Display > Screen timeout to set the time of entering the Sleep Mode.**

## **Screenshot**

Press and hold the Volume- button and the Power On/Off button together to capture a picture.

# HOME SCREEN

## Icons on the Bottom Menu



## Sliding and touch screen

Slide up the screen to enter the main menu

Slide in from left/right to return to the previous page

Quickly slide up from the “-” position at the bottom of the screen to return to the home screen.

Slide up a bit from the “-” position at the bottom of the screen to display running applications, tap a background application to switch to it, or slide up to close it.



1. Back
2. Home Screen
3. Recent Activities

### **Set navigation Button:**

Go to the Settings application > System > Gestures > System navigation > Gesture navigation or 3-button navigation on the tablet, and select 3-button navigation.

The screen will display three buttons: 'Back', 'Home', 'Recent Activities',

Tap a button to enable it.

1. Tap Back button to return to the previous page
2. Tap Home button to return to the home screen
3. Tap Recent Activities button to display all running applications.

tap a background applications to directly switch to it or slide it up to close.

## Home Settings and Wallpapers



Tap and hold the empty section of a Home screen, Home settings and Wallpapers will be displayed.

1. Tap Home Settings to check the option of Add icon to Home screen: Allow the new Apps installed on Play Store to be displayed on the Home Screen.
2. Tap Widgets, touch and hold any application (e.g. Clock), then slide and add it to a Home Screen. Remove it by sliding it to X Remove.
3. Tap Wallpapers & style to change the current wallpaper of the tablet and its style, and more.

## SETTING BASICS

### Quick Settings

Swipe down from the top of the screen to access Quick Settings.

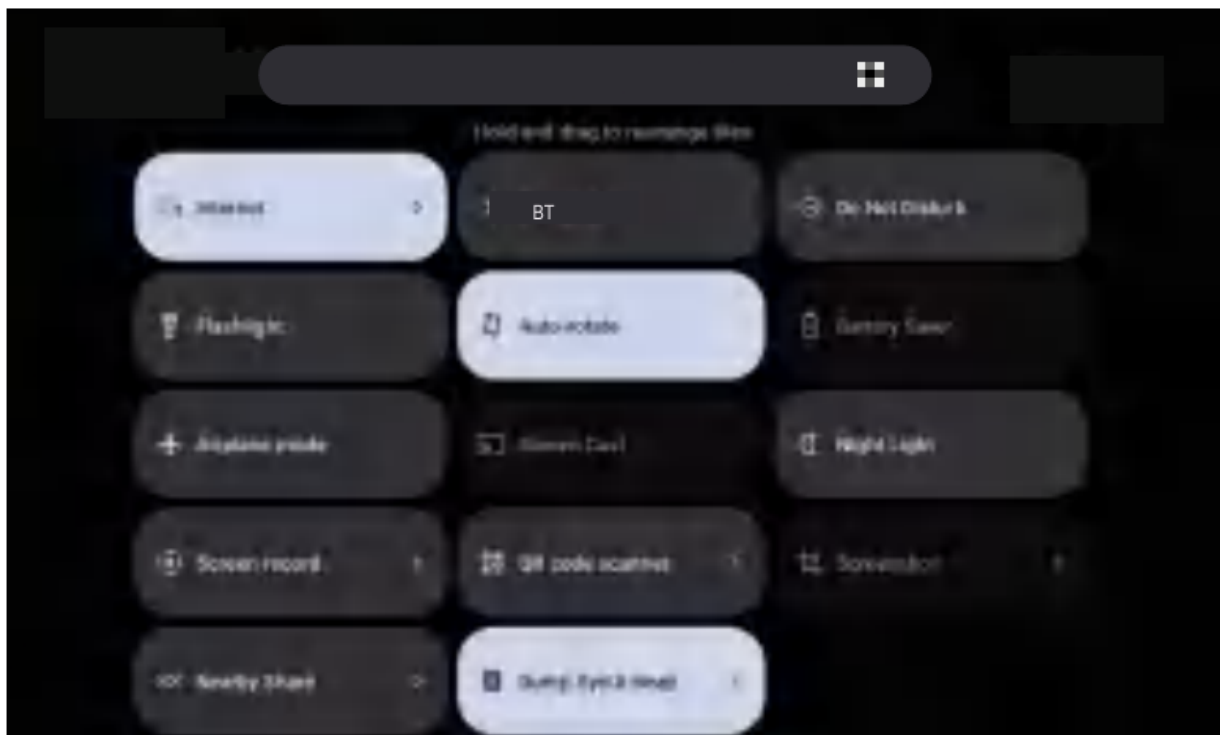



**Internet.** Tap to connect/disconnect to a wireless network



**Do not disturb.** Block sound after enabling this feature



**Flashlight.** Tap to turn the flashlight on/off



**Auto-rotate.** Turn on/off the Auto-rotate of the screen



**Power saving mode.** Tap to choose the power setting you prefer to save battery time



**Airplane mode.** Turn on/off all network connections



**Screen Cast.** Mirror the display of the tablet to compatible devices, e.g. TV box or Fire TV Stick.



**Night Light.** Enabling this reduces the amount of blue light emitted by the device display



**Screen record.** Start and end the screen recording



**Nearby share.** Enable feature, Users can share information with nearby devices quickly.



**Screenshot .** Enabling this feature to take screenshot

## More Settings

Swipe down from the top of the screen, then tap the  icon to enter the detailed setting interface. Or, tap the Settings App on the Home screen to enter.



# Settings

Search settings

Network & internet  
Wi-Fi, Ethernet

Connected devices  
Bluetooth, pairing

Apps  
Default apps, default web

Notifications  
Notifications, priority, sound, status

Battery  
11% (1:12), 23 min. estimated full

Storage  
8% used (110 GB free)

Memory Extension  
4GB+12GB

Sound & vibration  
Volume, vibration, Do Not Disturb

Display  
Lock screen, font size, brightness

Wallpaper  
Home lock screen

Accessibility  
Caption, interaction, voice

Security  
Screen lock, Find My Device, app security

Privacy  
Advertisement, location history, payment app

Location  
Wi-Fi, IP, apps, how services use location

Safety & emergency  
Emergency SOS, medical info, alerts

## **Network & internet**

- Connect to any working Wifi
- Enable/disable the Airplane Mode
- Turn on/off the Data Saver
- Add VPN Connections
- Select a private DNS mode

## **Apps**

- Check the Apps recently opened
- Check all the Apps on the tablet
- Clear the cache of the Apps
- Uninstall the third-party Apps
- Set default apps and check the unused apps
- Check the screen time for Apps and more

## **Notifications**

- Turn on/off the notification for each app
- Show or hide the notification history
- Set privacy preferences for notifications
- Set notification displaying options when the screen is locked
- Enable or disable the mode of Do Not Disturb
- Allow or disallow the apps to show dot and more

## **Battery**

- Check the time for Screen usage since full charge
- Enable/disable Battery Saver and Battery Manager
- Display or hide the remaining power as a percentage

## **Storage**

- View and manage your storage space

## **Sound**

- Set sound level for Media, Alarm and Notification
- Enable/disable Do Not Disturb to mute sound
- Show/hide the media player when the media session has ended
- Set default notification sound and alarm sound
- Enable/disable Screen locking sound, Charging sounds, and Touch sounds and more

## **Display**

- Adjust the screen brightness
- Enable/disable the Dark theme
- Turn on/off Night Light

- Change the wallpaper
- Adjust the time of entering the sleep mode
- Turn on/off the auto-rotation of the screen
- Adjust the font size and display size
- Set a screen saver
- Set what to show when the tablet is locked

## **Wallpaper**

- Choose wallpaper from your photos or the default wallpapers.

## **Accessibility**

- For vision and hearing impaired users, manage settings for Screen reader, Display, Interaction controls, Captions, Audio and General.

## **Security**

- Check the security status
- Set screen lock pattern, e.g. Password, PIN, Swipe etc.
- Choose a Smart Lock to keep the device unlocked if you preset a lock pattern
- Allow the admin apps to Find My Device and lock or erase a lost device and more

## **Privacy**

- Check and set app permissions
- Set to show/hide the password when input a password
- Set what to show when the tablet is locked and more

## **Location**

- Turn on/off the location services for specific Apps
- Set apps that have access to location
- Check and set Location services and more

## **Passwords & accounts**

- Add and remove the google accounts, manage google passwords.

## **Digital Wellbeing & parental controls**

- Check your app usage based on Screen time, Notifications received, or Times opened from Dashboard
- Manage the related notification settings to reduce interruptions
- Set up Parental controls to help your kids balance their screen time and more

## Google

- Set the preferences for Google™ related services

## System

- Set Language

**Tap Languages & input > Languages > +Add a language to add**

**your language. After adding, hold and slide the  to the top to change the language**

- Set gestures of using the tablet
- Set the date and time
- Turn on/off the option of Backup
- Check and update the tablet's system
- Manage multiple users and profiles
- Restore factory setting

**Tap Reset options > Erase all data (factory reset) to restore the factory setting**

## About tablet

\* Check the detailed information about the tablet

# NETWORK CONNECTION

## Wifi Connection

Go to network settings from the Settings App or by long pressing the Wifi icon in Quick Settings.

1. Tap Network & internet and turn on the Internet. All the WiFi connections available will be listed.
2. Select your WiFi and input the correct password.

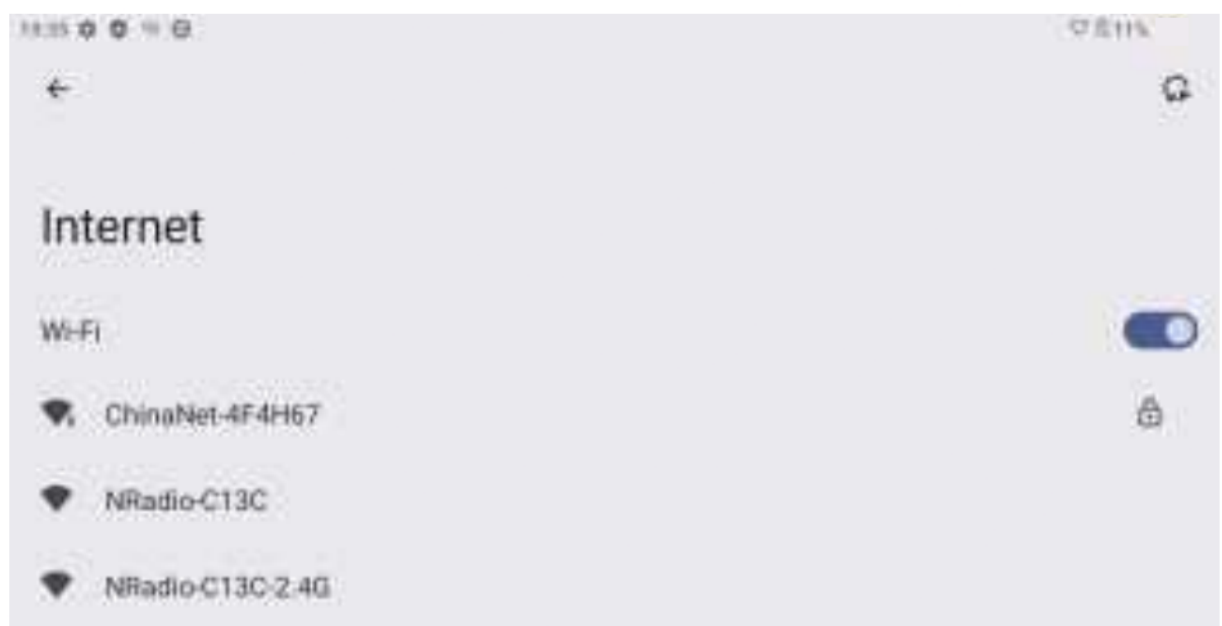
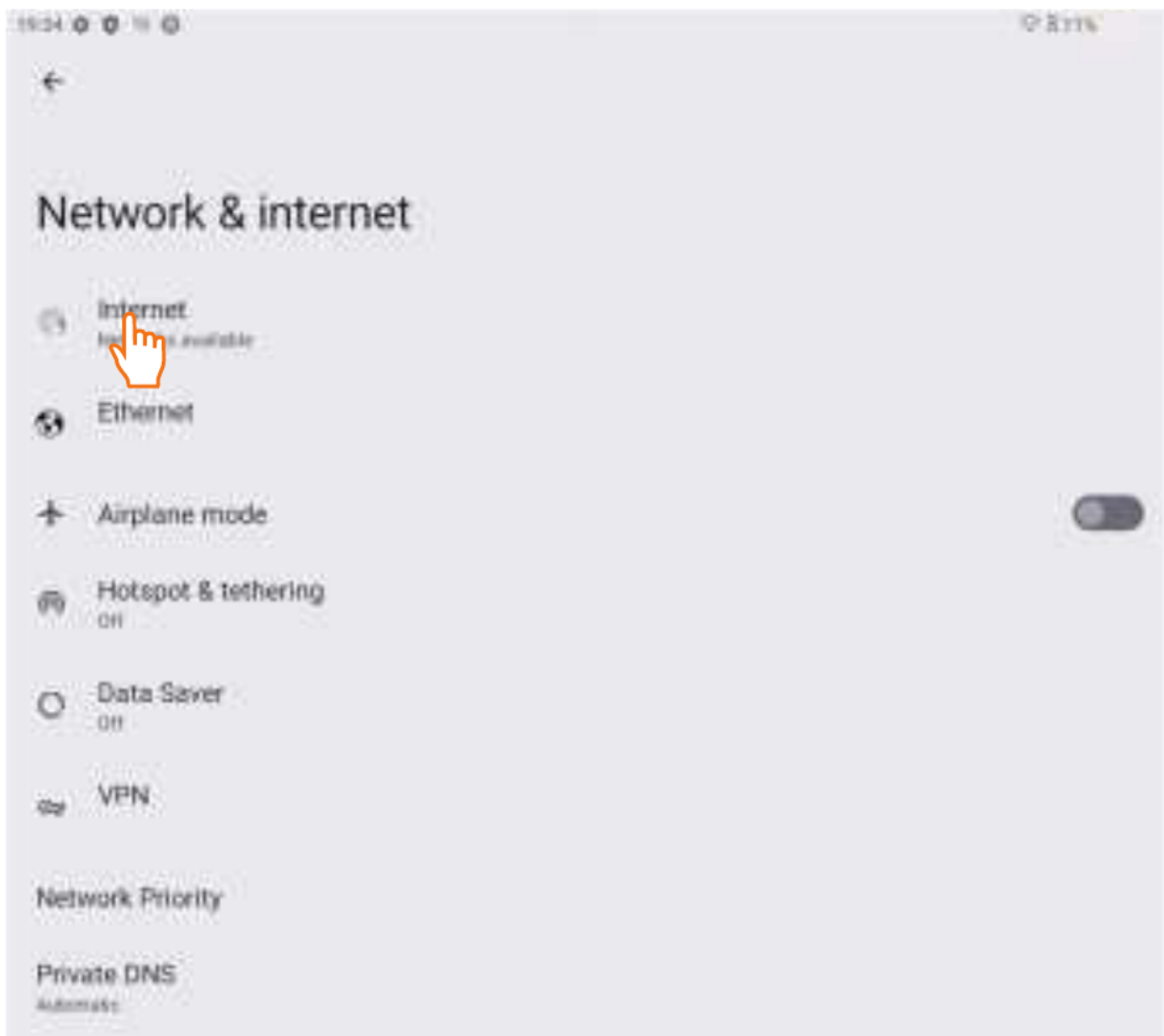

# APP MANAGEMENT

## App Download and Installation

1. Tap and open Play Store on the Home screen.
2. Log into your google account, search and download the App you need.

## App Management

### Move the App

Tap and hold the App, then slide it to a desired screen.

### Remove the App from the Home screen

Touch and hold the App, then slide to

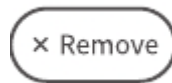

to remove it from your Home screen.

### Uninstall the App

Touch and hold the App, then slide to the



to uninstall the App.

### Clear the Cache of the App

1. Go to **Settings > Apps**.
2. Select an **App > Storage & cache > CLEAR CACHE** to clear the cache.

# INTERNET NAVIGATION

Please make sure the tablet is connected to a working WiFi network before navigating the Internet

You may use the pre-installed Chrome browser or use another browser downloaded from Play Store.

# MULTIMEDIA

## Connecting to a Computer

1. Connect your tablet to the computer with a USB cable.
2. File Transfer is the default setting. Go to your computer and find your tablet to transfe files between your tablet and computer.

## Tips:

Go to Quick Settings, tap USB file transfer turned on > Tap for more options > USB Preferences to select the option preferred.

- Select MIDI to play MIDI instruments on the tablet.
- Select PTP to transfer photos between the devices.
- Select No data transfer to charge your tablet.

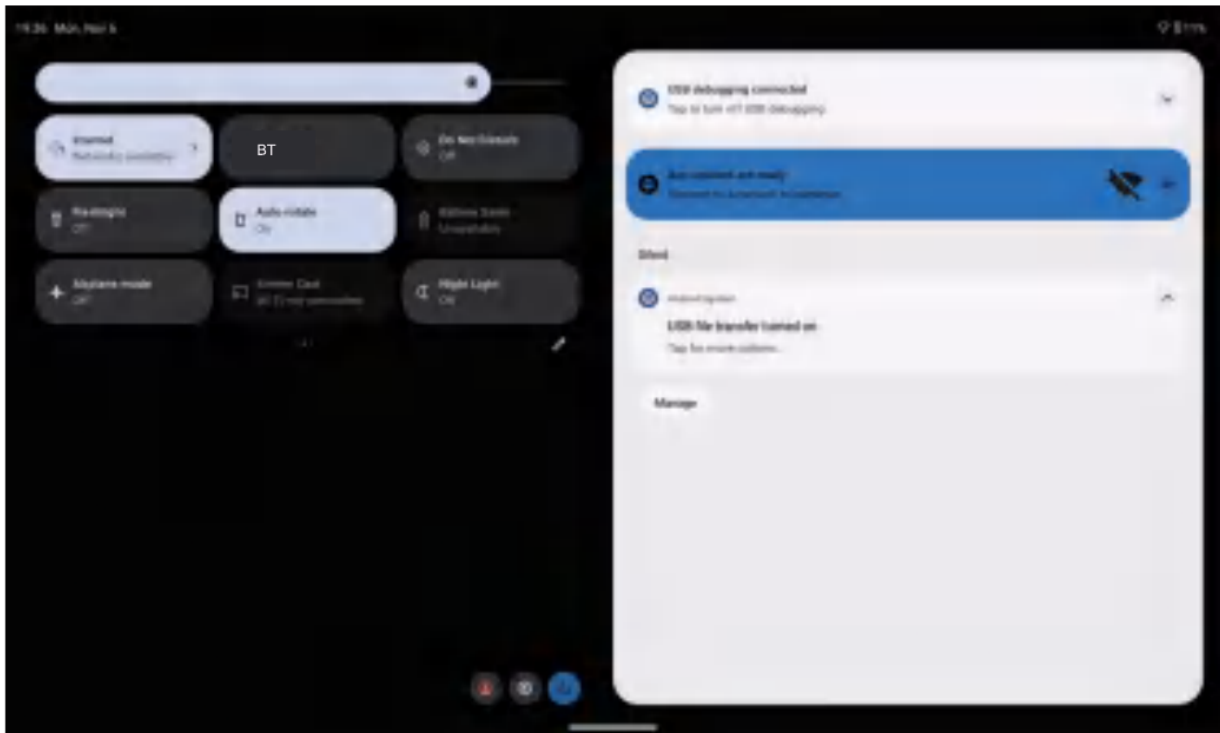

## Connecting to an External Device

1. Install a memory card into the memory card tray using the pin in the box when the tablet is off.

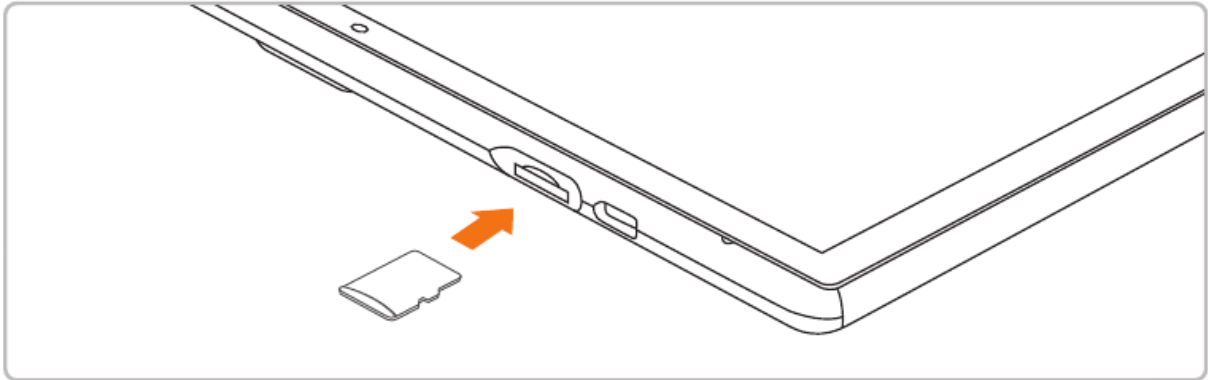

2. Turn on the tablet, then go to Quick Settings and tap SET UP.
3. Set the memory card as a portable storage by selecting Portable storage. Enter memory card storage to move files between the card and tablet.

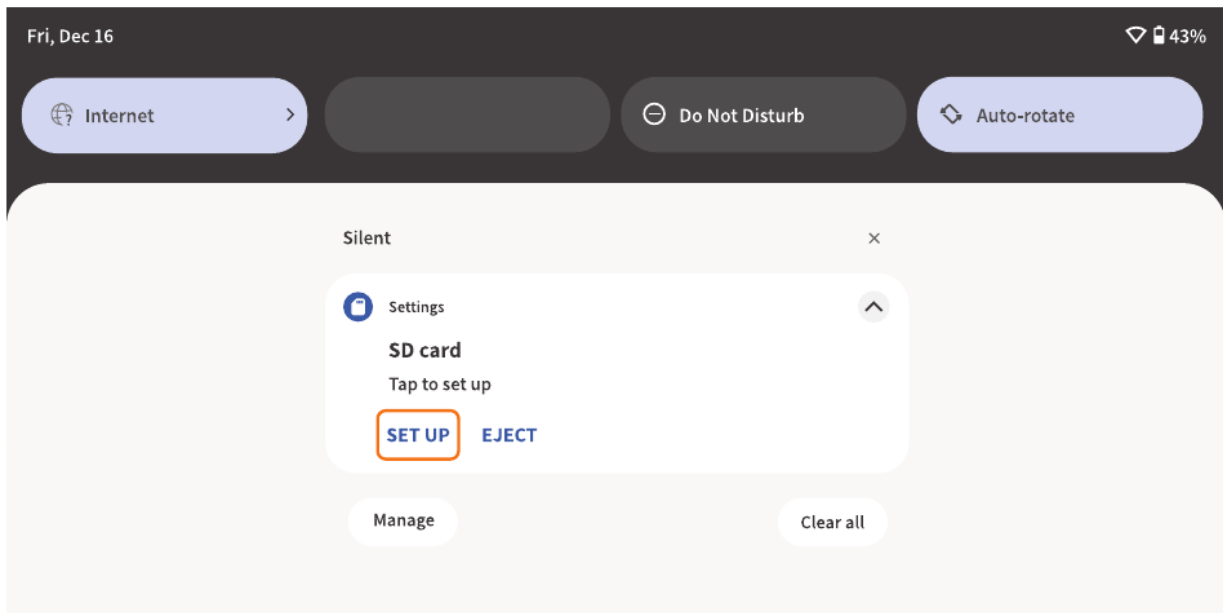



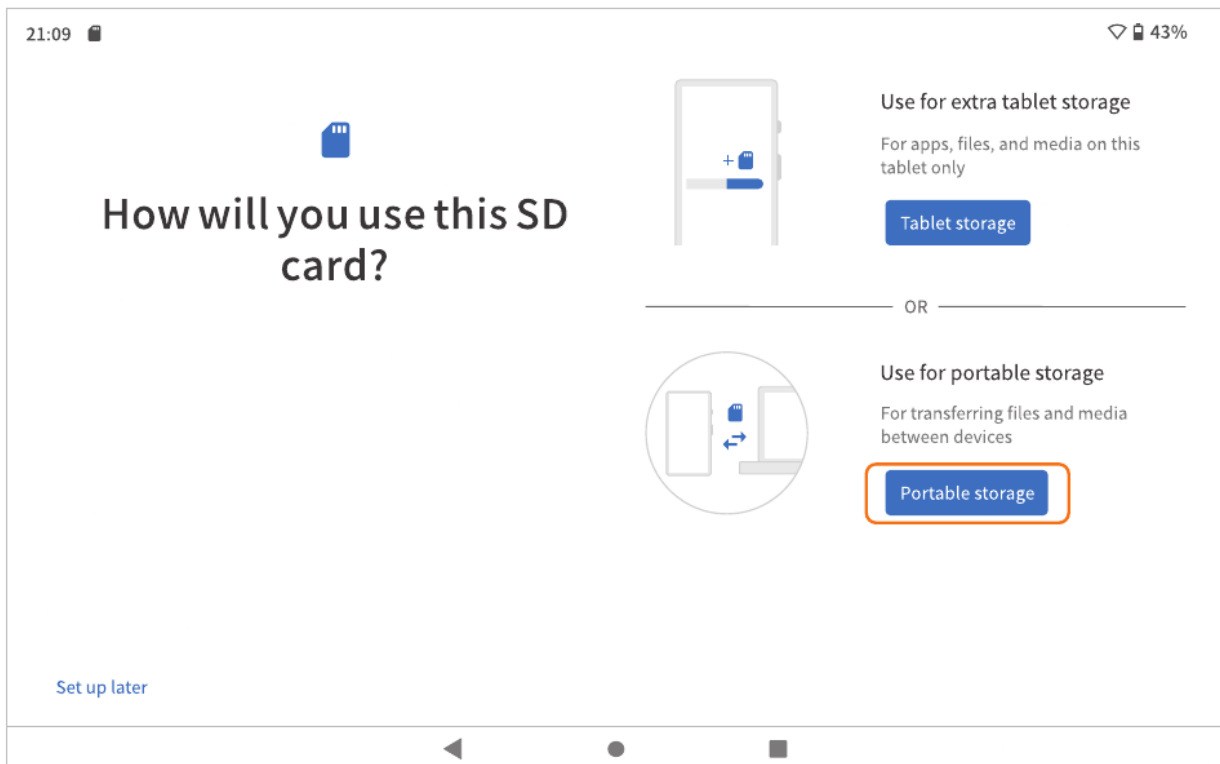

## TROUBLESHOOTING

### Q1. The tablet doesn't power on.

- Reboot your tablet after charging for more than 30 minutes.
- Press the power button to check if the tablet is in the Sleep Mode.
- Insert a pin to the Reset Hole to reboot it.

### Q2. The tablet doesn't charge.

- Make sure the USB cable is properly plugged into the charging port.
- Try another compatible USB cable and adapter.

### Q3. Error message occurs during the operation.

- Uninstall the App with the error message, then download and install again.
- Insert the pin into the Reset Hole to reboot it.

### Q4. The tablet cannot be detected by the computer.

- Make sure the tablet is powered on.
- Try another USB cable.
- Try another USB port on the computer.
- Instead of No data transfer, choose File Transfer or PTP when connecting the tablet to the computer.

### Q5. The tablet cannot connect to the WiFi.

- Make sure the WiFi in your tablet is ON.

- Make sure you input the correct password when connecting the WiFi.
- Restart the router.
- Make sure there is no filter setting or device connection limitation in the setting of the router.
- Forget the current Wifi, reset the router and connect the Wifi again.

**Q6. The storage space of the tablet is not enough.**

- Delete the Apps you don't use.
- Clear the cache of the Apps regularly.
- Install a memory card to expand the storage.

**Q7. The tablet comes with scratches on the screen.**

- Check if the scratches are on the film. If yes, please remove the film.

**Q8. The screen is unresponsive.**

- Check if the screen is dusty or greasy. If yes, please gently wipe the screen with a cloth to clean it.

**Q9. The font size is too small to read.**

- Please go to Settings > Display > Advanced > Font Size to adjust the text size.

**Q10. How to use your voice to search a fact?**

- Tap the microphone icon on Google Search bar, tell the tablet what you want to know and it will show you the search results.

Peicheng Technology P12 Tablet PC User Manual