

# [Remote Control Page Turner User Manual](#)

## [Manualsum](#), simplified manuals

### Table of Contents

- [Remote Control Page Turner User Manual](#)
  - [Product Description](#)
  - [Technical Specifications](#)
  - [Package Included](#)
  - [Product Diagram](#)
  - [How to Use \(RF 2.4Ghz\)](#)
  - [How to Use \(Bluetooth\)](#)
  - [FAQs](#)

# Remote Control Page Turner User Manual

Remote Control Page Turner User Manual

FCC id: [2BKIY-DT-PT06](#)

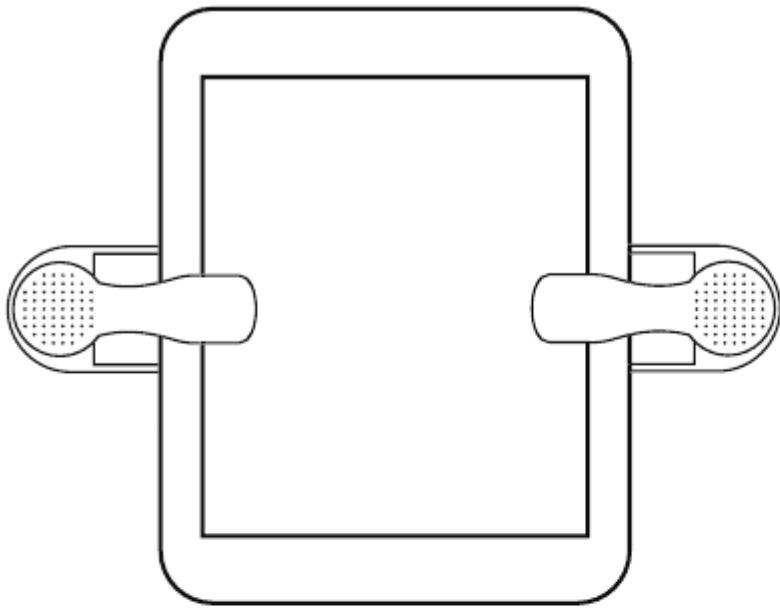

## Product Description

Thank you for choosing this Page Turner.

You will have a brand new reading experience!

With this RF Remote Control Page Turner, you can effortlessly turn Kindle pages forward with just a gentle click of the remote button, eliminating the need for constant manual page flipping.

Achieve comfortable reading by remotely flipping pages from the cozy warmth of your bed during cold winter days.

Once you've tried it, you'll surely fall in love with it.

[Manualsum](#)

It's compatible with all capacitive touch screens like Kindle, Kobo, mobile phones, tablets, and more.

## **Technical Specifications**

- Bluetooth module frequency: Bluetooth 2.4GHz
- Bluetooth TX power: Bluetooth 4dBm
- Support Bluetooth version: Bluetooth 2.1+EDR/3.0/4.X/5

# Package Included

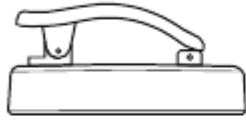

Screen Sensor Clip\*2



Remote Control\*1

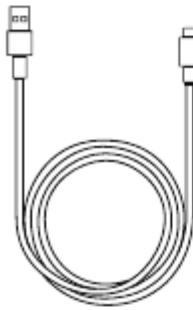

Type-C Charging Cable\*1

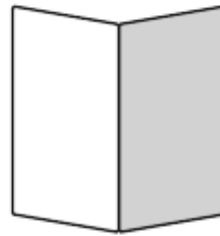

User Manual \*1

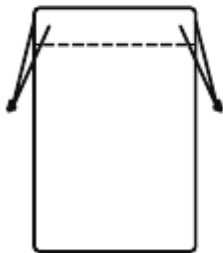

Storage Bag\*1



Wrist Strap\*1

# Product Diagram

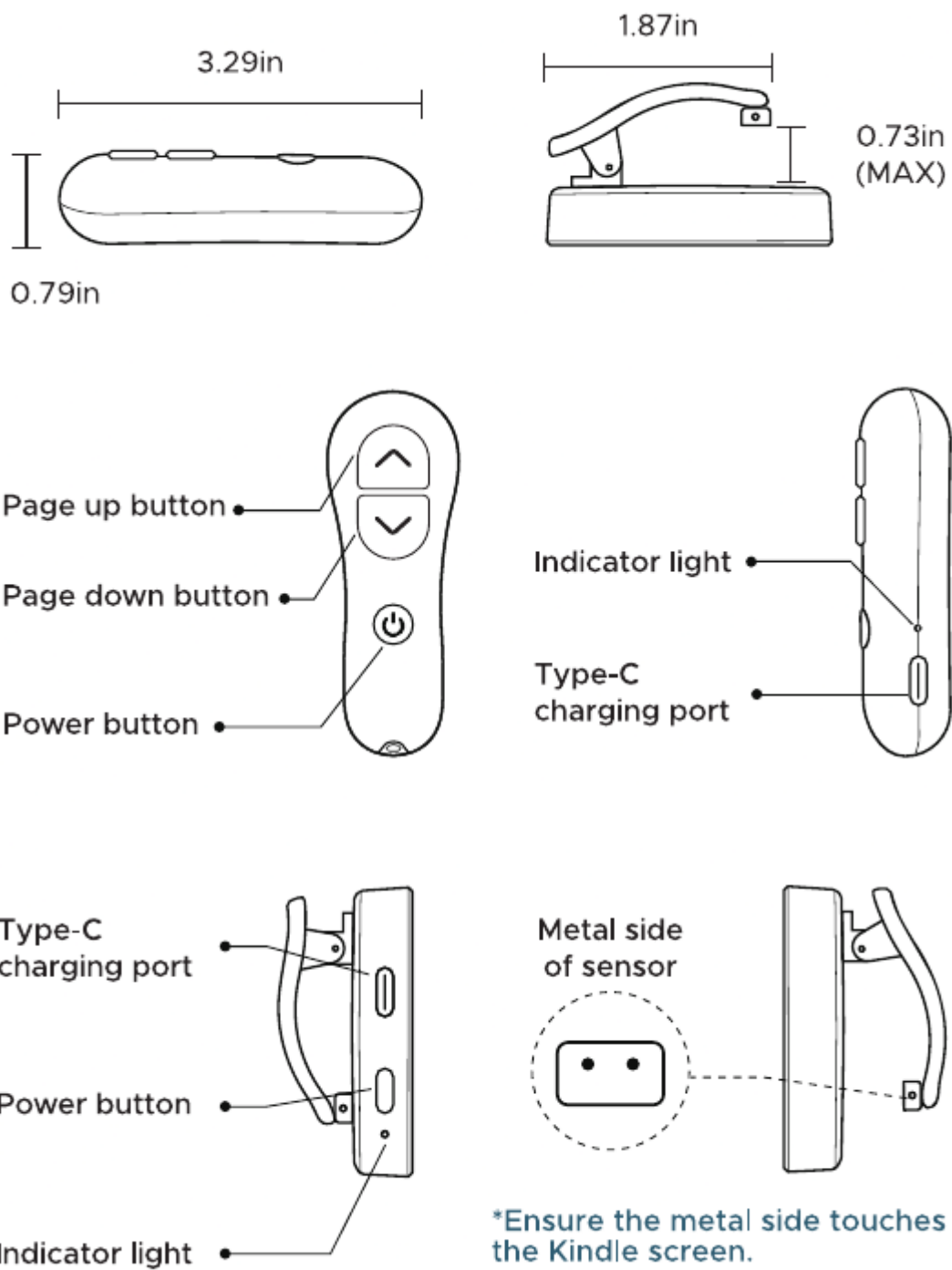

## How to Use (RF 2.4Ghz)

- **Step 1:**

Press and hold the power button on the remote control. The green light will stay on and then turn off, indicating the remote control is on.

- **Step 2:**

Press the power button of the clip, the indicator light will flash green slowly to indicate the clip is on; then press the button long again until the green light flashes rapidly.

- **Step 3:**

Press and hold the page flip button on the remote control, and the indicator light will stop flashing, indicating successful pairing.

- **Step 4:**

Clip the screen sensor clip on the Kindle in a suitable position. Press the page flip button on the remote control to turn the page normally.

\*Please repeat the above steps for re-pairing before each use.

## **How to Use (Bluetooth)**

- **Step 1:**

Long press the power button of the remote control to turn on it, and press the page flip button to light up the blue light, indicating that it is in the Bluetooth mode.

- **Step 2:**

Click the power button three times to make the remote control enter the pairing state, at this time the red and blue lights are flashing alternately.

- **Step 3:**

Open the Bluetooth page of your smartphone, find the name of the paired remote control and pair it (Remote Control Page Turner).

- **Step 4:**

After successful pairing, the blue light will be on for 5 seconds and then turn off

\*Please repeat the above steps for re-pairing before each use.

## **FAQs**

### **1.What should I do if it doesn't work?**

- **a.** Ensure the metal tip of the screen sensor clip is clean and in contact with the Kindle screen.
- **b.** Ensure the RF remote control and the screen sensor clip are powered on
- **c.** Confirm successful pairing. If the pairing is successful, press the page flip button on the remote control, and the receiver indicator will light up normally.

- **d.** Repair. Place the screen sensor clip in the appropriate position on the Kindle and repair it.
- **e.** Some older models of Kindle may not be compatible with the page turner. Please contact us.

## **2. What should I do if the screen sensor clip blocks the words?**

- **a.** Adjust the position of the screen sensor clip.
- **b.** Adjust the margins of the Kindle screen.

## **3. What does the indicator light in different states mean?**

- Low battery: The red light flashes slowly three times.
- Charging: The red light stays on continuously.
- Fully charged: The green light is on, and it goes off after unplugging

## **4. How long does it take to get a full charge?**

It'll take around 1.5 hours to top off the screen sensor clip, and about 3 hours for the remote control.

## **5. How long the page turner can be used when it is fully charged?**

With a daily usage of 2 hours, the remote control can be used for about 150 days and the screen sensor clip can be used for about 15 days.

## **6. How long does it take for the page turner to turn off automatically?**

If the page turner has not been used for 15 minutes, it will turn off automatically.

**\*Note:** No manual shutdown button.