

Utec Smart Switch User Manual

Manualsum, simplified manuals

Table of Contents

- [Utec Smart Switch User Manual](#)
 - [About Privacy](#)
 - [What's in the Box](#)
 - [Need Help?](#)
 - [Attention](#)
 - [Product Outline](#)
 - [Technical Specifications](#)
 - [Tools you'll need](#)
 - [Installation for Single Pole](#)
 - [Before Installation: Turn Off Power](#)
 - [STEP1](#)
 - [STEP2](#)
 - [STEP3](#)
 - [STEP4](#)
 - [STEP5](#)
 - [STEP6](#)
 - [STEP7](#)
 - [STEP8](#)
 - [STEP9](#)
 - [STEP10](#)
 - [Easy Setup](#)
 - [Get U home App Ready](#)
 - [Scan QR Code](#)
 - [Download App](#)
 - [Create Account and Login](#)
 - [Add New Device](#)
 - [Integrations](#)

Utec Smart Switch User Manual

Utec Smart Switch User Manual

([2AJZ2-US03](#))
[Manualsum](#)

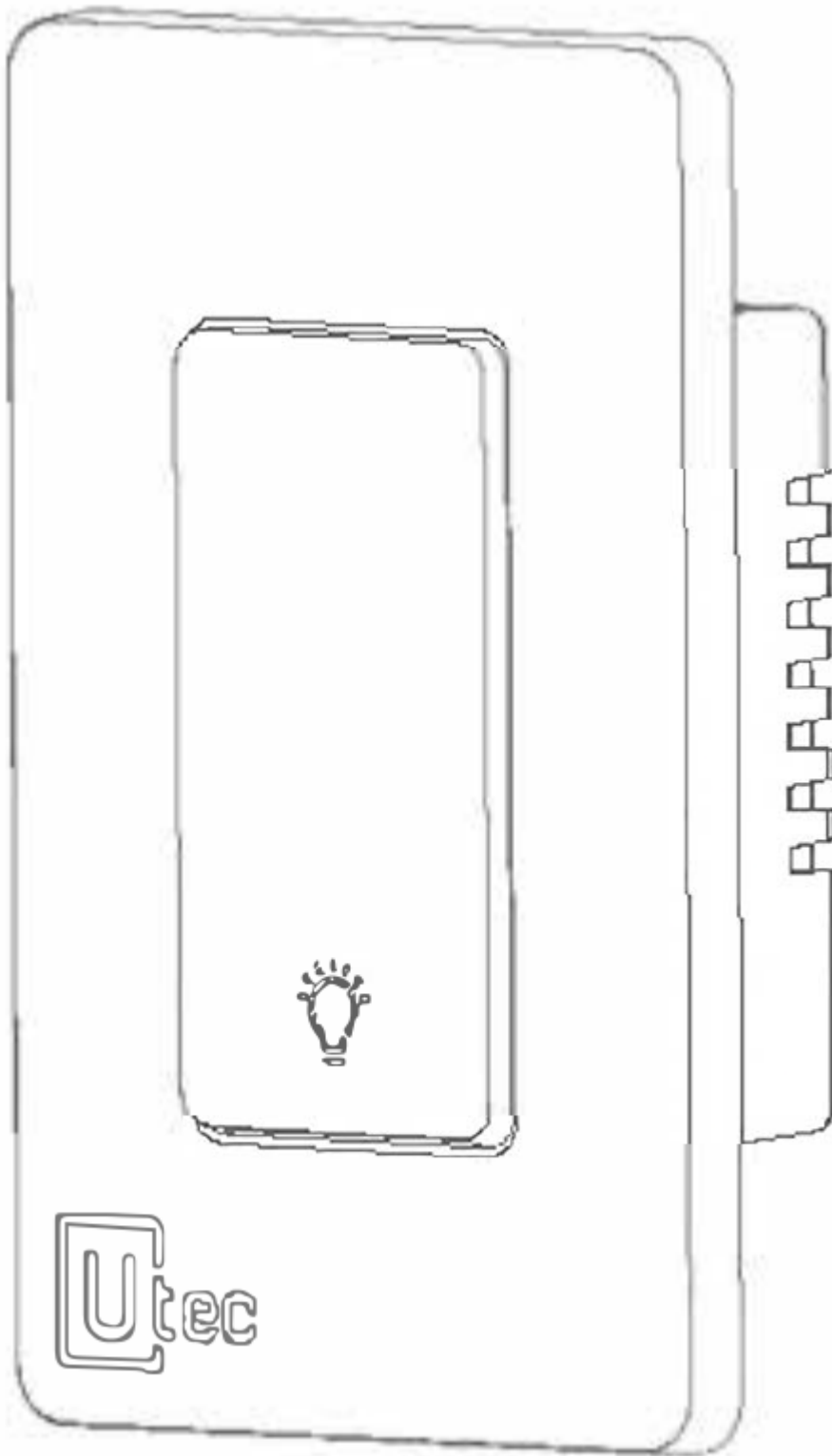

Neutral wire Required



About Privacy

By using your device, you agree to be bound by the U-tec Privacy Policy. Please read all applicable terms, rules, policies and usage provisions found at www.u-tec.com/pages/privacy.

What's in the Box

Cover Panel

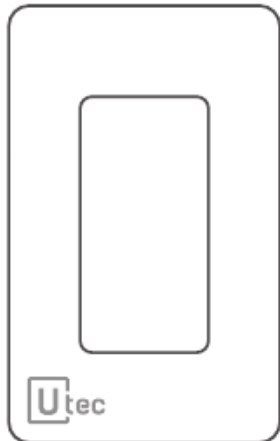

Smart Switch

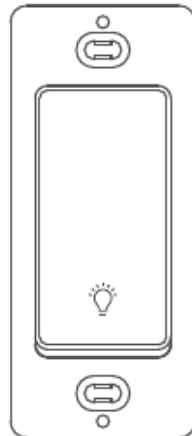

Nuts Screws



Cable Label

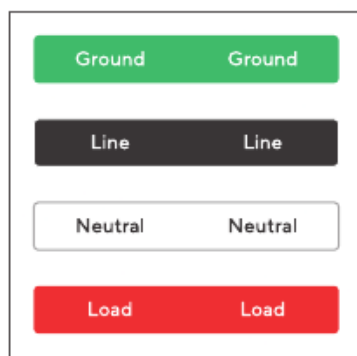

User Guide

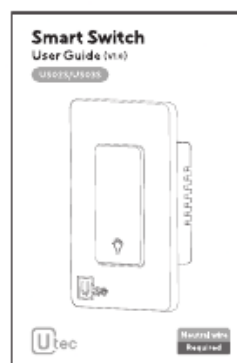

FAQ for Matter (optional)



Need Help?

For technical documents and more details

Please visit support.u-tec.com

Or call 1-844-439-8832

Attention

To avoid fire, shock, or death, turn off power at circuit breaker or fuse, and test that the power is off before wiring.

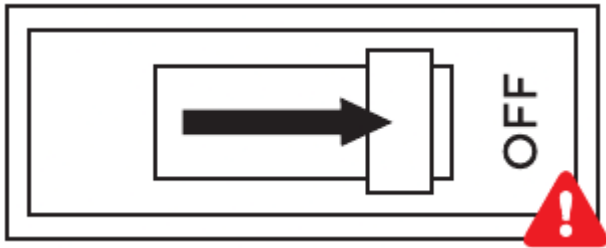

- Neutral Wire is required. (Please kindly check your house wires if your house was built prior to the mid-80's.)
- Make sure wall boxes with 18 cu in. vol. or above.
- Need 2.4GHz Wi-Fi (Does not support 5GHz Wi-Fi).
- Recommended loads: 1000W Max.for INC, and 600W Max for CFL&LED.



LED

600W



CFL

600W



Incandescent

1000W

Electricity can cause personal injury and property damage if handled improperly. If you are not sure about any part of these instructions, please seek professional assistance from a qualified electrician.

Product Outline

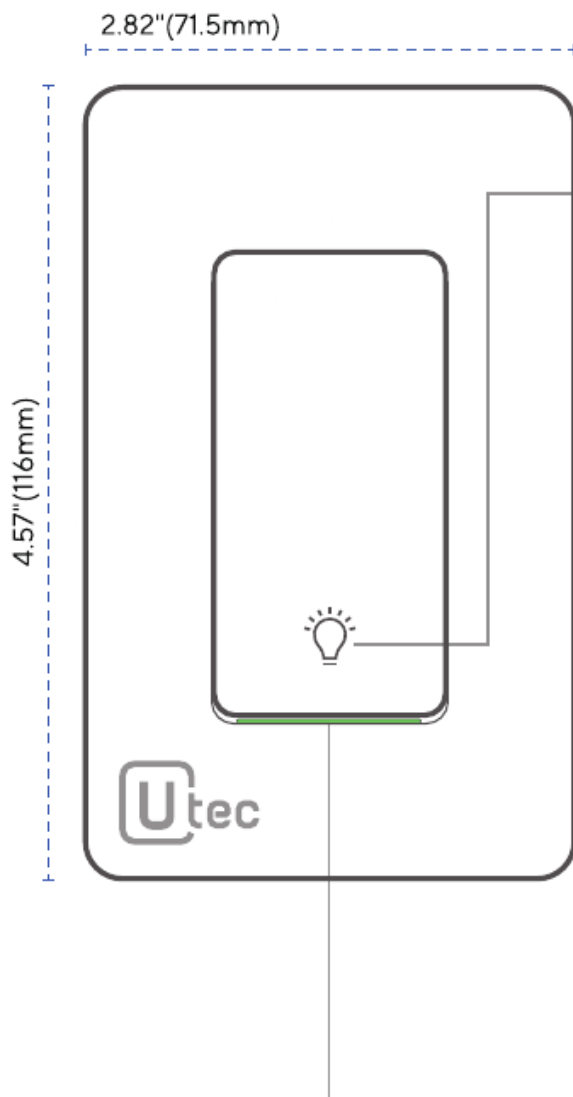

ON/OFF Button

Press to turn the switch on or off.

Reset/Configuration Mode

Press and hold for 5s to reset to initiate configuration mode.

Status Indicator

Solid Green

Indicate that the light is switched on.

Solid White (Optional)

Indicate that the light is switched off.

Flash Green (Slow)

Configuration mode initiated.

Flash Green (Fast)

Connecting to WiFi.

Technical Specifications

Input:

100-130V~, 60Hz

Max Load:

1000W Incandescent

600W LED&CFL

Dimensions (WxDxH)

42x18x14 inch (without cover panel)

4.6x28x18inch (with faceplate)

Operating Temp.

14°F -122°F/-10°C - 50°

Communication: WiFi 802.11b/g/n 2.4 GHz Bluetooth 5.0

Weather resistant: Indoor Use Only

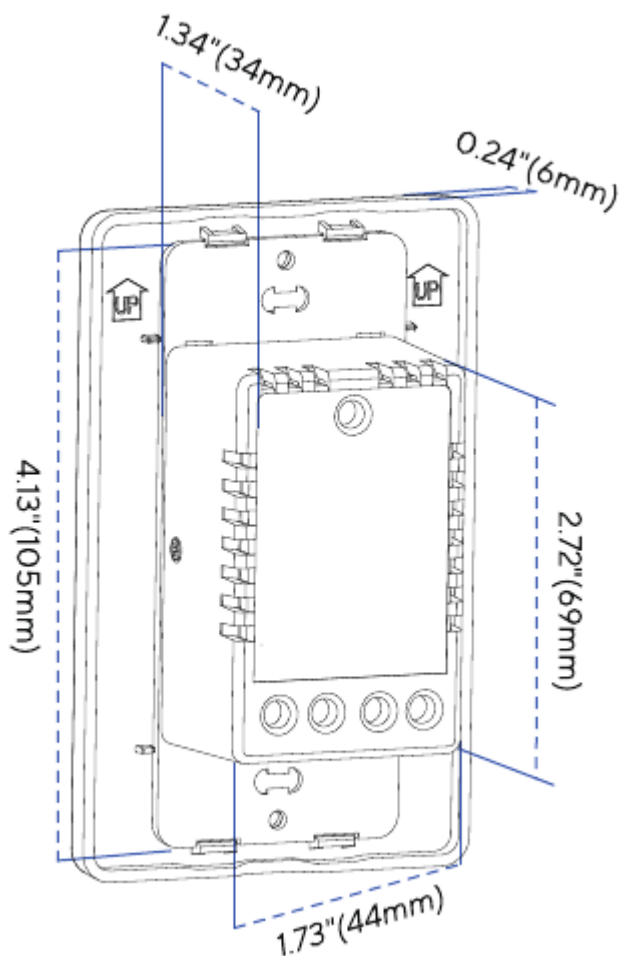

Tools you'll need



Phillips-head screwdriver



Flat-head screwdriver

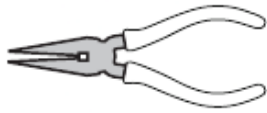

Pliers



Voltage tester

WARNING: Please refer to the voltage tester guide manual, or seek professional assistance from a qualified electrician.

Installation for Single Pole

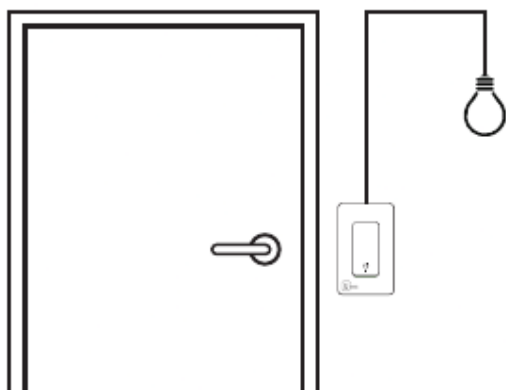

US02S



US03S

Please scan this QR code to watch the step by step installation video before attempting to install U-tec Switch, or you can access our website here.

US02s:

<https://support.u-tec.com/hc/en-us/categories/32322500848537>

US03s:

<https://support.u-tec.com/hc/en-us/categories/32322479978137>

Before Installation: Turn Off Power

Turn off the power at the circuit breaker or fuse, and test that the power is off before installation.

[Manualsum](#)

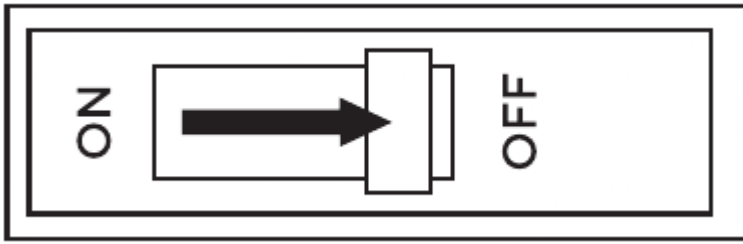

CAUTION: Compatible bulb type/max Load: Incandescent/1000W, LED&CFL/600W. Please check your bulb/load before installation.

STEP1

Pull Out Old Switch

WARNING: Before pulling out, turn off power at circuit breaker or fuse, and use a voltage tester to confirm whether power is off before wiring.

Unscrew the switch plate, old switch and pull it out of the wall. **Do not remove any wires.**

STEP2

Get to know the wires

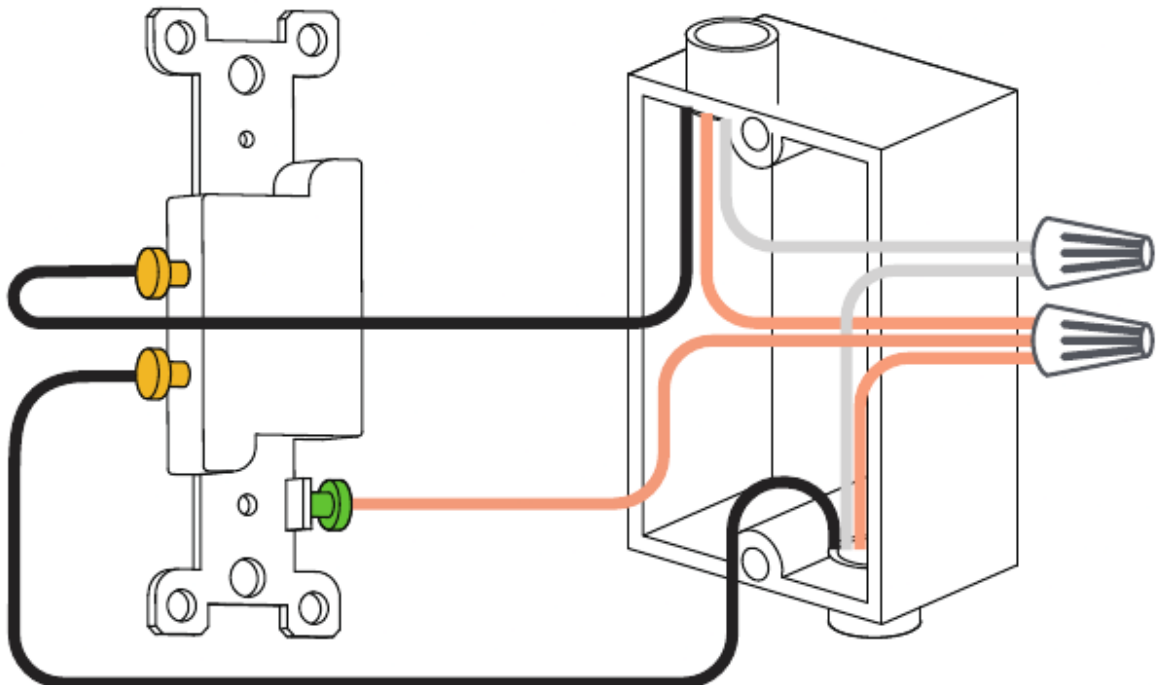

WARNING: Neutral wire is required to install the smart switch. If you can't find the neutral wire, please call an electrician for help.

Line: Usually black.

Load: Usually black, connected to the light.

Neutral: Usually white.

Ground: Usually green or copper.

STEP3

Identify and Label “Line” wire

1. Disconnect the line and load wires from the dumb switch, then cover them with provided wire nuts for the sake of security.
2. Turn on the circuit breaker and use a voltage tester to identify the energized wire (line wire).
3. Turn off the circuit breaker and label the Line wire.

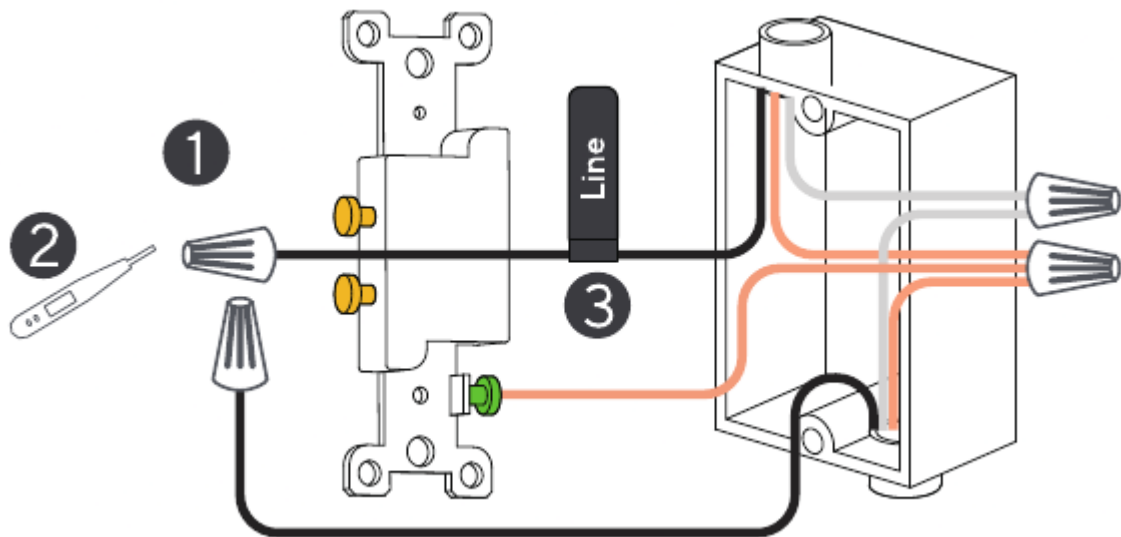

STEP4

Label the Other Wires

Label the other wire as load wire. Label the ground and neutral wires.

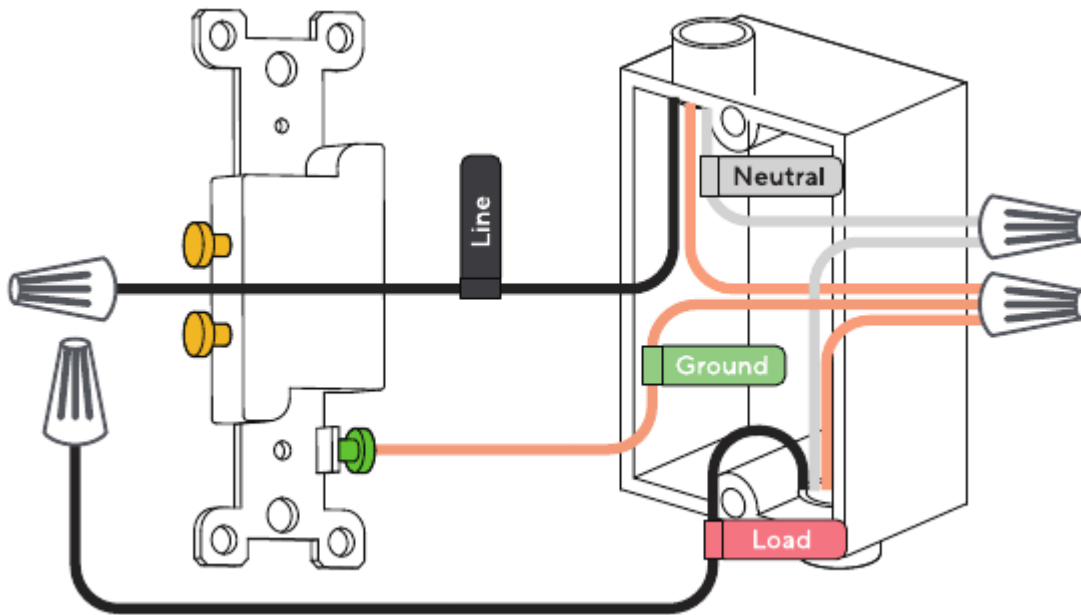

STEP5

Take Pictures of the Wires

Take one or two pictures of the old switch and where each wire is connected to it, in case you need guidance to reverse the installation.

NOTE: Make sure all of the text on the labels in the pictures are clearly displayed.

STEP6

Remove existing Dumb Switch

WARNING: Before removing, turn off power at circuit breaker or fuse and use a voltage tester to confirm the power is off.

Disconnect all wires and remove the dumb switch, then connect them to the smart switch.

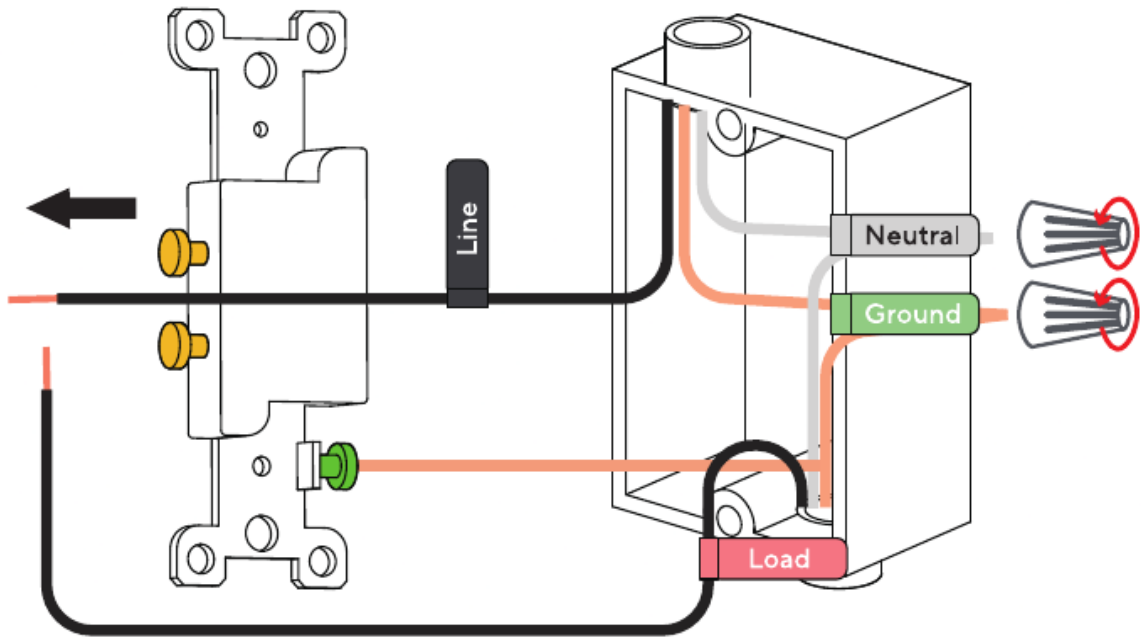

STEP 7

Connect the Smart Switch

Connect the wires to the smart switch.

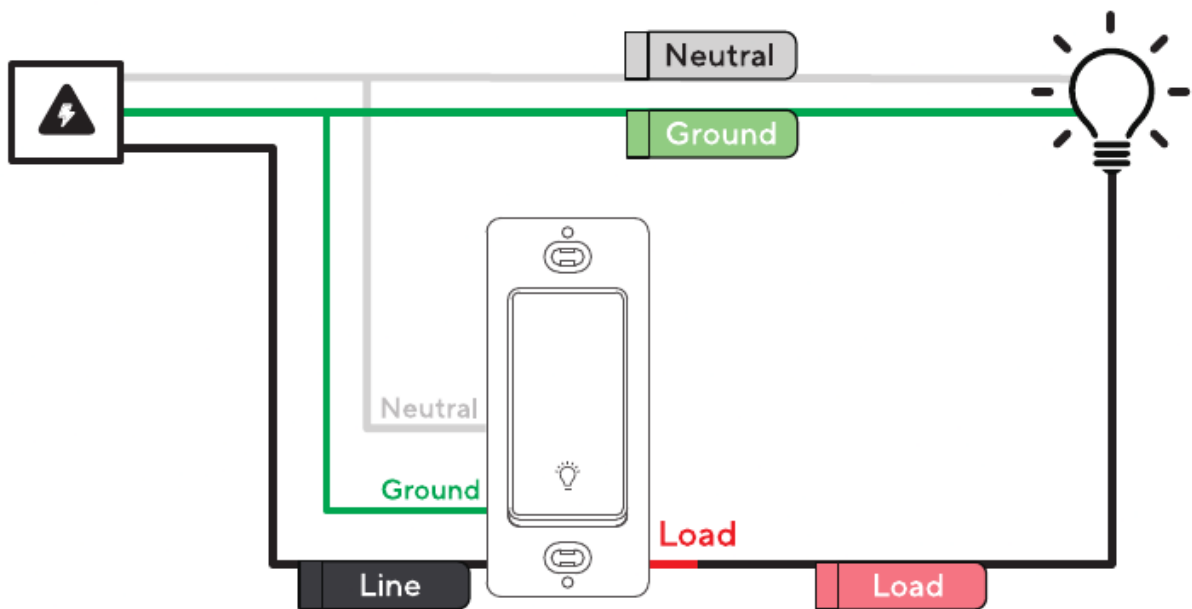

WARNING: Make sure the power is turned OFF before you proceed. Your existing wires may have different colors than those shown.

- Connect Neutral and Ground Wires

Note: Neutral: usually white. Ground: usually green or copper.

Use wire nuts to connect Neutral/Ground from the outlet box to the respective NEUTRAL /GROUND from the smart switch, as show in the picture.

- Connect Line Wire

Use a wire nut to connect the labeled Line wire from the outlet box to the LINE wire coming from the smart switch.

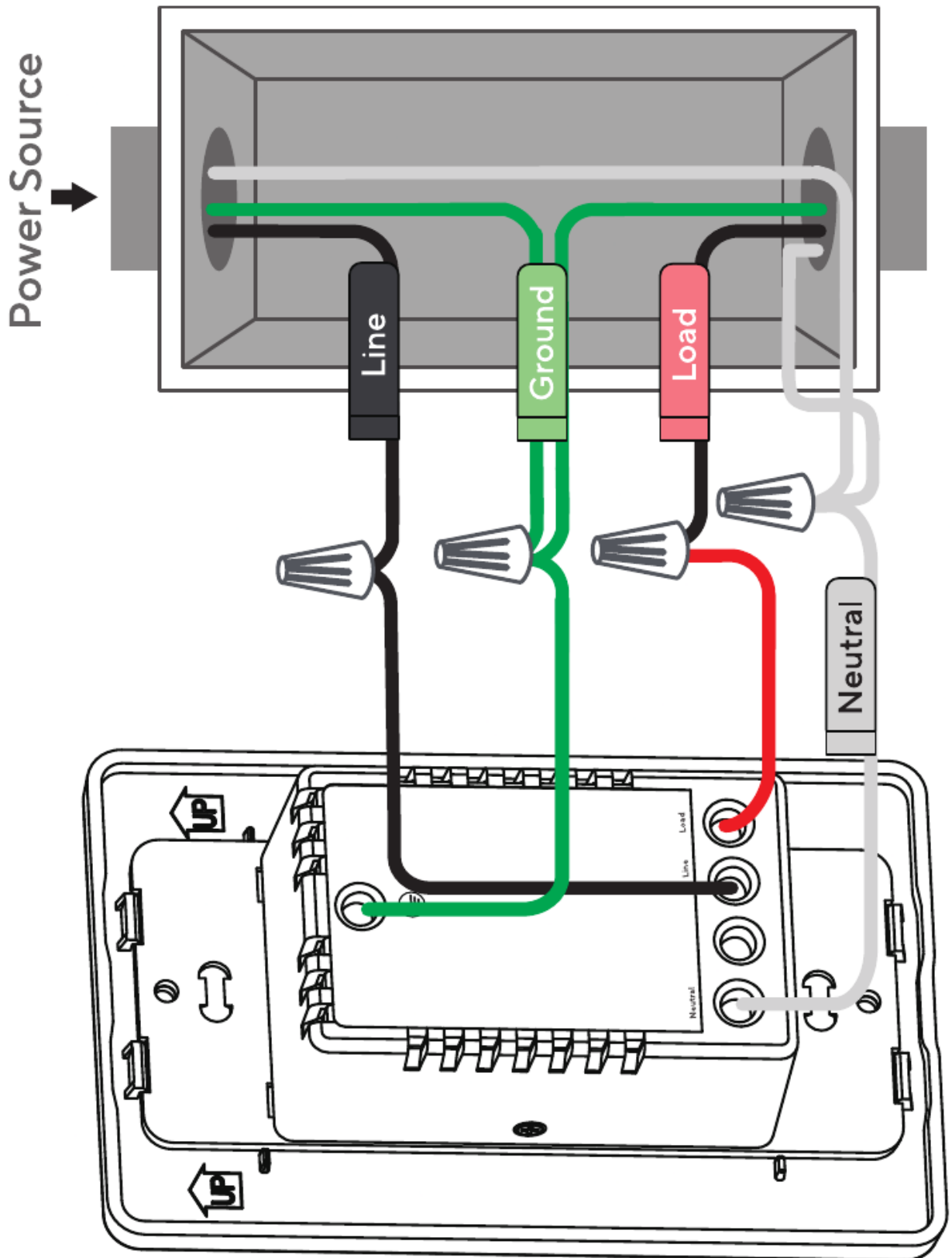

- Connect Load Wire

Use a wire nut to connect the labeled Load wire from the outlet box to the LOAD wire coming from the smart switch.

WARNING: All wires from the Smart Switch must be capped with wire nuts.

WARNING: Death or serious injury may occur if instructions are not properly followed.

STEP8

Mount the Switch

Form all wires carefully into outlet box, and mount switch with screws supplied.

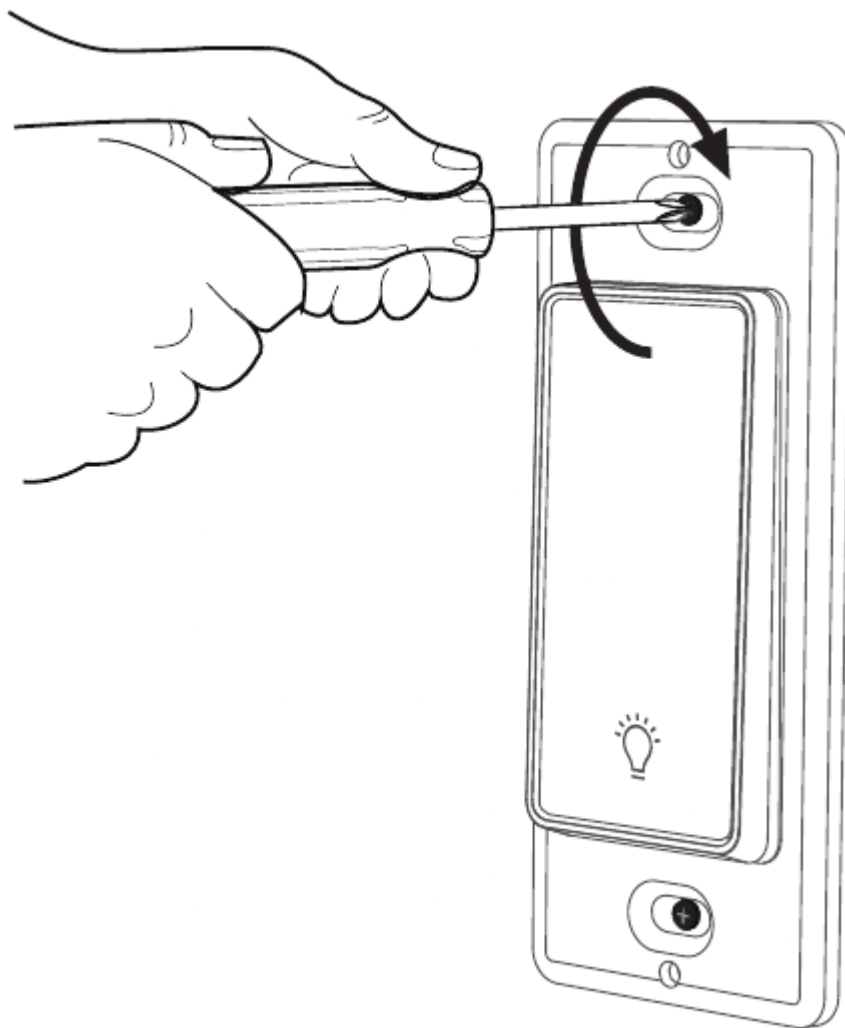

STEP9

Turn on Power

Turn the power on at the circuit breaker.

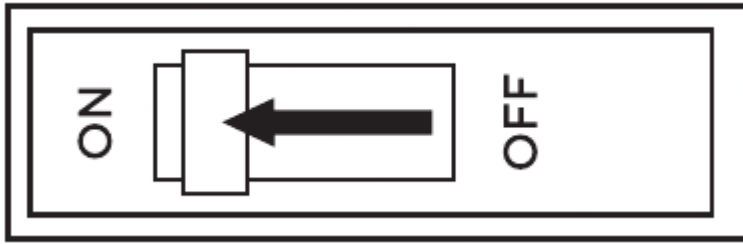

- Press the ON/OFF button on the smart switch to confirm whether the switch is powered on/off normally.

STEP10

Snap on Cover Panel

Push cover panel onto the fixing plate and snap it into place.

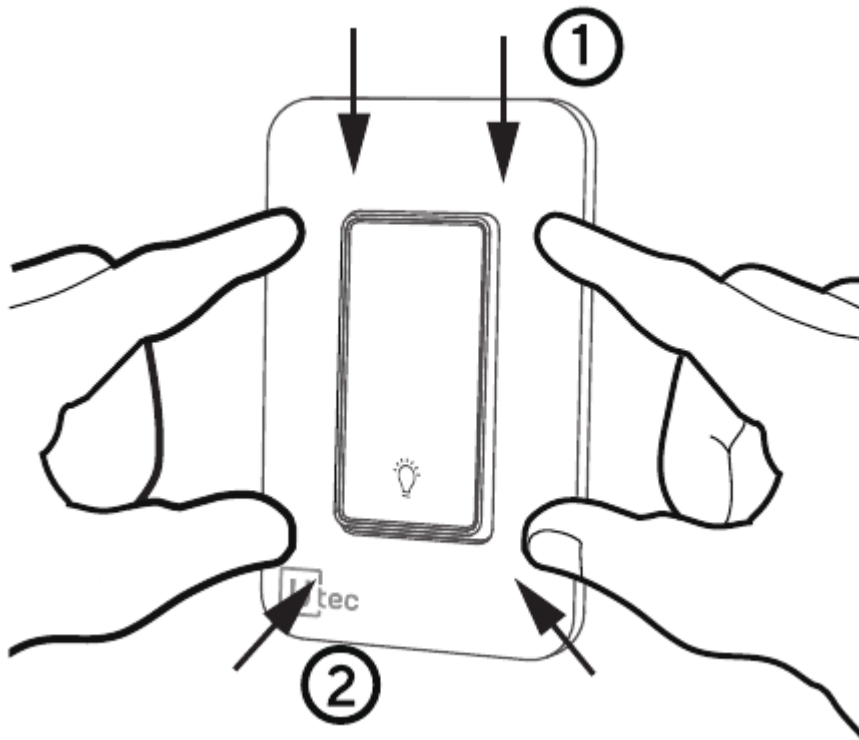

NOTICE: Please turn on the smart switch first, adjust the light to the maximum brightness, press and hold ON/OFF for 5s to initiate configuration mode.

Easy Setup



Scan QR code to download the
U home app

Get U home App Ready

Scan QR Code

Scan above QR code to download the app, or search “U home by U-tec” in App Store (iOS) or “U home” in Play Store (Android).

Download App



Create Account and Login

Add New Device

Tap the “+” button on the app’s homepage to add new device, then follow the app instructions to finish the setup.



Integrations

Smart Switch also works with Amazon Alexa, Google Assistant, SmartThings, and IFTTT when the it is set up in the U home app.